

HENRY

HN2P13

Henry Two Way Diverter Valve Trim for Pressure Balance
with Roman Numerals and Coin Edge Lever Handle

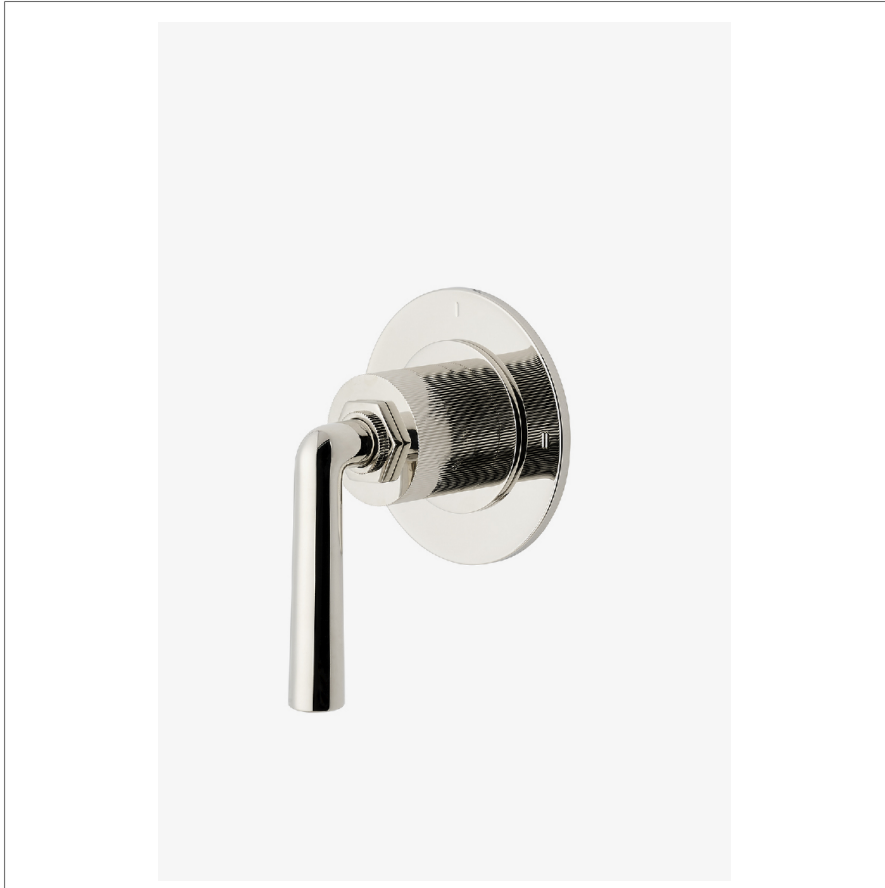

SHOWN IN HENRY TWO WAY DIVERTER VALVE TRIM FOR PRESSURE BALANCE WITH ROMAN NUMERALS AND COIN EDGE LEVER HANDLE | HN2P13

TECHNICAL DETAILS

ADA Compliance: Yes
Fittings Hole Diameter: 2"
Handle Turn Angle: Quarter Turn
Number Of Holes: One Hole
Primary Material: Brass

INSPIRATION

Celebrating the connection of industry and art, Henry transitions effortlessly between modern, traditional, and classic settings. These iconic fittings blend 19th-century industrial and artistic references for a look that's forever of the moment—familiar yet wholly original.

CODES & STANDARDS

ASME A112.18.1/CSA B125.1, State of MA

PRODUCT FEATURES

- Coin Edge Lever Handle
- For Use With a Pressure Balance Shower System and Two Waterway Outlets
- Features Roman Numerals Representing Outlet Position
- Stocked in Brass, Chrome, Nickel and Dark Nickel
- Requires valve rough sold separately

CERTIFICATIONS



PRODUCT (NOTES)

HENRY

HN2P13

Henry Two Way Diverter Valve Trim for Pressure Balance
with Roman Numerals and Coin Edge Lever Handle

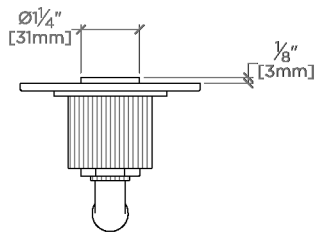

TOP VIEW

SCALE: 3"=1'-0"

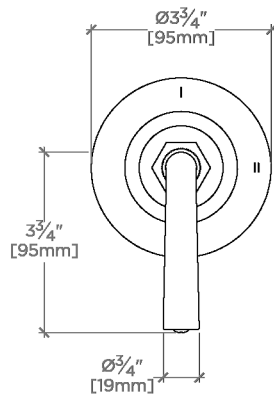

FRONT VIEW

SCALE: 3"=1'-0"

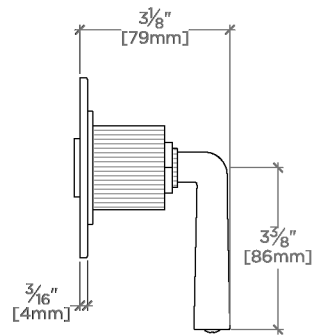

SIDE VIEW

SCALE: 3"=1'-0"