

INSTALLATION GUIDELINES

GOOSENECK KITCHEN FAUCET

REGULATOR GOOSENECK SINGLE SPOUT KITCHEN FAUCET WHEEL HANDLE AND SPRAY

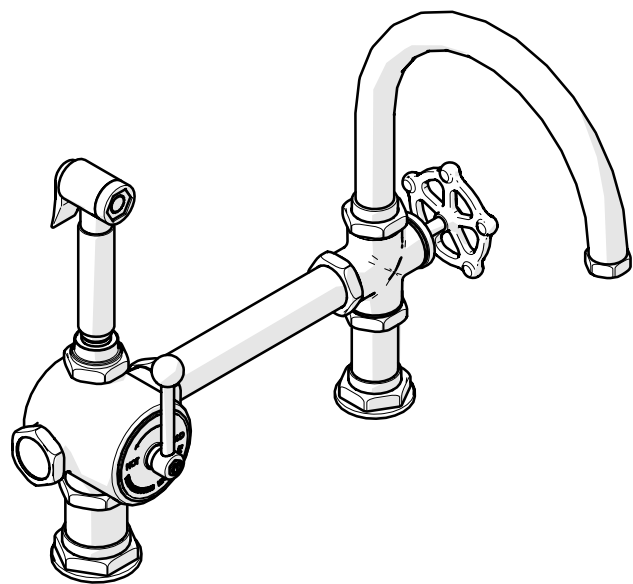

STYLES	
RGKM20	RGKM21

IMPORTANT:

- To ensure this product is installed properly, you must read and follow these guidelines.
- The owner/user of this product must keep this information for future reference.
- This product must be installed by a professional licensed contractor.
- Be sure your installation conforms to all federal, state, and local codes. In the State of Massachusetts, all installations must comply with the rules and regulations set forth within 248 CMR.
- **CAUTION:** Flushing SUPPLY VALVES (sold separately) prior to installing the KITCHEN FAUCET is recommended. Flushing can prevent damage to the CARTRIDGE and other internal components.
- Inspect this product to ensure you have all the parts required for proper installation.
- Product is **sold partially** assembled but shown fully disassembled for illustrative and service purposes only.

- Use only a strap wrench or protected/smooth-jaw wrench on any finished surface.
- The use of certain plumber's putty may stain stone or tile surfaces.
- If further assistance is required, please contact Product Support at 1-800-927-2120 Monday through Friday, 8am - 6pm EST.
- Refer to the separate Service Parts Documents for available replacement parts.

TECHNICAL DETAILS:

DETAIL	SPECIFICATION
DECK THICKNESS	1/4" [6mm] MINIMUM
	2-1/16" [52mm] MAXIMUM
FITTING HOLE DIAMETER [SPOUT]	Ø1-3/4" [44mm]
FITTING HOLE DIAMETER [THERMOSTAT]	Ø2-1/4" [57mm]
HANDLE TURN ANGLE	QUARTER TURN
INLET CONNECTION	3/8" COMPRESSION CONNECTOR HOSES †
SPOUT REACH	10" [254mm]
WATER PRESSURE RANGE	20psi [1.5 bar] MINIMUM
	85psi [6.0 bar] MAXIMUM
WATER PRESSURE RECOMMENDED	45psi [3.0 bar]

† For **INTERNATIONAL USE ONLY**, remove the lower adapter and use the 1/2" thread.

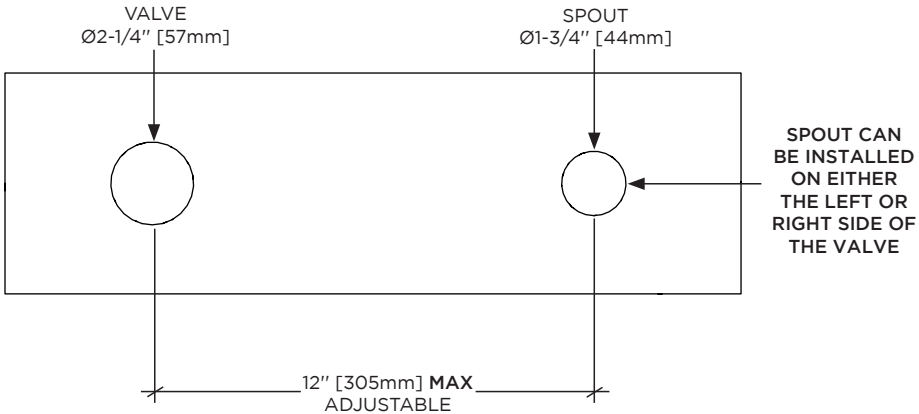

INSTALLATION GUIDELINES

GOOSENECK KITCHEN FAUCET

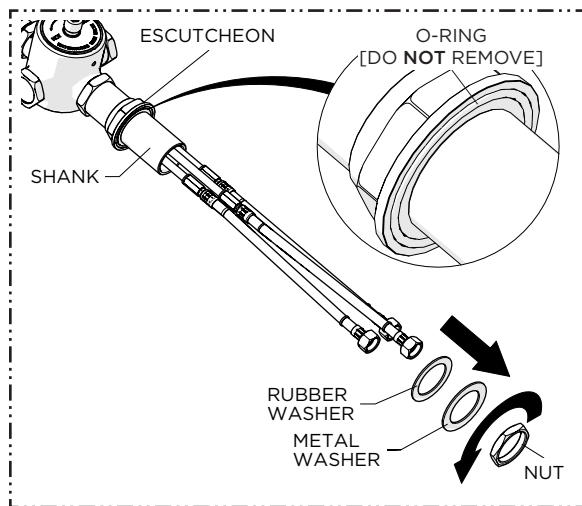

1. Remove the NUT, METAL and RUBBER WASHERS from the SHANK of the THERMOSTATIC VALVE.

NOTE: Do **NOT** remove the O-RING beneath the ESCUTCHEON.

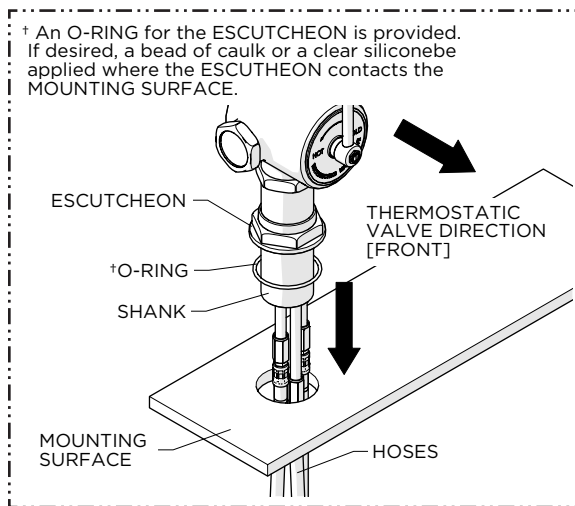
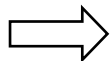

2. Ensure the COPPER TUBES and SUPPLY HOSES are properly connected, and then insert the SHANK through the hole on the MOUNTING SURFACE making sure the O-RING provided is beneath the ESCUTCHEON.

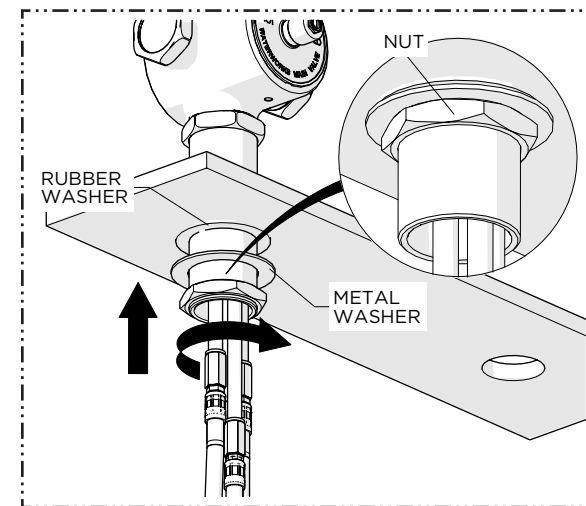
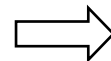

3. Re-install the RUBBER and METAL WASHERS then thread and securely tighten the NUT onto the SHANK.

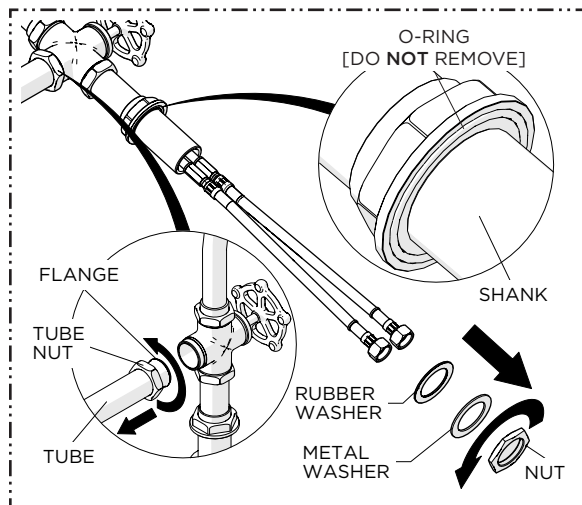

4. Remove the NUT, METAL and RUBBER WASHERS from the SPOUT SHANK, unscrew the TUBE NUT, slide it onto the TUBE, and detach the TUBE from the SPOUT, keeping the FLANGE attached.

NOTE: Do **NOT** remove the O-RING beneath the ESCUTCHEON.

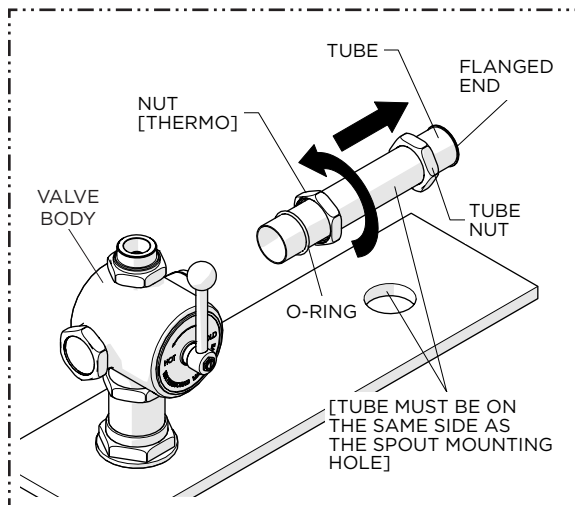
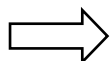

5. Remove O-RING, and NUT from THERMOSTATIC VALVE BODY, and insert them on to TUBE and then insert TUBE open end to the VALVE BODY.

NOTE: TUBE is for aesthetic purpose only may field cut (Do **not** cut at FLANGED END) with **MAX** distance between SPOUT and VALVE 12" [305mm].

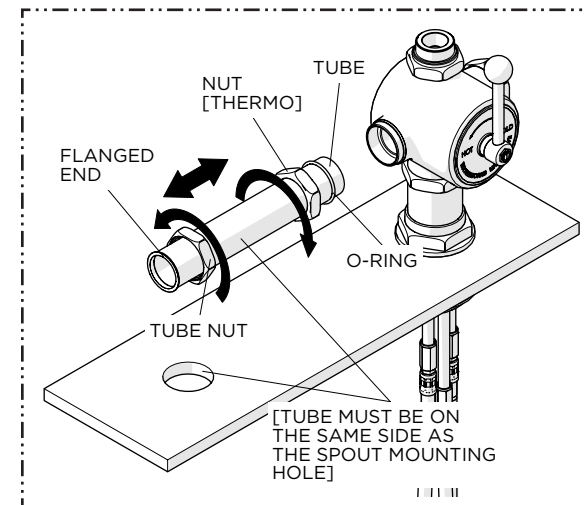
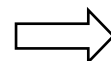

SPOUT OPTIONAL LOCATION:

6. Depending on the desired SPOUT location, remove the NUT, COVER, and WASHER from the THERMOSTATIC VALVE BODY and install them on the left side.

INSTALLATION GUIDELINES

GOOSENECK KITCHEN FAUCET

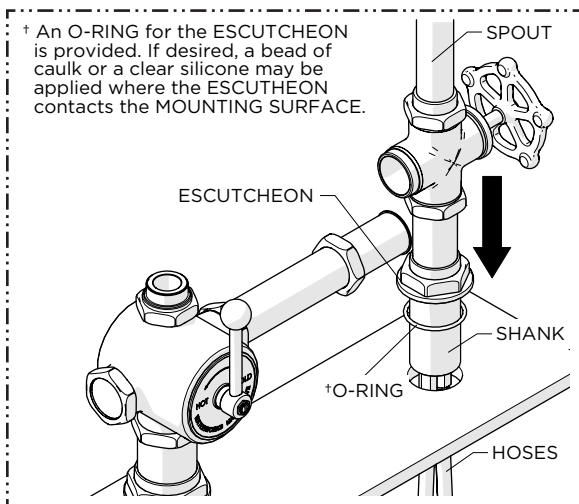

7. Ensure the COPPER TUBES and SUPPLY HOSES are properly connected, and then insert the SPOUT SHANK through the hole on the MOUNTING SURFACE making sure the O-RING provided is beneath the ESCUTCHEON.

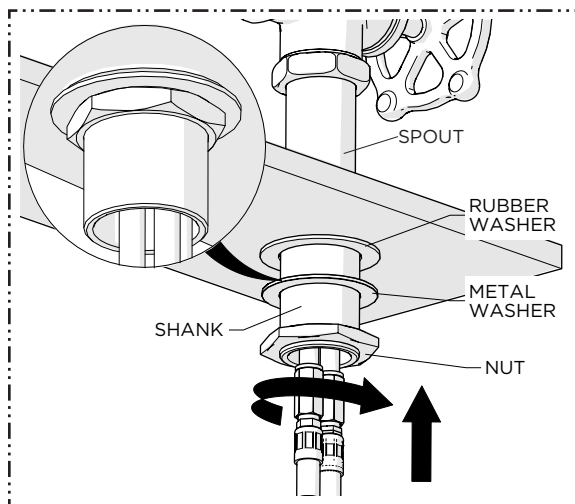

8. Re-install the RUBBER and METAL WASHERS then thread and securely tighten the NUT onto the SPOUT SHANK.

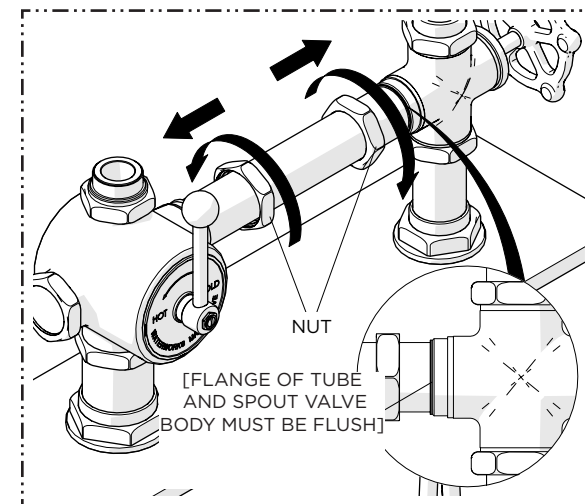
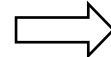

9. Ensure that the flanged end of the TUBE sits flush with the SPOUT VALVE BODY, and then thread and tighten both NUTS on the TUBE.

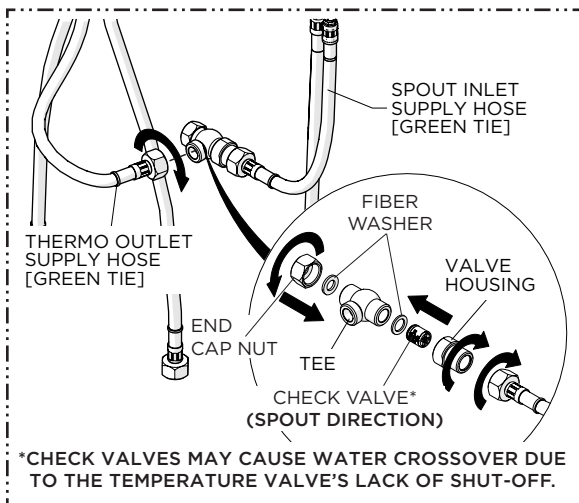

10. Connect the TEE with the FIBER WASHER and CHECK VALVE, along with the HOUSING, then attach the "GREEN" HOSE from the SPOUT to the HOUSING and the "GREEN" HOSE from the THERMOSTATIC VALVE to the TEE; finally, secure the open end of the TEE with the END CAP NUT and WASHER.

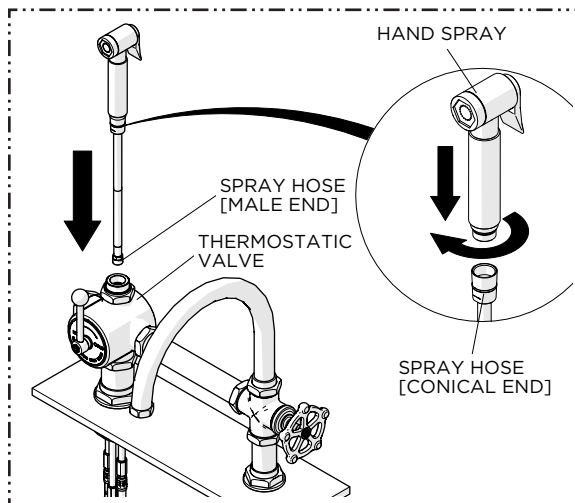
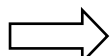

11. Connect the CONICAL END to the HAND SPRAY and insert the MALE END of the SPRAY HOSE into the top of the THERMOSTATIC VALVE.

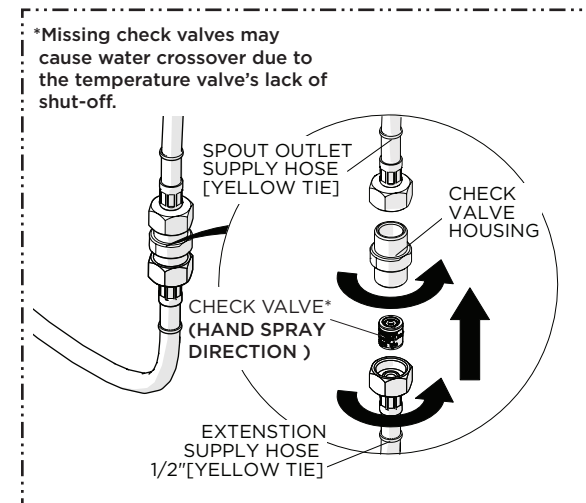
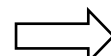

12. Connect the "YELLOW" HOSE from the SPOUT to the DUAL CHECK VALVE HOUSING, and then thread and connect the "YELLOW" EXTENSION HOSE to VALVE HOUSING along with CHECK VALVE.

INSTALLATION GUIDELINES

GOOSENECK KITCHEN FAUCET

WATERWORKS

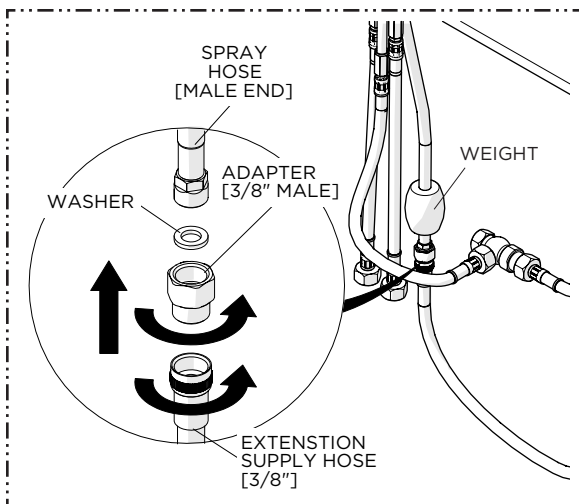

13. Thread and connect the ADAPTER to SPRAY HOSE MALE END along with THE WASHER and then connect the "YELLOW" EXTENSION HOSE other end to the ADAPTER, finally connect the WEIGHT at the base of the SPRAY HOSE.

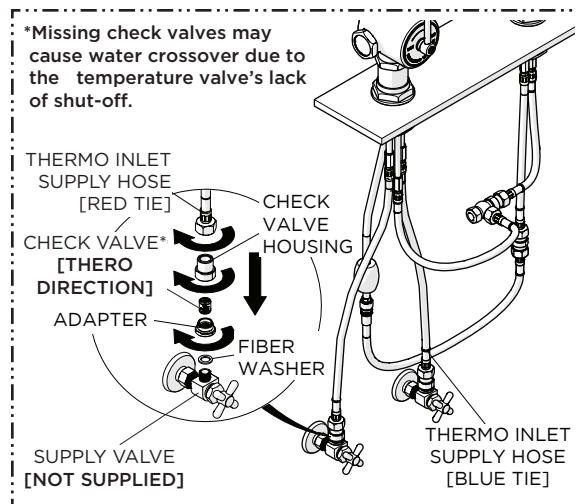

14. Connect the ADAPTER to the SUPPLY VALVE along with WASHER, and then thread the CHECK VALVE HOUSING along with CHECK VALVE to ADAPTER until snug, finally thread the SUPPLY HOSE to VALVE HOUSING.

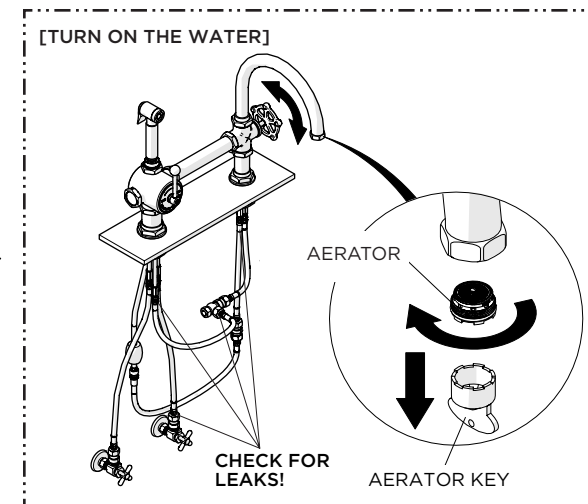
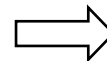

15. Remove the AERATOR from the SPOUT using the TOOL provided, then open the HOT and COLD supplies and carefully turn the WHEEL HANDLE to flush out any debris in the SUPPLY LINES before operating the HAND SPRAY and make sure to inspect all connections for **leaks**.

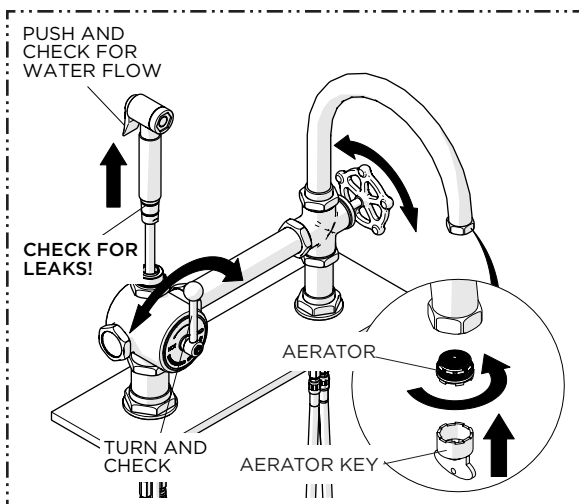

16. Remove the HAND SPRAY from the VALVE BODY and operate the HAND SPRAY and make sure to inspect all connections for **leaks**, and turn on the THERMO VALVE to check HOT and COLD, and turn off water and reinstall the AERATOR to the SPOUT.

SERVICE GUIDELINES
GOOSENECK KITCHEN FAUCET

WATERWORKS

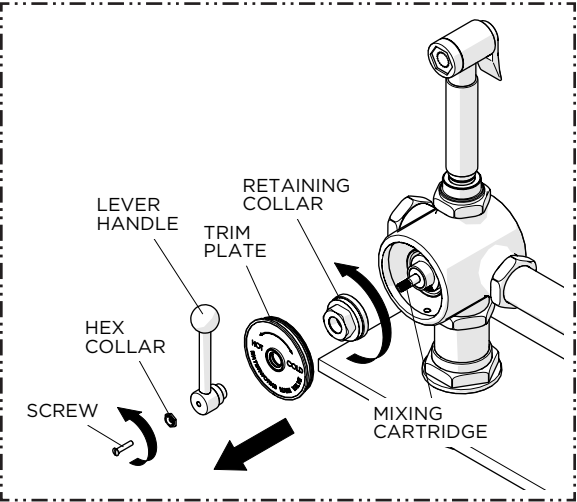

SERVICING THERMO CARTRIDGE:

1. Unthread and remove the SCREW, HEX COLLAR, LEVER HANDLE and then remove the TRIM PLATE unthread and remove the RETAINING COLLAR to expose the CARTRIDGE.

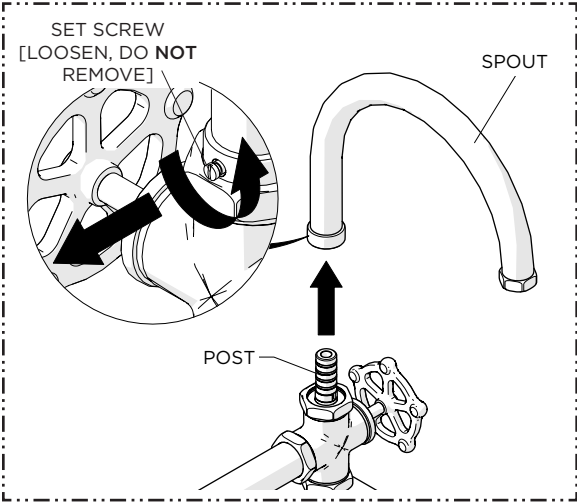

SERVICING SPOUT:

1. Loosen, but do **NOT** remove, the SET SCREW at the base of the SPOUT then pull the SPOUT up to remove it and expose the POST.

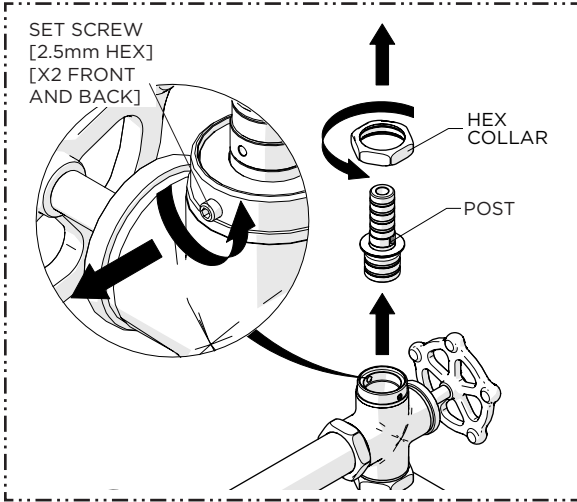

2. Unthread and remove the HEX COLLAR, loosen the exposed SET SCREWS on the front and back of VALVE BODY then pull the POST up to remove it.

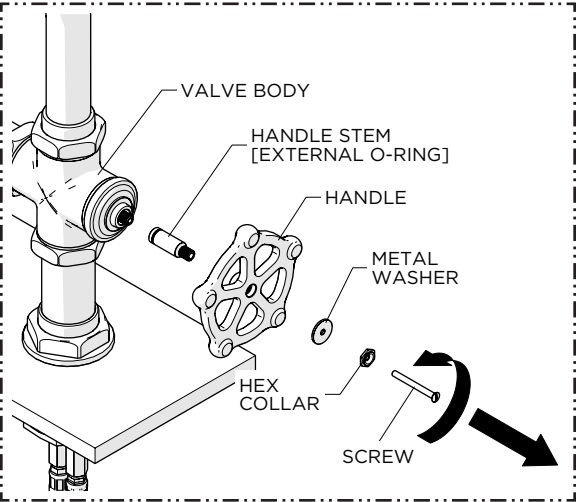

SERVICING SPOUT CARTRIDGE:

1. Unthread and remove the SCREW, HEX COLLAR, METAL WASHER, HANDLE and HANDLE STEM

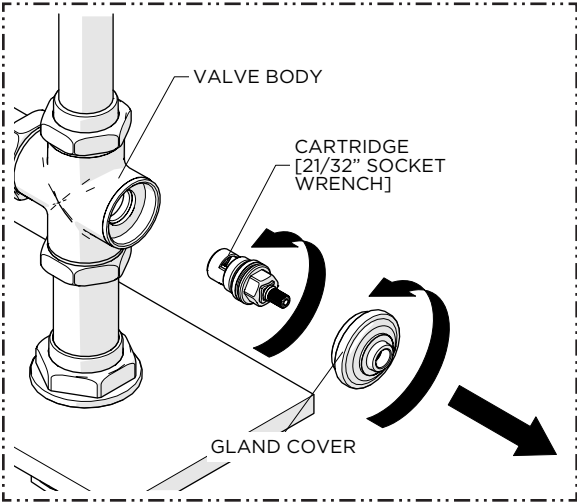

2. Unthread and remove the GLAND COVER and then unthread and remove the CARTRIDGE using a 21/32" [17mm] socket wrench.

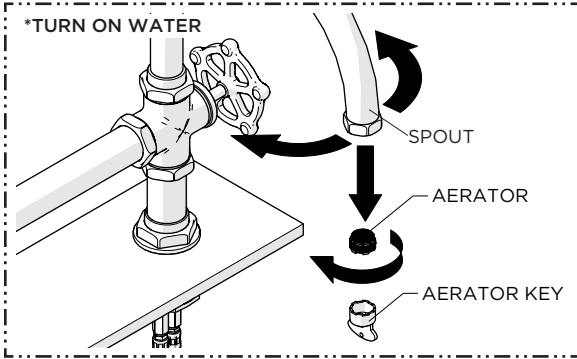

TROUBLE SHOOTING SPOUT DRIPPING:

If the faucet has a steady stream or drip of water after the unit has been shut off, air may be trapped in the body of the SPOUT and it needs to be purged.

1. Remove the AERATOR and turn water on making sure to move the SPOUT left and right while the water is running. Allow the water to run long until the dripping stops immediately after turning off the water.

NOTE: Air may be heard escaping during purging.