

# INSTALLATION GUIDELINES

## THERMOSTATIC DIVERTER VALVE TRIM

### DASH TWO-WAY OR THREE-WAY THERMOSTATIC DIVERTER VALVE TRIM WITH ROMAN NUMERALS AND METAL CROSS HANDLES

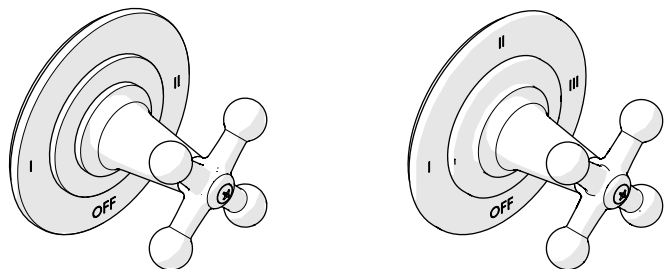

| STYLES |        |
|--------|--------|
| DS2T01 | DS3T01 |

#### IMPORTANT:

- To ensure this product is installed properly, you must read and follow these guidelines.
- The owner/user of this product must keep this information for future reference.
- This product is intended to work with a Universal Diverter Valve with Shutoff (**SOLD SEPARATELY**). Refer to the Installation Guidelines provided with the VALVE for complete rough-in installation details.
- This product must be installed by a professional licensed contractor and must be onsite prior to rough-in, this allows the installer to visualize the installation.
- Be sure your installation conforms to federal, state, and local codes. In the State of Massachusetts, all installations must comply with the rules and regulations set forth within 248 CMR.
- Inspect this product to ensure you have all the parts required for proper installation. Product is **solid partially** assembled but shown fully disassembled for illustrative and service purposes only.
- Use only a strap wrench or protected/smooth-jaw wrench on any finished surface.
- The use of certain plumber's putty may stain stone or tile surfaces.
- If further assistance is required, please contact Product Support at 1-800-927-2120 Monday through Friday, 8am - 6pm EST.
- Refer to the separate Service Parts Documents for available replacement parts.

#### REQUIRED PLUMBING DETAILS:

- ViaWorks 1/2" Two Way Diverter Valve for Thermostatic Shower Systems.  
**STYLE No. GUDV2T.**
- ViaWorks 1/2" Three Way Diverter Valve for Thermostatic Shower Systems.  
**STYLE No. GUDV3T.**

#### ROUGH-IN AND VALVE PREPARATION:

- **CAUTION:** If the VALVE is roughed-in too shallow, the TRIM cannot be installed correctly.
- **CAUTION:** Mark and remove the THREADED TUBE before cutting. Do **NOT** cut the end with the internal threads.
- **CAUTION:** The rough-in depth is measured from the centerline of the inlets to the surface of the finished wall. If the VALVE is roughed-in too shallow, the TRIM cannot be installed correctly.
- The DIVERTER VALVE TRIM components (i.e. HANDLE and TRIM PLATE) are packaged separately from each other.
- Remove and discard the TILE GUARD only when the finished wall surface (TILE or SLAB) is completed and the TRIM is ready for installation.

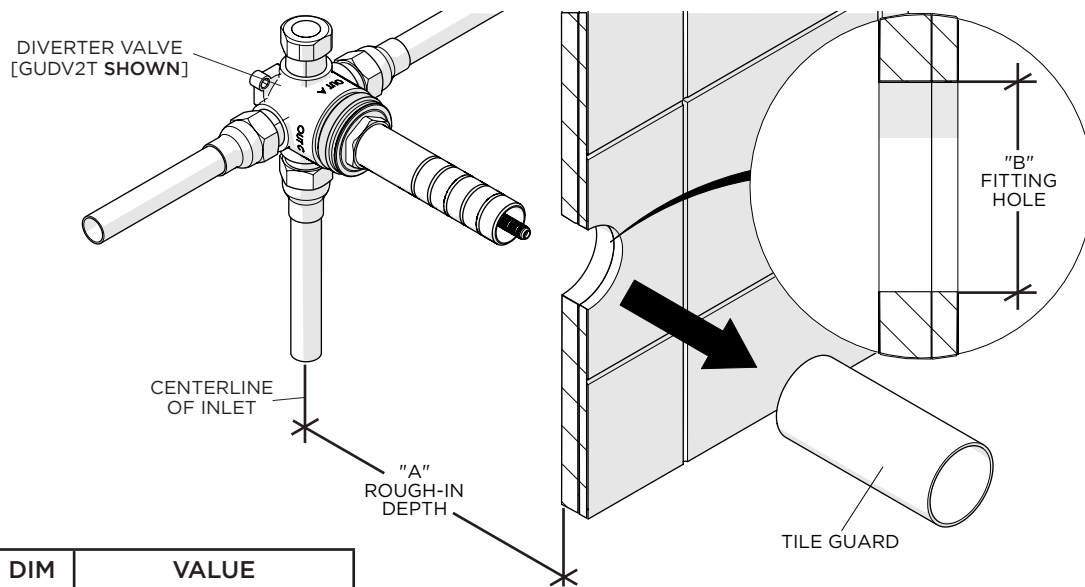

| DIM | VALUE                     |
|-----|---------------------------|
| A   | 5-1/2" [140mm] <b>MAX</b> |
|     | 2-1/2" [64mm] <b>MIN</b>  |
| B   | Ø2" [51mm]                |

# INSTALLATION GUIDELINES

## THERMOSTATIC DIVERTER VALVE TRIM

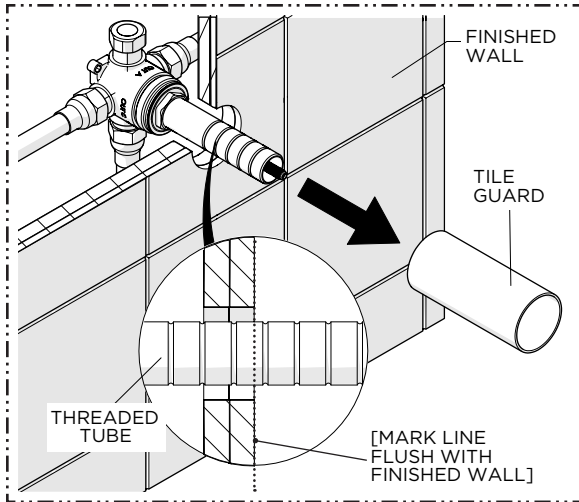

1. Remove the TILE GUARD when ready to install the TRIM then mark the THREADED TUBE where it protrudes past the FINISHED WALL.

**NOTE:** A straight edge (not supplied) can be used to mark the TUBE.

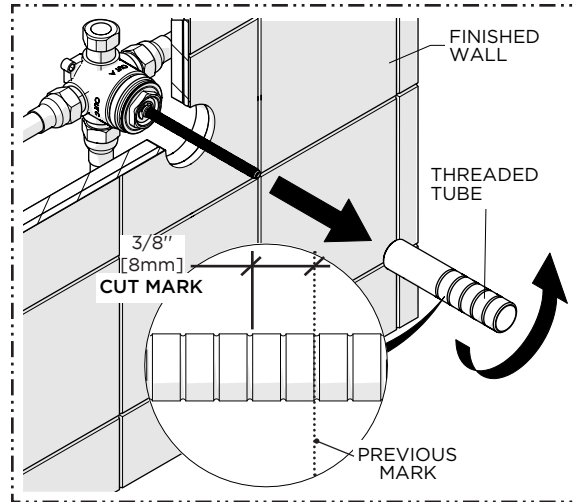

2. Remove the THREADED TUBE then cut it 5/16" [8mm] behind the previous mark so the TUBE will be 3/8" [10mm] below or recessed into the FINISHED WALL surface.

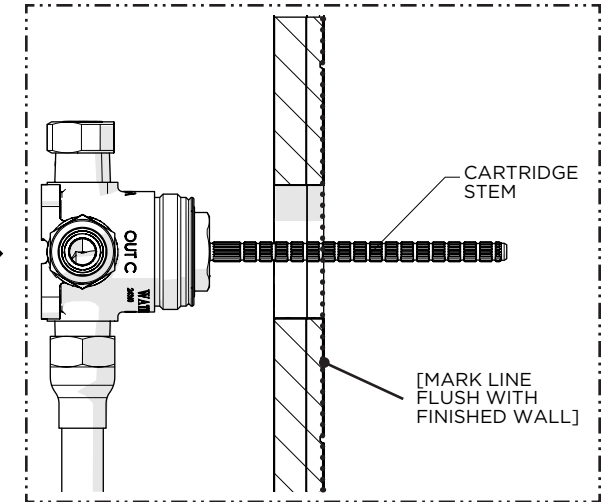

3. Mark the CARTRIDGE STEM where it protrudes past the FINISHED WALL.

**NOTE:** A straight edge (not supplied) can be used to mark the CARTRIDGE STEM.

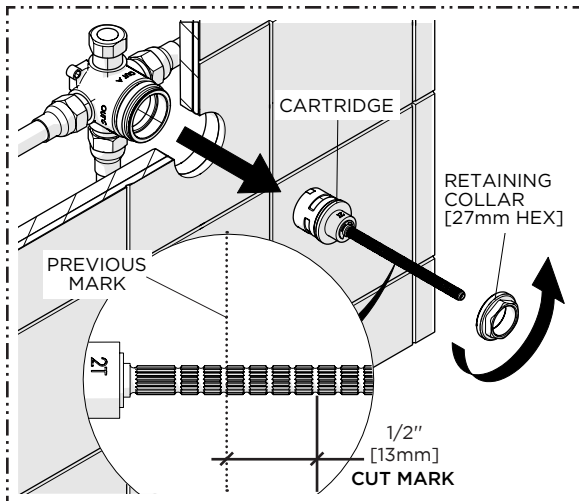

4. Unthread the RETAINING COLLAR and remove the CARTRIDGE then cut the CARTRIDGE STEM 1/2" [13mm] in front of the previous mark so the STEM will protrude 1/2" [13mm] from the finished wall surface.

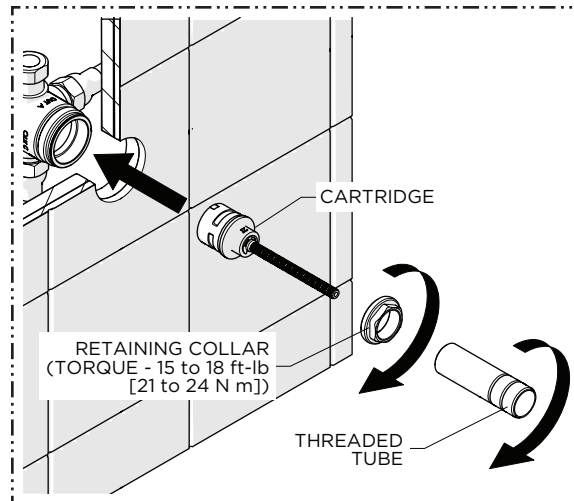

5. Re-insert the CARTRIDGE then thread and securely tighten the RETAINING COLLAR to the specified torque setting shown.

Thread the THREADED TUBE back into the RETAINING COLLAR until snug.

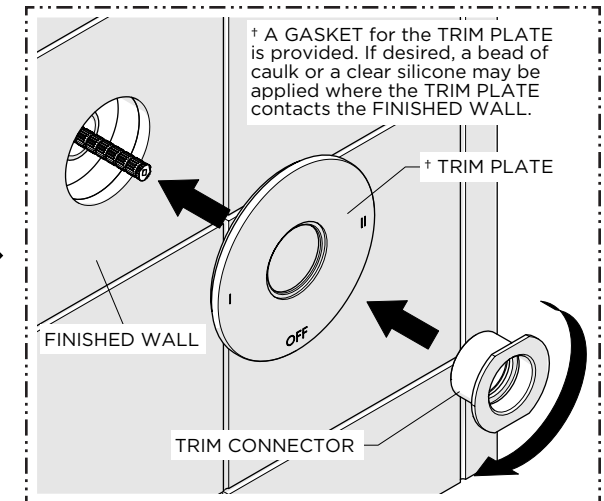

6. Hold the TRIM PLATE against the FINISHED WALL then thread and securely tighten the TRIM CONNECTOR.

† A GASKET for the TRIM PLATE is provided. If desired, a bead of caulk or a clear silicone may be applied where the TRIM PLATE contacts the FINISHED WALL.

# INSTALLATION GUIDELINES

## THERMOSTATIC DIVERTER VALVE TRIM

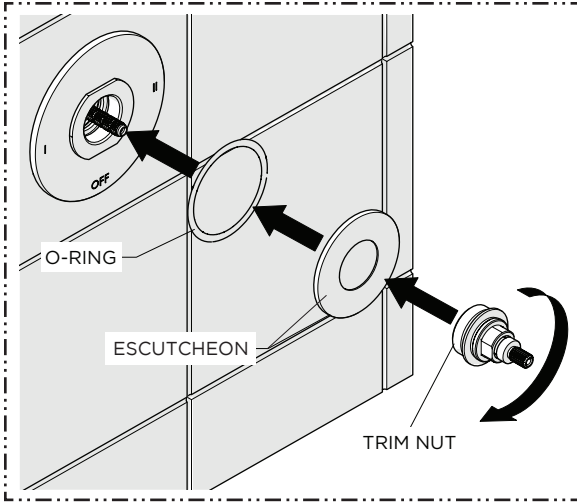

7. Hold the ESCUTCHEON against the TRIM PLATE, making sure to include the O-RING, then thread and securely tighten the TRIM NUT into the TRIM CONNECTOR.

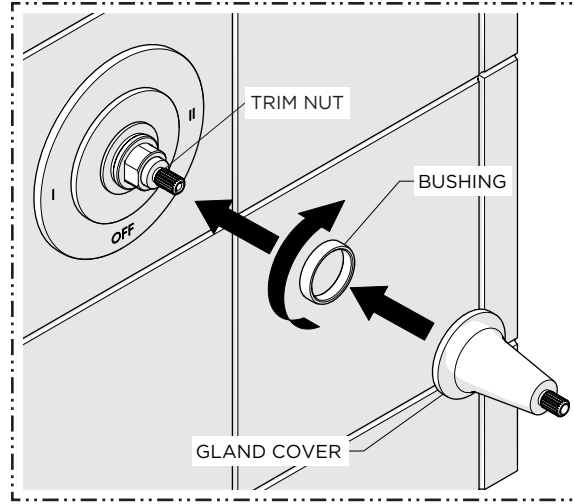
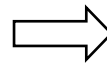

8. Thread the PLASTIC BUSHING onto the TRIM NUT then place the GLAND COVER over the TRIM NUT making sure it is fully seated.

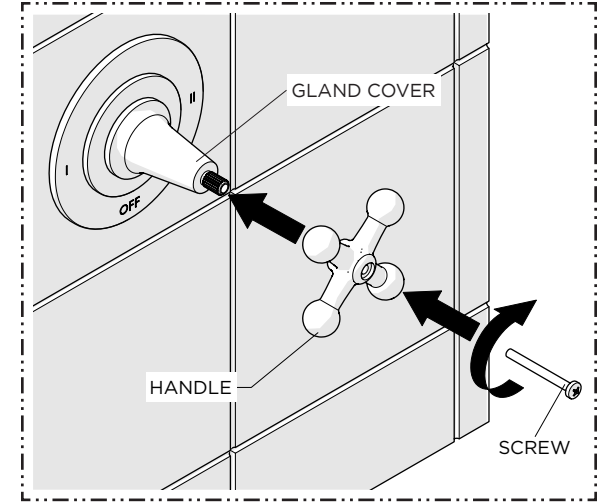
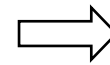

9. Place the HANDLE onto the GLAND COVER in the desired orientation then thread and securely tighten the SCREW.

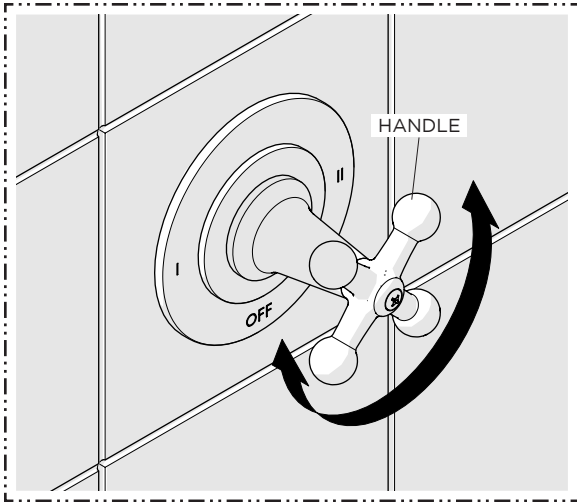

10. Turn on the water and operate the HANDLE to ensure it is functioning properly.