

HENRY

HNVC40

Henry Volume Control Valve Trim with Metal Cross Handle



SHOWN IN HENRY VOLUME CONTROL VALVE TRIM WITH METAL CROSS HANDLE | HNVC40

TECHNICAL DETAILS

ADA Compliance: Yes
 Depth/Width: 2 15/16"
 Escutcheon Primary Material: Brass
 Fittings Hole Diameter: 1 3/8"
 Height: 2 3/8"
 Integrated Diverter: N
 Integrated Spray: N
 Length: 2 3/8"
 Number Of Handles: One
 Pivot: N
 Primary Material: Brass
 Spout Swivel: N
 Spray Included In Unit: N
 Suggested Application: Bath

INSPIRATION

Influenced by the connection of industry and art Henry easily transitions between modern, traditional, utilitarian and classic settings.

CODES & STANDARDS

ASME A112.18.1/CSA B125.1, State of MA

PRODUCT FEATURES

The manufacturing process encompasses casting, turning, forging, hand-fitting and hand polishing.

Brass material is used for components

CERTIFICATIONS



PRODUCT (NOTES)

HENRY

HNVC40

Henry Volume Control Valve Trim with Metal Cross Handle

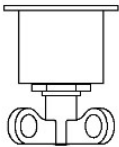

TOP VIEW SCALE: 3"=1'-0"

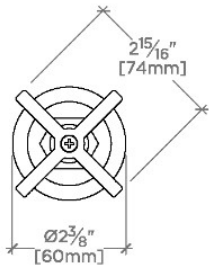

FRONT VIEW SCALE: 3"=1'-0"

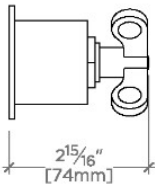

SIDE VIEW SCALE: 3"=1'-0"