

HENRY

HN2T13

Henry Two Way Diverter Valve Trim for Thermostatic with Roman Numerals and Coin Edge Lever Handle

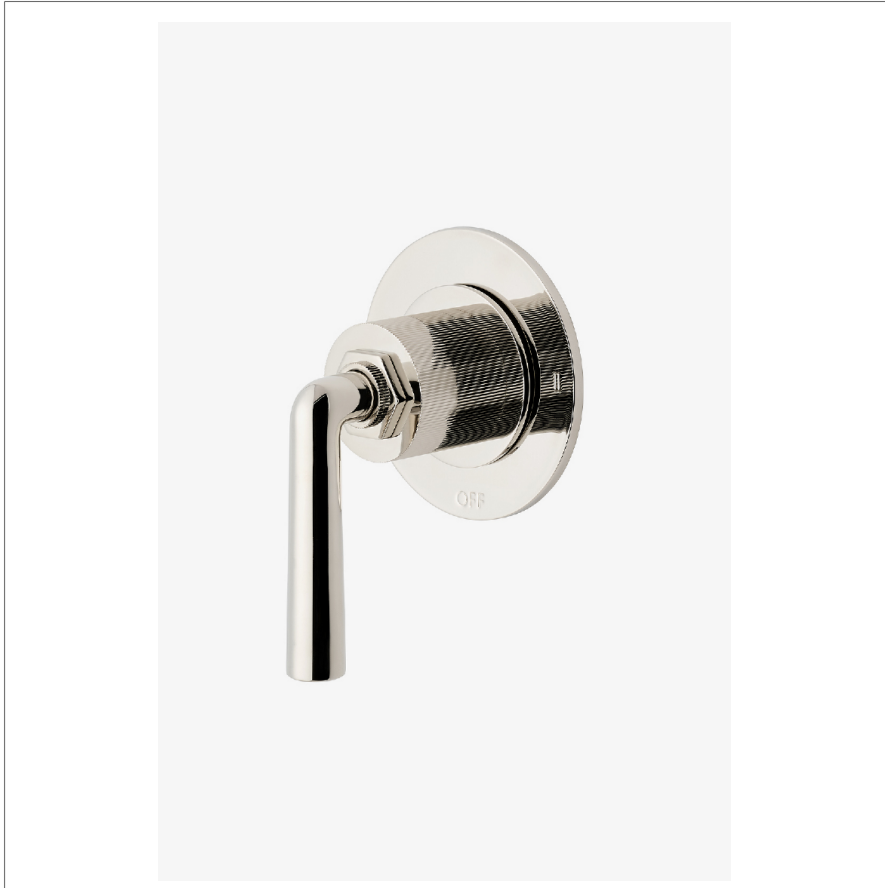

SHOWN IN HENRY TWO WAY DIVERTER VALVE TRIM FOR THERMOSTATIC WITH ROMAN NUMERALS AND COIN EDGE LEVER HANDLE | HN2T13

TECHNICAL DETAILS

ADA Compliance: Yes
Fittings Hole Diameter: 2"
Handle Turn Angle: Quarter Turn Each Way
Number Of Holes: One Hole
Primary Material: Brass

INSPIRATION

Influenced by the connection of industry and art Henry easily transitions between modern, traditional, utilitarian and classic settings.

CODES & STANDARDS

ASME A112.18.1/CSA B125.1, State of MA

PRODUCT FEATURES

- Coin Edge Lever Handle
- For Use with a Thermostatic Shower System and Two Waterway Outlets
- Features Roman Numerals Representing Outlet Position
- Stocked in Brass, Chrome, Nickel and Dark Nickel
- Requires valve rough sold separately

CERTIFICATIONS



PRODUCT (NOTES)

HENRY

HN2T13

Henry Two Way Diverter Valve Trim for Thermostatic with Roman Numerals and Coin Edge Lever Handle

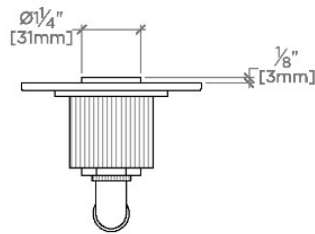

TOP VIEW

SCALE: 3"=1'-0"

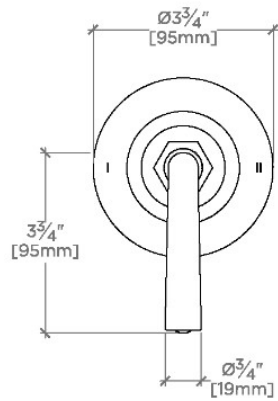

FRONT VIEW

SCALE: 3"=1'-0"

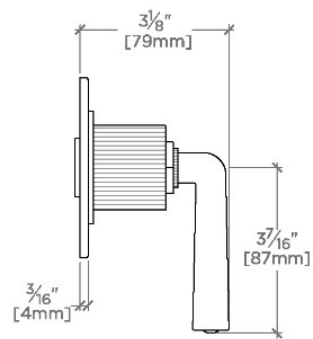

SIDE VIEW

SCALE: 3"=1'-0"