

Regulator

RGCH24

Regulator 24" Ceiling Mounted Shower Arm with Flange

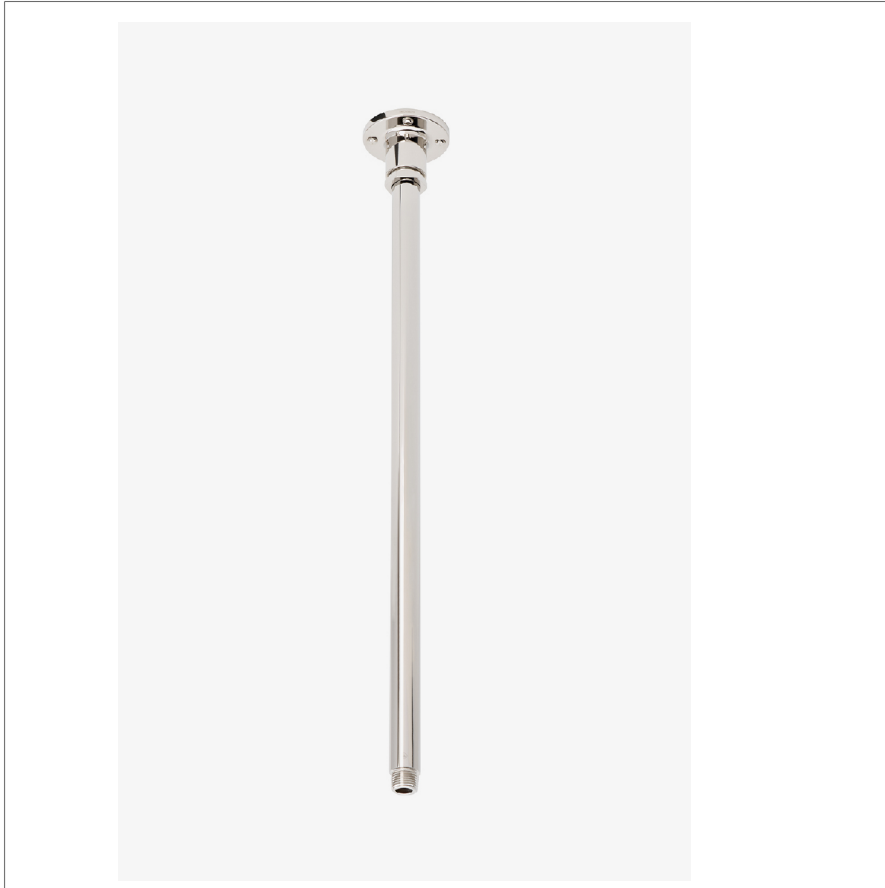

SHOWN IN REGULATOR 24" CEILING MOUNTED SHOWER ARM WITH FLANGE | RGCH24

TECHNICAL DETAILS

Fittings Hole Diameter: 32 mm
 Inlet Connection Size: 1/2"
 Inlet Connection Type: Male NPT
 Outlet Connection Size: 1/2"
 Outlet Connection Type: Male NPT
 Water Pressure Recommended: 3.0 bar

INSPIRATION

A play on industrial controls from the early 1900s, when pride was lavished on parts. Translated to handcrafted, fittings project rugged beauty through powerful, detailed shapes.

CODES & STANDARDS

PRODUCT FEATURES

Compatible with an assortment of Waterworks showerheads, sold separately

Brass Construction

Includes 24" ceiling mounted shower arm

Stocked in Chrome, Nickel and Brass

CERTIFICATIONS

PRODUCT (NOTES)

Regulator

RGCH24

Regulator 24" Ceiling Mounted Shower Arm with Flange

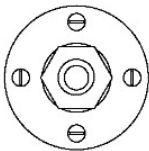

CEILING VIEW SCALE: 3"=1'-0"

STYLE NO.	DIM "A"	DIM "B"
RGCH06	7 ¹ / ₈ " [181mm]	6 ⁹ / ₁₆ " [167mm]
RGCH12	13 ¹ / ₈ " [334mm]	12 ⁹ / ₁₆ " [319mm]
RGCH18	19 ¹ / ₈ " [486mm]	18 ⁹ / ₁₆ " [471mm]
RGCH24	25 ¹ / ₈ " [639mm]	24 ⁹ / ₁₆ " [624mm]

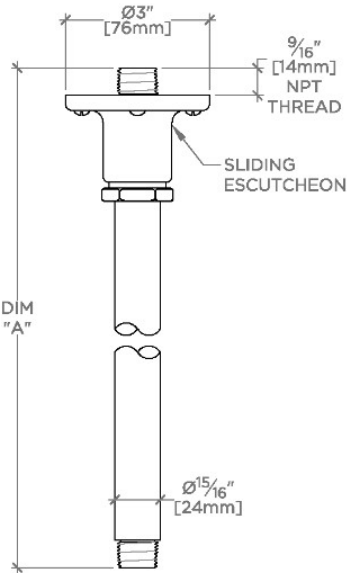

FRONT VIEW SCALE: 3"=1'-0"

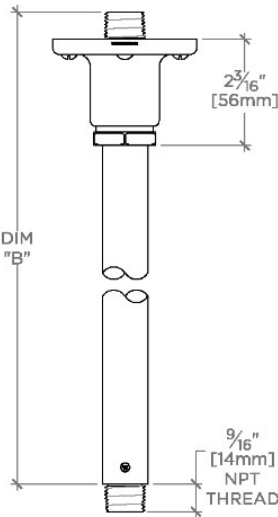

SIDE VIEW SCALE: 3"=1'-0"