

## HENRY

## HN2T12

Henry Two Way Diverter Valve Trim for Thermostatic with Roman Numerals and Two-Tone Lever Handle

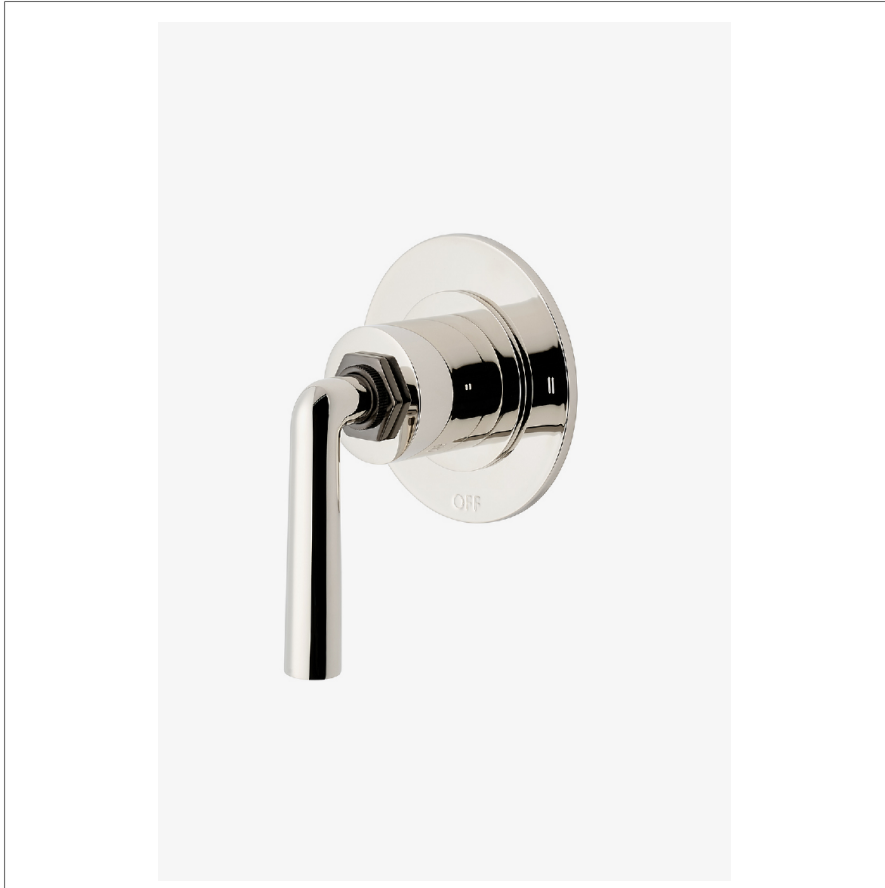

SHOWN IN HENRY TWO WAY DIVERTER VALVE TRIM FOR THERMOSTATIC WITH ROMAN NUMERALS AND TWO-TONE LEVER HANDLE | HN2T12

### TECHNICAL DETAILS

ADA Compliance: Yes  
Fittings Hole Diameter: 2"  
Handle Turn Angle: Quarter Turn Each Way  
Number Of Holes: One Hole  
Primary Material: Brass

### INSPIRATION

Influenced by the connection of industry and art Henry easily transitions between modern, traditional, utilitarian and classic settings.

### CODES & STANDARDS

ASME A112.18.1/CSA B125.1, State of MA

### PRODUCT FEATURES

- Two-Tone Lever Handle
- For Use with a Thermostatic Shower System and Two Waterway Outlets
- Features Roman Numerals Representing Outlet Position
- Stocked in Brass/Dark Nickel and Nickel/Dark Nickel
- Requires valve rough sold separately

### CERTIFICATIONS



### PRODUCT (NOTES)

## HENRY

HN2T12

Henry Two Way Diverter Valve Trim for Thermostatic with Roman Numerals and Two-Tone Lever Handle

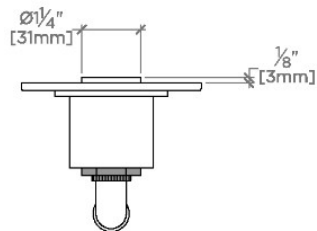

TOP VIEW

SCALE: 3"=1'-0"

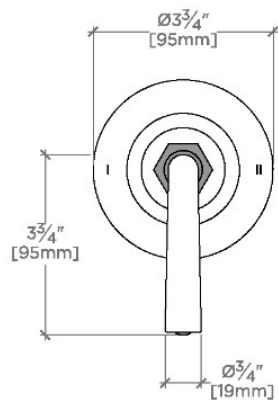

FRONT VIEW

SCALE: 3"=1'-0"

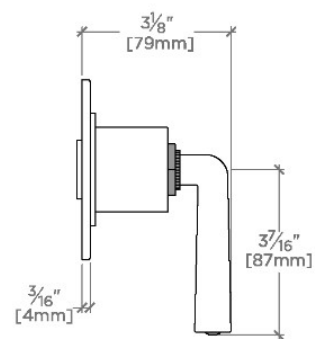

SIDE VIEW

SCALE: 3"=1'-0"