

## Regulator

RGWH06

Regulator 6" Wall Mounted 45 Degree Shower Arm with Flange



SHOWN IN REGULATOR 6" WALL MOUNTED 45 DEGREE SHOWER ARM WITH FLANGE | RGWH06

### TECHNICAL DETAILS

Fittings Hole Diameter: 32 mm  
Inlet Connection Size: 1/2"  
Inlet Connection Type: Male NPT  
Outlet Connection Size: 1/2"  
Outlet Connection Type: Male NPT  
Water Pressure Recommended: 3.0 bar

### INSPIRATION

A play on industrial controls from the early 1900s, when pride was lavished on parts. Translated to handcrafted, fittings project rugged beauty through powerful, detailed shapes.

### CODES & STANDARDS

### PRODUCT FEATURES

Compatible with an assortment of Waterworks showerheads, sold separately

Brass Construction

Includes 6" wall mounted 45 degree shower arm

Stocked in Chrome, Nickel and Brass

### CERTIFICATIONS

### PRODUCT (NOTES)

Regulator

RGWH06

Regulator 6" Wall Mounted 45 Degree Shower Arm with Flange

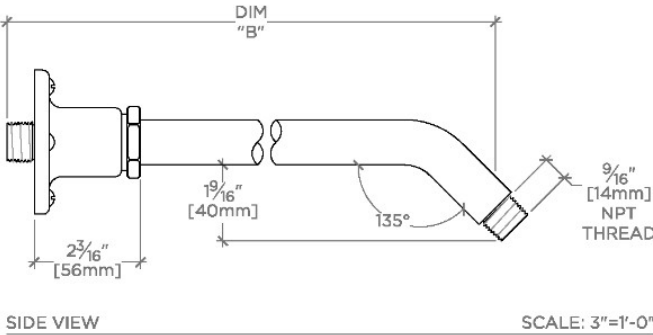
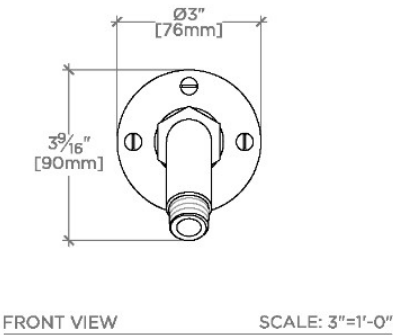
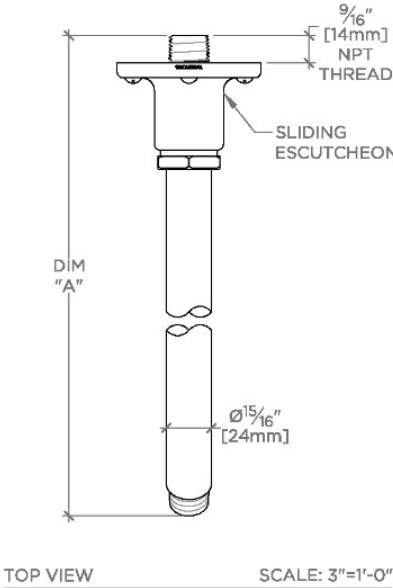

STYLE NO.	DIM "A"	DIM "B"
RGWH06	$6\frac{15}{16}$ " [176mm]	$6\frac{1}{4}$ " [158mm]
RGWH08	$8\frac{15}{16}$ " [226mm]	$8\frac{3}{4}$ " [209mm]
RGWH10	$10\frac{15}{16}$ " [277mm]	$10\frac{3}{4}$ " [260mm]