

Metal Wheel Handles
STYLE No. RWXT20

Metal Lever Handles
STYLE No. RWXT30

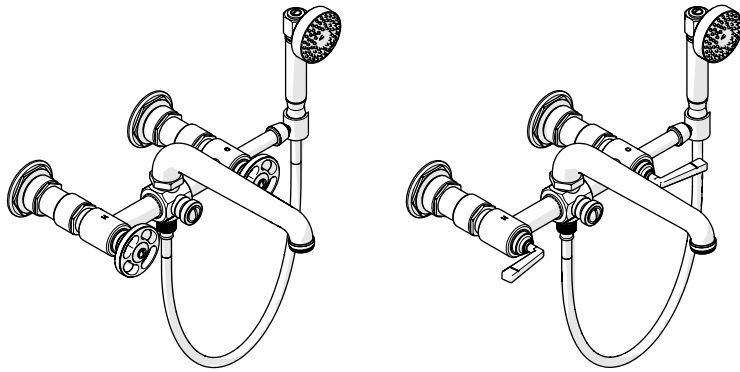

TECHNICAL DETAILS:

DETAIL	SPECIFICATION
Handle Spread	8" [203mm] [NOT ADJUSTABLE]
Fitting Hole Diameter	Ø1-1/4" [32mm]*
Inlet/Outlet Connection Size & Type	3/4" Copper Sweat (22mm Copper Sweat)
Inlet Spread	8" [203mm] [NOT ADJUSTABLE]
Spout Outlet Height	36" [914mm]
Spout Reach	8-9/16" [217mm]
Water Pressure	20 psi MINIMUM
	80psi MAXIMUM [1.4 Bar Min - 5.5 Bar Max]
Water Pressure Recommended	45 psi (3 Bar)

IMPORTANT:

- To ensure this product is installed properly, you must read and follow these guidelines.
- The owner/user of this product must keep this information for future reference.
- Be sure your installation conforms to federal state, and local codes. Anti-scald protection is the responsibility of the installer and according to applicable codes.
- In the State of Massachusetts, all installations must comply with the rules and regulations set forth within 248 CMR.
- This product must be installed by a professional licensed contractor.
- Product should be on-site prior to rough-in. This allows the installer to visualize the installation and verify the inlet connection spread.
- Refer to the specifications and assembly drawings attached. Product is sold partially assembled but shown fully disassembled for illustrative and service purposes only.

- Check tub measurements to assure the spout projects far enough into the tub.
- Inspect this product to ensure you have all the parts required for proper installation.
- Use only a strap wrench or protected/smooth-jaw wrench on any finished surface.
- Run 3/4" (22mm) SUPPLY LINES for **maximum** flow at an 8" Spread (**NOT ADJUSTABLE**).
- Install accessible **hot** and **cold** service stop valves to facilitate servicing.

ROUGH-IN:

1. Run well supported 3/4" (22mm) **hot** and **cold** SUPPLY LINES for **maximum** water flow. The inlet supply spread is 8" center-to-center and is **not adjustable**.
2. Run 3/4" copper supplies out through the finished wall and cap-off each line.

TUB FILLER INSTALLATION:

- See Figure 1 for Steps 3-5
- 3. Cut the COPPER SUPPLY LINES so that they protrude 2-1/16" [53mm] from the finished wall.
- 4. Sweat or solder the 3/4" SWEAT ADAPTERS to the cut copper pipe, making sure that the adapters are protruding 3-3/16" [81mm] from the finished wall.

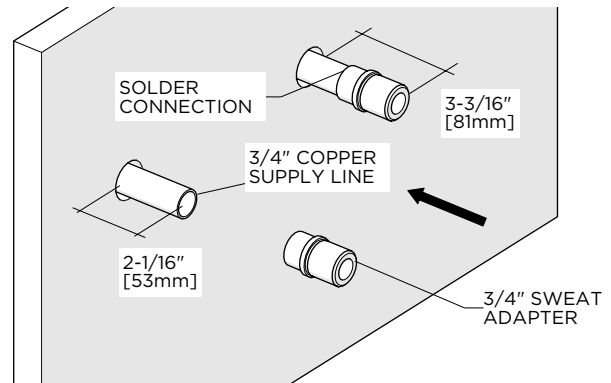

FIGURE - 01

- See Figure 2 & Figure 3 for Steps 5-10.
- 5. Unthread the **BOTTOM CAP** and remove **LEG, ESCUTCHEON & O-RING** from each side of the **TUB FILLER BODY**.
- 6. Place the **LEG & ESCUTCHEON** against the wall, over the copper pipe and **SWEAT ADAPTER**, making sure the **ORING** is behind.
- 7. Slide the **BOTTOM CAP** down the **LEG**, against the **ESCUTCHEON**, revealing the **SWEAT ADAPTER**.
- 8. Attach the **TUB FILLER BODY** by aligning the **UNION CONNECTIONS** with the **SWEAT ADAPTERS**, making sure the **RED FIBER WASHER** is between.
- 9. Tighten the **UNION CONNECTIONS** to the **SWEAT ADAPTERS** to secure **TUB FILLER BODY** to the wall.

These guidelines have been prepared for the professional contractor to aid in the installation of:
R.W. ATLAS WALL MOUNTED EXPOSED TUB FILLER (STYLE No. RWXT20, RWXT30)
All dimensions are based on original specification and are subject to change and variation.
Please consult your Design Associate for current specifications.

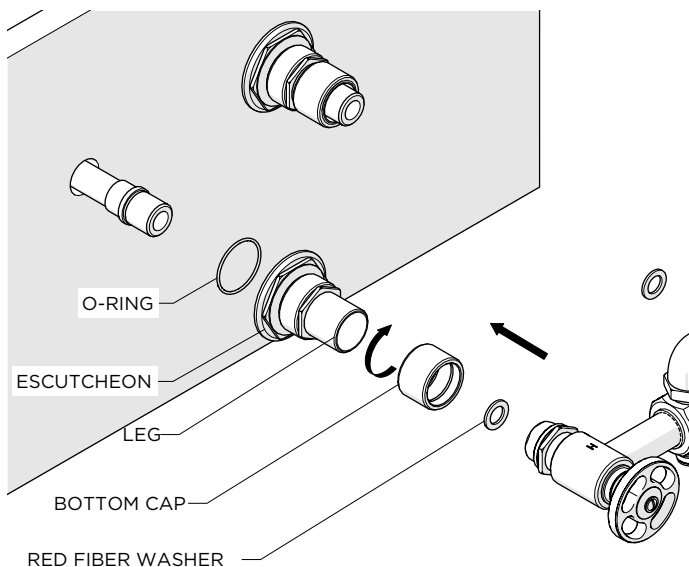

FIGURE - 02

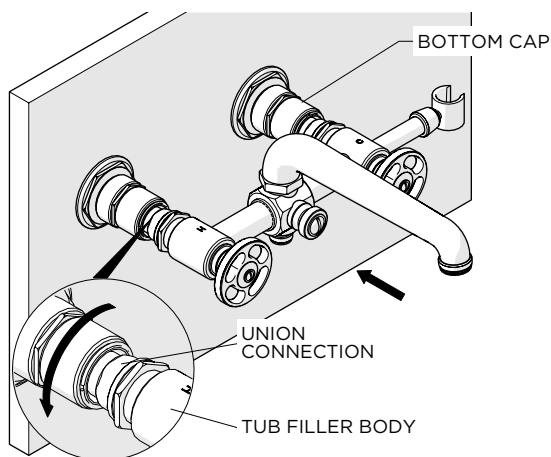

FIGURE - 03

HANDSHOWER INSTALLATION:

➤ See Figure 4. for Steps 10-11.

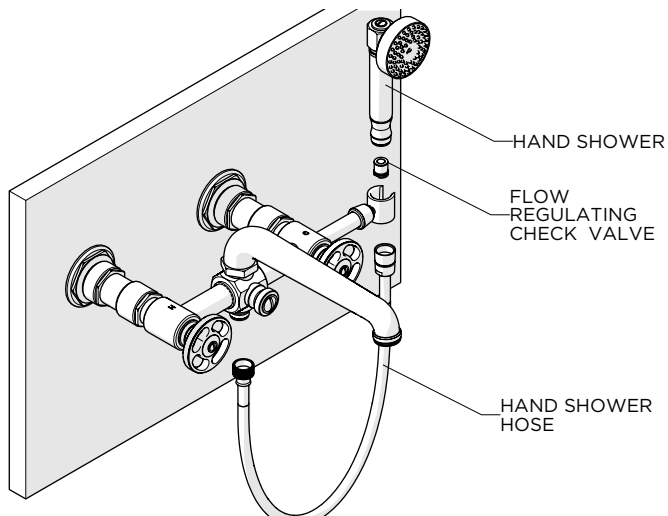

FIGURE - 04

10. Attach the conical end of HANDSHOWER HOSE to the HANDSHOWER.
11. Connect the other end of the HANDSHOWER HOSE to the HANDSHOWER OUTLET. Place the handshower on the HOOK.

NOTE: The FLOW REGULATING CHECK VALVE is located in the inlet of the HANDSHOWER and the CHECK VALVE is located in the outlet of the HANDSHOWER OUTLET.

INSPECT THE INSTALLATION:

12. Turn on the supplies then open the **hot** and **cold** valves to flush out any debris in the SUPPLY LINES before diverting to the handshower. To divert to the hand shower turn the diverter lever handle, which is the center handle.
13. Carefully inspect all connections for **leaks** and check for proper operation.

SERVICING:

- See Figure 5. for Steps 14-16.
 - Service stops should be turned off prior to servicing.
14. If the CARTRIDGES need servicing, the HANDLE ASSEMBLY can be unthreaded from the BODY to access them.
 15. If entire BODY needs to be replaced, unthread BOTTOM CAPS and slide them down the legs to access UNION CONNECTIONS.
 16. To service the DIVERTER, unthread the DIVERTER KNOB and remove DIVERTER.

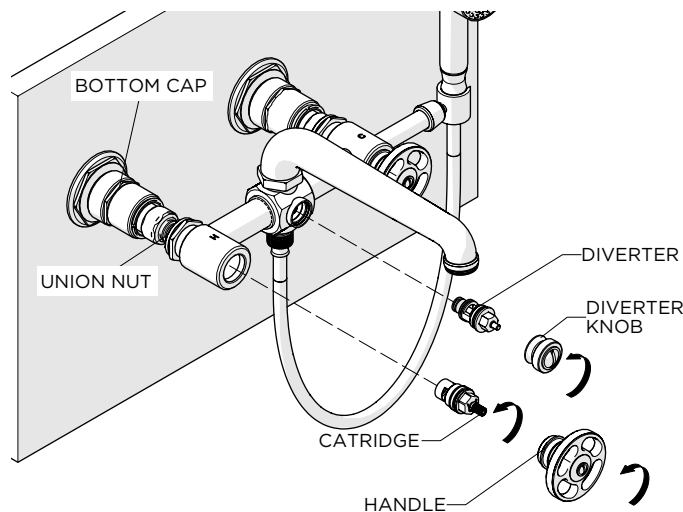

FIGURE - 05

- If further assistance is required, please contact Product Support at 1-800-927-2120 (9am-6pm EST).
- See service part document for parts ordering, available on WATERWORKS.COM.

These guidelines have been prepared for the professional contractor to aid in the installation of:
R.W. ATLAS WALL MOUNTED EXPOSED TUB FILLER (STYLE No. RWXT20, RWXT30)
All dimensions are based on original specification and are subject to change and variation.
Please consult your Design Associate for current specifications.