

HENRY CHRONOS

CN3T11

Henry Chronos Three Way Diverter Valve Trim for
Thermostatic with Roman Numerals and Lever Handle



SHOWN IN HENRY CHRONOS THREE WAY DIVERTER VALVE TRIM FOR THERMOSTATIC WITH ROMAN NUMERALS AND LEVER
HANDLE | CN3T11

TECHNICAL DETAILS

ADA Compliance: Yes
Fittings Hole Diameter: 2"
Handle Turn Angle: Full Turn
Number Of Holes: One Hole
Primary Material: Brass

INSPIRATION

Inspired by dive watches, Henry Chronos radiates design prowess and technical precision. Chronos retains the design integrity of our original, iconic Henry collection, while imbuing it with modern details and exquisite materials.

CODES & STANDARDS

ASME A112.18.1/CSA B125.1, State of MA

PRODUCT FEATURES

- Features All Metal Lever Handle
- For Use With a Thermostatic Shower System and Three Waterway Outlets
- Features Roman Numerals Representing Outlet Position
- Stocked in Brass, Chrome and Nickel
- Requires valve rough sold separately

CERTIFICATIONS



PRODUCT (NOTES)

HENRY CHRONOS

CN3T11

Henry Chronos Three Way Diverter Valve Trim for
Thermostatic with Roman Numerals and Lever Handle

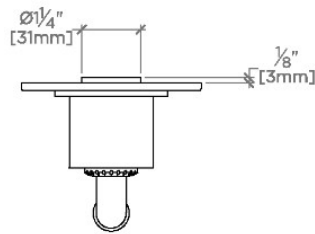

TOP VIEW

SCALE: 3"=1'-0"

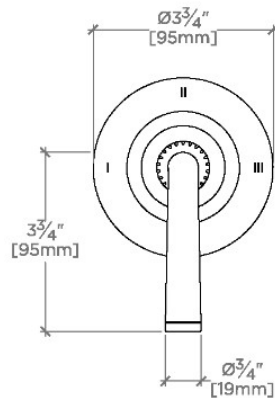

FRONT VIEW

SCALE: 3"=1'-0"

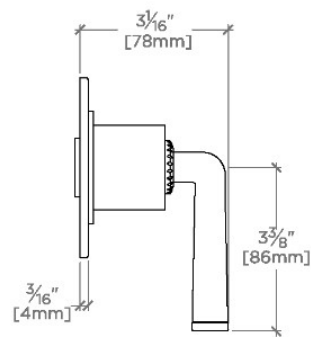

SIDE VIEW

SCALE: 3"=1'-0"