

# INSTALLATION GUIDELINES

## EXPOSED TUB FILLER

### REGULATOR DECK MOUNTED EXPOSED TUB FILLER WITH HANDSHOWER



STYLES			
RGXT40	RGXT41 [SHOWN]	RGXT50	RGXT51 [SHOWN]

### REGULATOR FLOOR MOUNTED EXPOSED TUB FILLER WITH HANDSHOWER

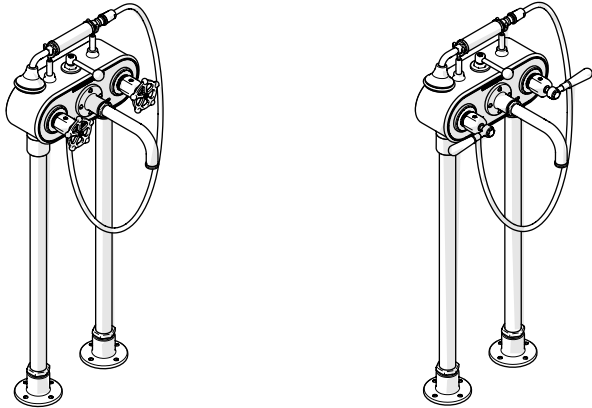

STYLES			
RGXT60	RGXT61 [SHOWN]	RGXT70	RGXT71 [SHOWN]

# WATERWORKS

### IMPORTANT:

- To ensure this product is installed properly, you must read and follow these guidelines.
- The owner/user of this product must keep this information for future reference.
- This product must be installed by a professional licensed contractor and must be on-site prior to rough-in. This allows the installer to visualize the installation verify the 8" [203mm] on-center inlet supply spread. The inlet supply spread on this product is **NOT** adjustable.
- **NOTE:** Required UNIONS are sold separately.
- Check the TUB measurements to assure the SPOUT projects far enough into the TUB.
- Run 3/4" supply lines for **MAXIMUM** flow and install **ACCESSIBLE** hot and cold service stop valves to facilitate servicing.
- Be sure your installation conforms to all federal, state, and local codes.
  - Anti-scald protection is the responsibility of the installer and according to applicable codes.
  - A water temperature limiting device is the responsibility of the installer and must be in accordance with ASSE 1070.
  - In the State of Massachusetts, all installations must comply with the rules and regulations set forth within 248 CMR.
- Inspect this product to ensure it is the correct model and you have all the parts required for proper installation. Product is sold partially assembled but shown fully disassembled for illustrative and service purposes only.
- Use only a strap wrench or protected/smooth-jaw wrench on any finished surface.
- The use of certain plumber's putty may stain stone or tile surfaces.
- If further assistance is required, please contact Product Support at 1-800-927-2120 Monday through Friday, 8am - 6pm EST.
- Refer to the separate Service Parts Documents for available replacement parts.

# INSTALLATION GUIDELINES

## DECK MOUNTED EXPOSED TUB FILLER

### TECHNICAL DETAILS:

DETAIL	SPECIFICATION
DIAMETER OF HEAD	Ø2-3/4" [70mm]
FITTING HOLE DIAMETER	Ø1-3/8" [35mm]
HANDLE TURN ANGLE	QUARTER TURN
HANDSHOWER HOSE LENGTH	60" [1525mm]
INLET CONNECTION	3/4" MALE NPT ‡
INLET SUPPLY SPREAD	8" [203mm] <b>(NOT ADJUSTABLE)</b>
INTEGRATED DIVERTER	YES
SPOUT REACH	9-3/4" [248mm]
WATER PRESSURE RANGE	20psi [1.5 bar] <b>MIN</b> 85psi [6.0 bar] <b>MAX</b>
WATER PRESSURE RECOMMENDED	45psi [3.0 bar]

‡ **Deck Mounted** - Deck Unions are Sold Separately as GDUN01 for US & GD01UN for International Installations.

**Floor Mounted** - Floor Unions are Sold Separately as GFUN01.

### ROUGH-IN:

- **WARNING:** The inlet supply spread on this product is NOT adjustable. If the rough-in is NOT accurate it will make the installation difficult or impossible.
- Run well supported 3/4" hot and cold copper supply lines for MAXIMUM water flow.
- **CAUTION:** An access panel must be installed for servicing and installation.

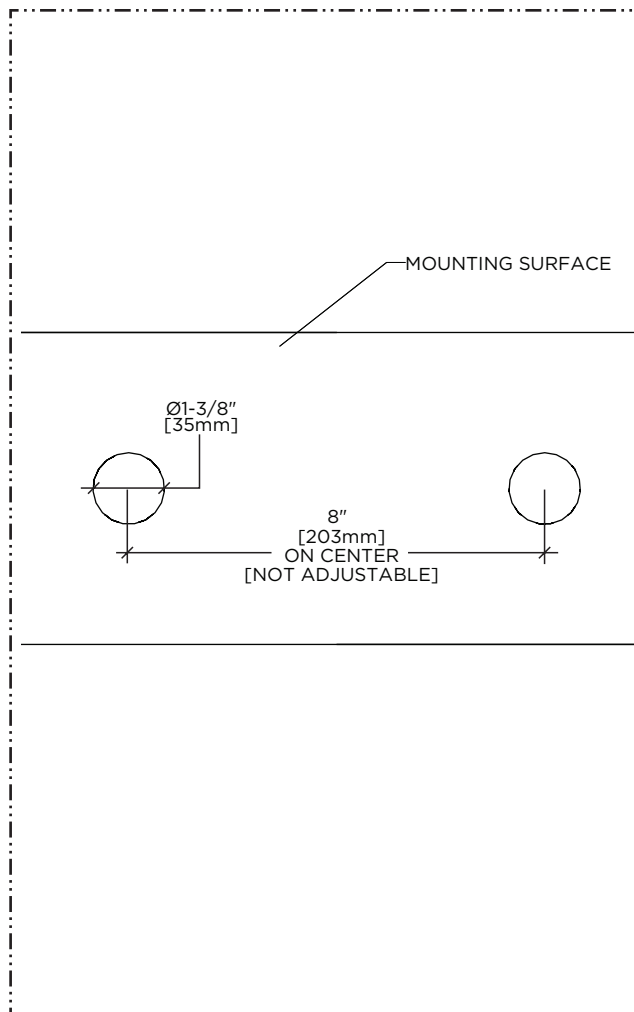

1. Mark and drill 2 holes of Ø1-3/8" [35mm] on the mounting surface with an on-center spread of 8" [203mm].

**NOTE:** On-center spread of the fitting hole is **NOT ADJUSTABLE**.

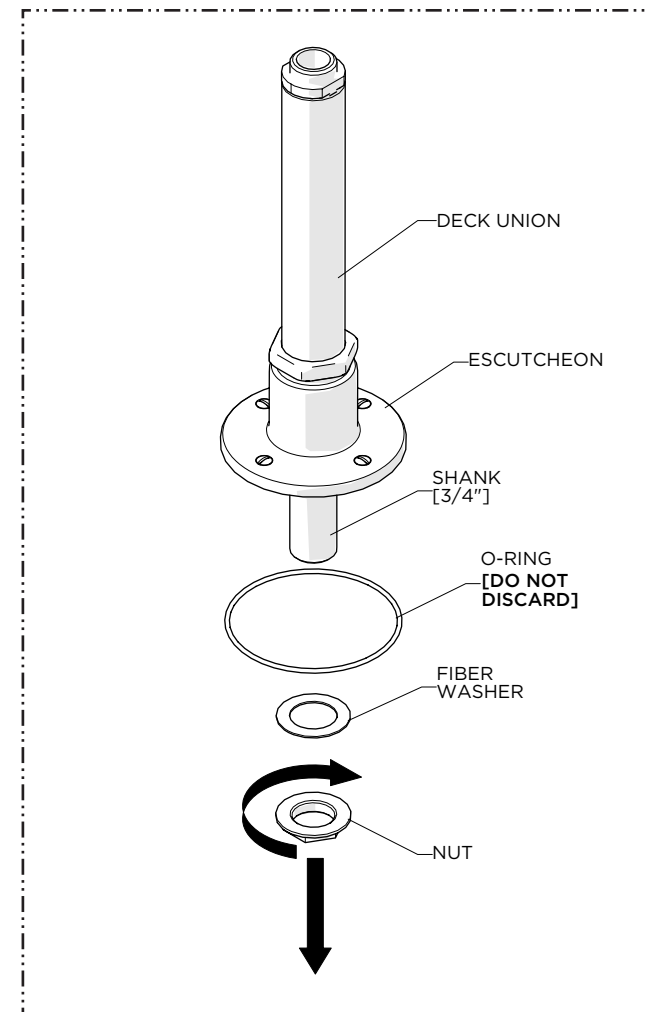

2. Unthread and remove the MOUNTING HARDWARE from the UNIONS.

# INSTALLATION GUIDELINES

## DECK MOUNTED EXPOSED TUB FILLER

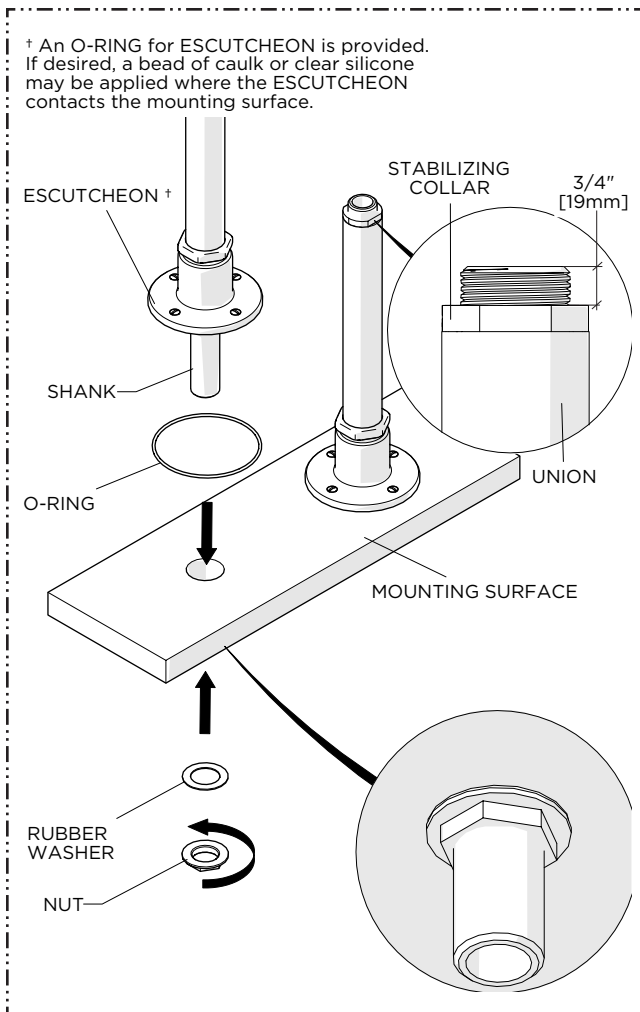

3. Insert the SHANKS into the holes on the MOUNTING SURFACE making sure to use the O-RINGS provided, then re-install the MOUNTING HARDWARE and securely tighten the NUTS.

Verify the UNIONS are level, parallel to each other, and at the proper 8" [203mm] on-center spread then thread and securely tighten the NUTS.

**NOTE:** Make sure the SHANKS project 3/4" [19mm] from the surface of the STABILIZING COLLAR.

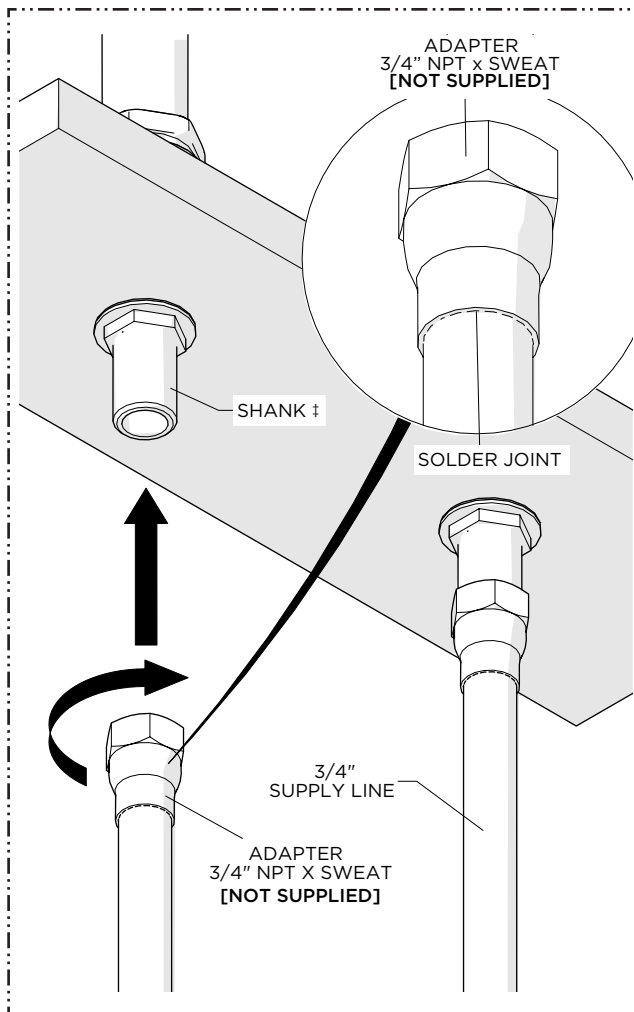

4. Pre-sweat 3/4" NPT x sweat ADAPTERS (not supplied) to the supply lines and let cool.

Apply a thin coat of pipe thread sealant to the NPT threads on the SHANKS then thread and securely tighten the ADAPTERS to the SHANKS.

Adjust the length of each supply line as needed and complete final connections.

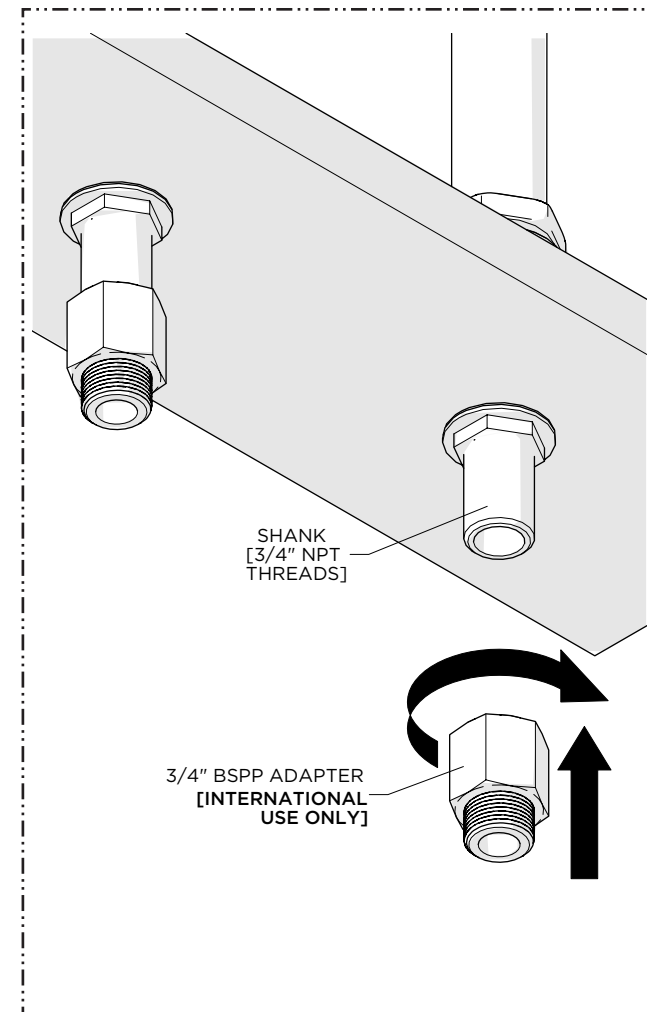

### FOR INTERNATIONAL INSTALLATIONS ONLY:

5. 3/4" female NPT x 3/4" male BSPP ADAPTERS are provided. Thread and securely tighten the ADAPTERS onto the SHANKS.

# INSTALLATION GUIDELINES

## FLOOR MOUNTED EXPOSED TUB FILLER

### TECHNICAL DETAILS:

DETAIL	SPECIFICATION
DIAMETER OF HEAD	Ø2-3/4" [70mm]
FITTING HOLE DIAMETER	Ø1-1/8" [29mm]
HANDLE TURN ANGLE	QUARTER TURN
HANDSHOWER HOSE LENGTH	60" [1525mm]
INLET CONNECTION	3/4" COPPER SWEAT
INLET SUPPLY SPREAD	8" [203mm] <b>(NOT ADJUSTABLE)</b>
INTEGRATED DIVERTER	YES
SPOUT REACH	9-3/4" [248mm]
WATER PRESSURE RANGE	20psi [1.5 bar] <b>MIN</b> 85psi [6.0 bar] <b>MAX</b>
WATER PRESSURE RECOMMENDED	45psi [3.0 bar]

### ROUGH-IN:

- **WARNING:** The inlet supply spread on this product is **NOT** adjustable. If the rough-in is **NOT** accurate it will make the installation difficult or impossible.
- Run well supported 3/4" hot and cold copper supply lines for **MAXIMUM** water flow. The 3/4" supply lines must be:
  - Securely anchored/strapped below sub-floor,
  - Level,
  - Perpendicular to the finished floor,
  - Parallel to each other, and
  - At the proper spread of 8" [203mm].
- Wood blocking is **REQUIRED** and should be no further than 1" from the finished floor for the MOUNTING SCREWS to create adequate support for the TUB FILLER.

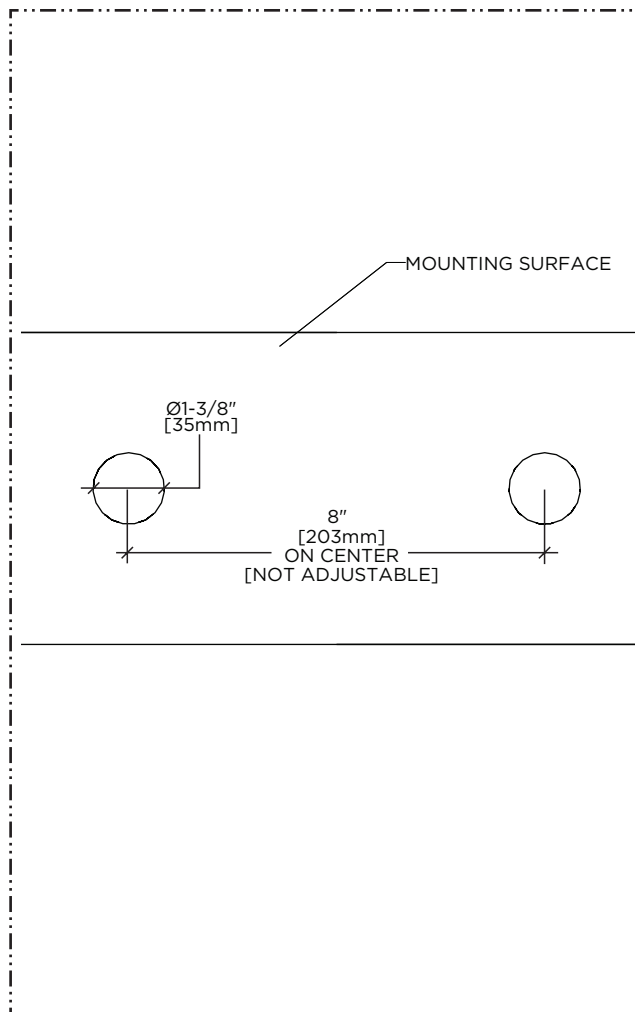

1. Choose the desired location for the TUB FILLER, then mark and drill 2 holes of Ø1-1/8" [29mm] on the finished floor with an on-center spread of 8" [203mm].

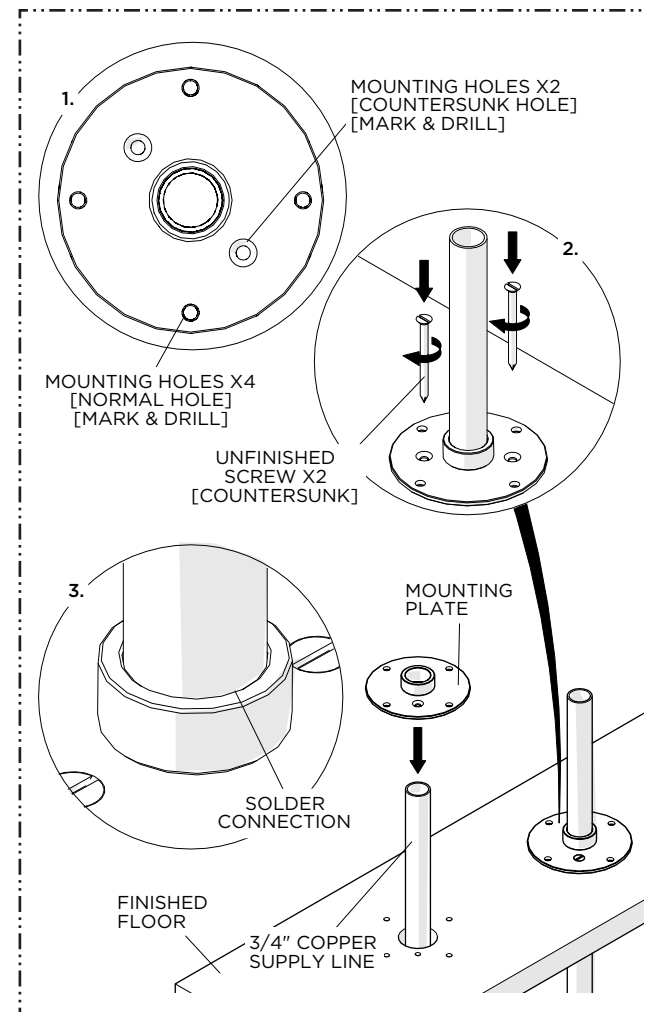

2. Slide the MOUNTING PLATES over the supply lines with the screw holes in the desired orientation.
  - a. Using the 2 countersunk holes on the each PLATE, secure the PLATES using the UNFINISHED SCREWS provided.
  - b. Solder the SUPPLY LINES to the inner diameter of the MOUNTING PLATES to ensure stability.

# INSTALLATION GUIDELINES

## FLOOR MOUNTED EXPOSED TUB FILLER

# WATERWORKS

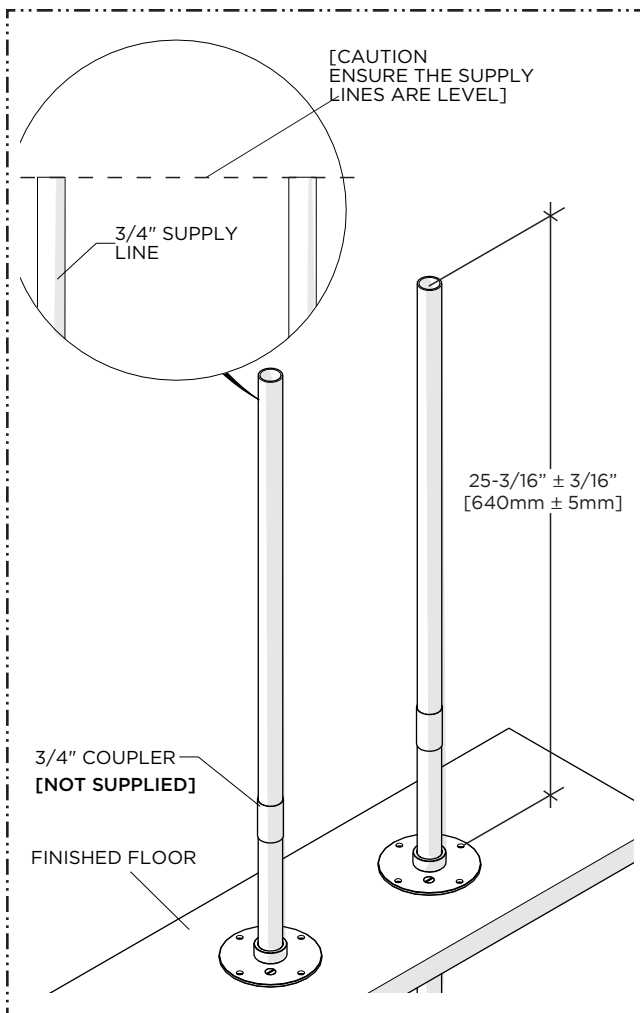

3. Using the 3/4" COUPLERS (not supplied), extend the supply lines to a height of  $25\text{-}\frac{3}{16}" \pm \frac{3}{16}"$  [640mm  $\pm$  5mm] above the finished floor.

**IMPORTANT:** Make sure the cut surfaces are level and free from burrs.

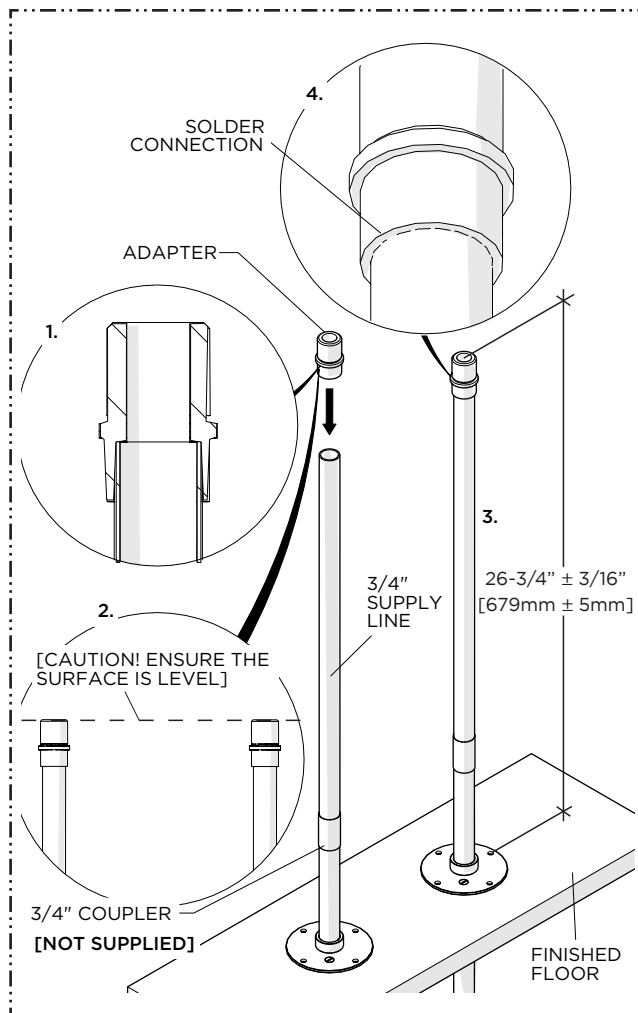

4. Slide the SWEAT ADAPTERS onto the SUPPLY LINES, making sure ADAPTERS seat properly onto the SUPPLY LINES, are level, and at a height of  $26\text{-}\frac{3}{4}" \pm \frac{3}{16}"$  [679mm  $\pm$  5mm] above the finished floor.

Solder the inner diameter of the ADAPTERS to the SUPPLY LINES.

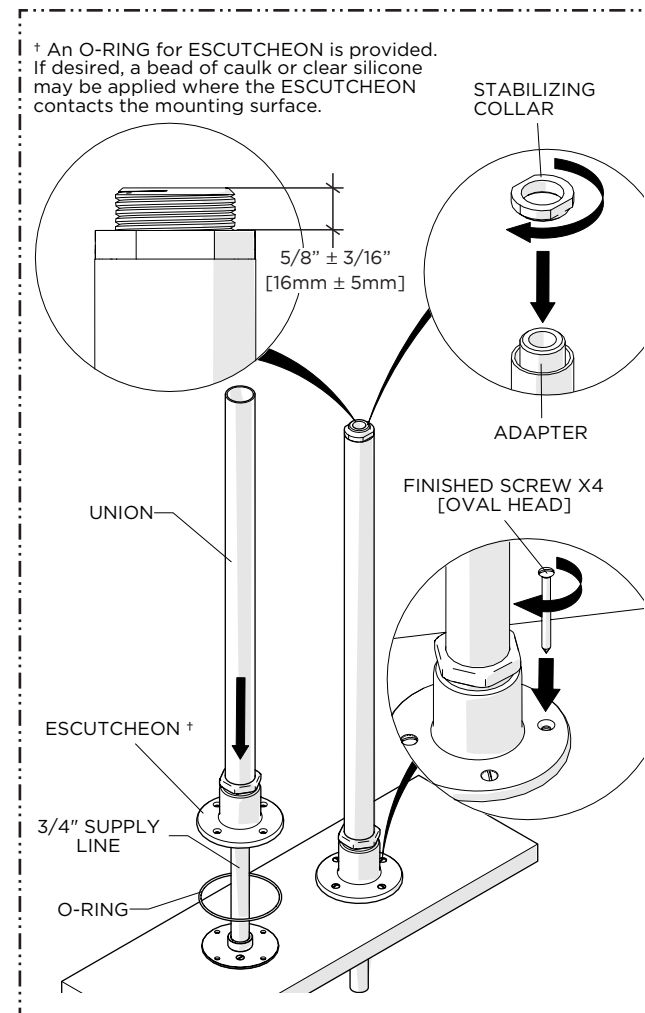

5. Slide the UNIONS over the SUPPLY LINES making sure the UNIONS sit flush on the finished floor and the O-RINGS are beneath the ESCUTCHEONS.

Align the mounting hole on the ESCUTCHEONS with the holes on the MOUNTING PLATES then secure the UNIONS using the FINISHED SCREWS provided.

Thread and securely tighten the STABILIZING COLLARS onto the ADAPTERS until fully seated into the UNIONS.

**NOTE:** The ADAPTERS should protrude  $5\text{-}\frac{8}{8}" \pm \frac{3}{16}"$  [16mm  $\pm$  5mm] past the COLLARS.

# INSTALLATION GUIDELINES

## EXPOSED TUB FILLER

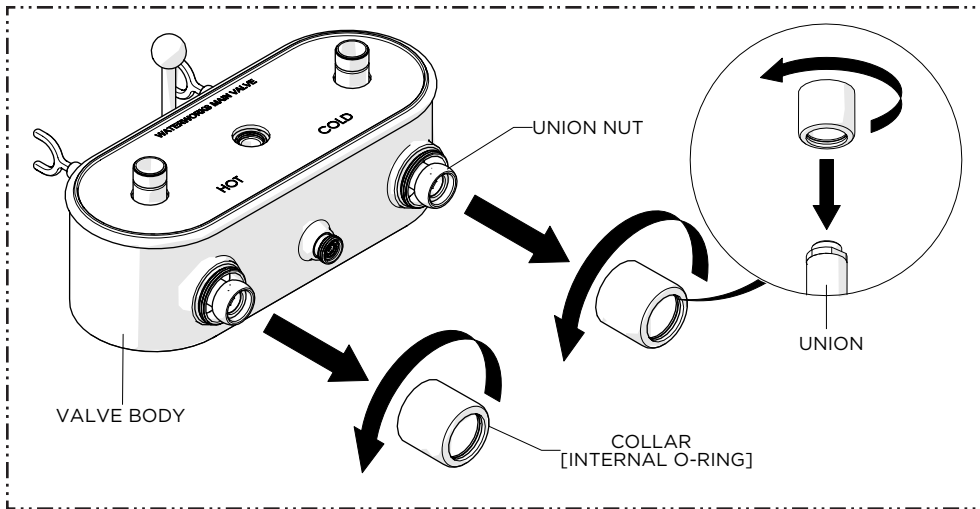

1. Unthread and remove the COLLARS from the VALVE BODY to expose the UNION NUTS, then slide the COLLARS onto the UNIONS making sure the threaded ends are facing up.

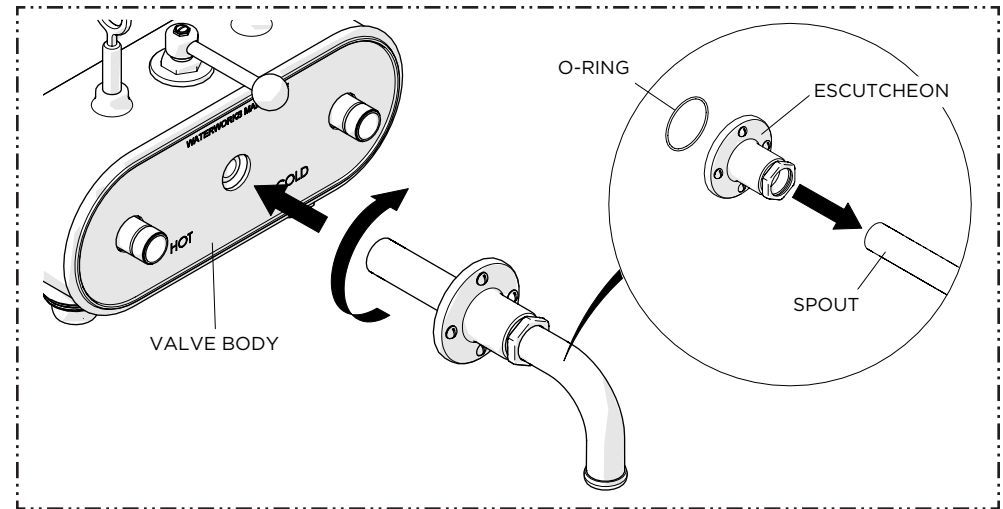

2. Slide the ESCUTCHEON onto the SPOUT making sure to include the O-RING provided, then thread and securely tighten the SPOUT into the VALVE BODY.

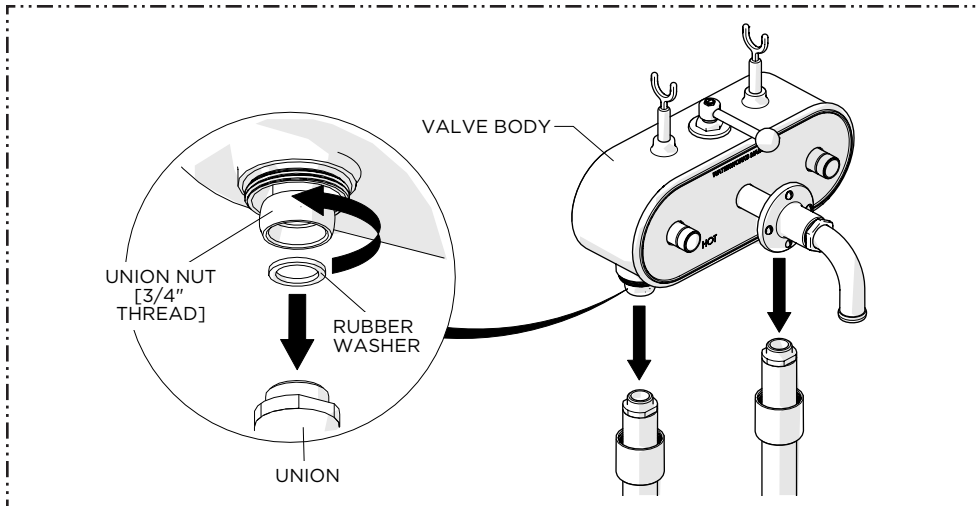

3. Fit the VALVE BODY over the UNIONS and securely tighten the UNION NUT [30mm HEX] onto the UNIONS using the RUBBER WASHERS provided.

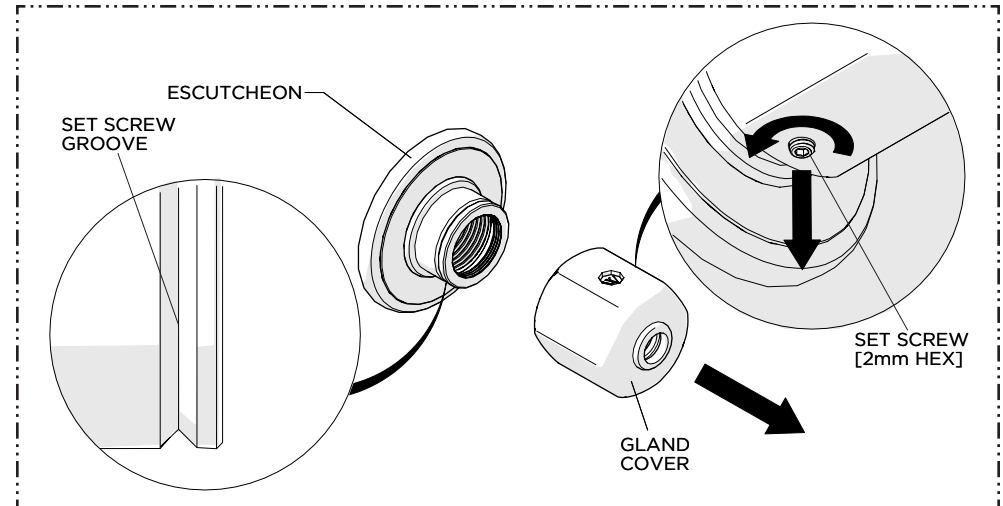

4. Loosen, but Do **NOT** remove the SET SCREW using a 2mm HEX KEY, then remove the GLAND COVER from the ESCUTCHEON.

**IMPORTANT:** The GLAND COVER may be rotated to ensure it is in the desired orientation. Do **NOT** use the GLAND COVER as leverage to install the ESCUTCHEON.

# INSTALLATION GUIDELINES

## EXPOSED TUB FILLER

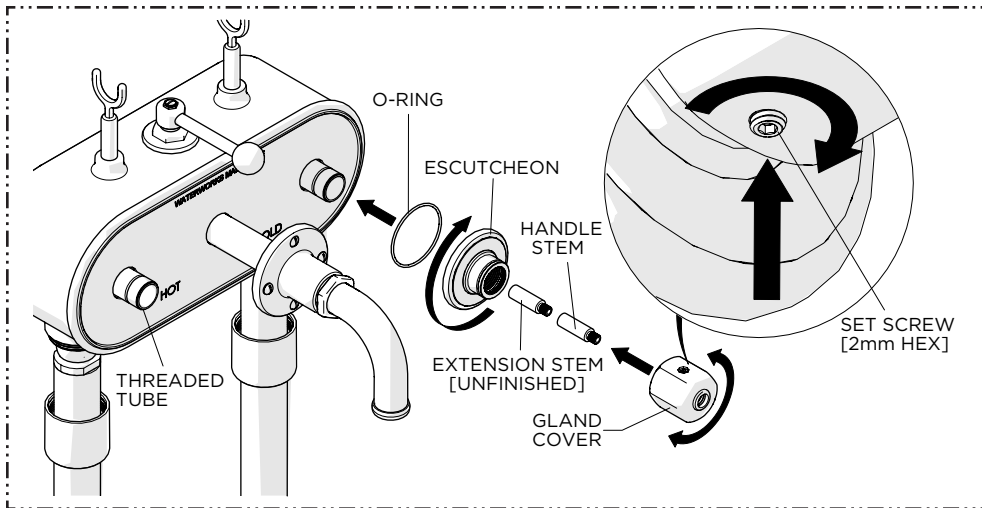

5. Thread the ESCUTCHEON onto the THREADED TUBE making sure to use the O-RING provided.

Insert the EXTENSION and HANDLE STEMS into the TUBE and onto the CARTRIDGE STEM making sure they are fully seated.

Push the GLAND COVER over the STEMS and onto the ESCUTCHEON. Make sure it is fully seated and in the desired orientation then securely tighten the SET SCREW.

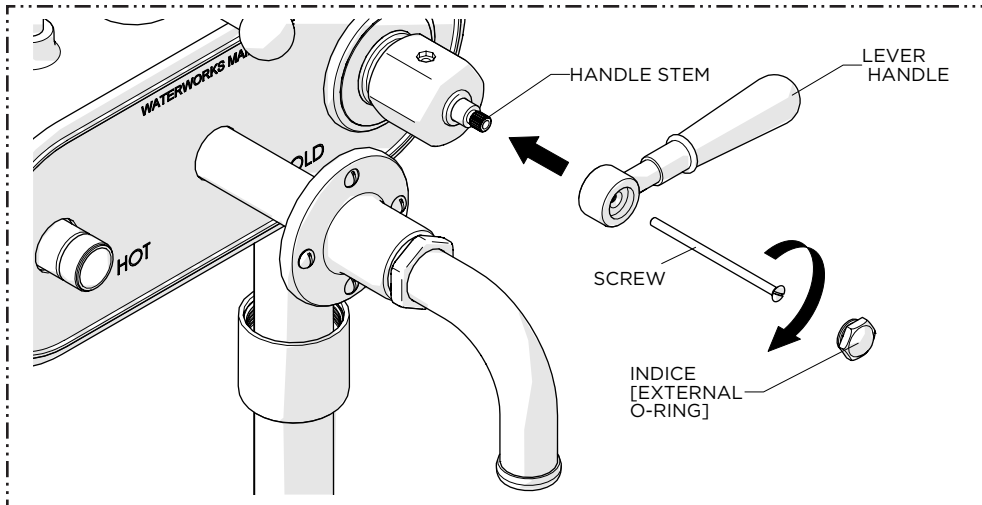

7. RGXT70/71 ONLY: Place the LEVER HANDLE onto the HANDLE STEM in the desired orientation, thread and securely tighten the SCREW then insert the INDICE into the HANDLE.

**NOTE:** Make sure to use the 3-1/8" [80mm] length SCREWS provided.

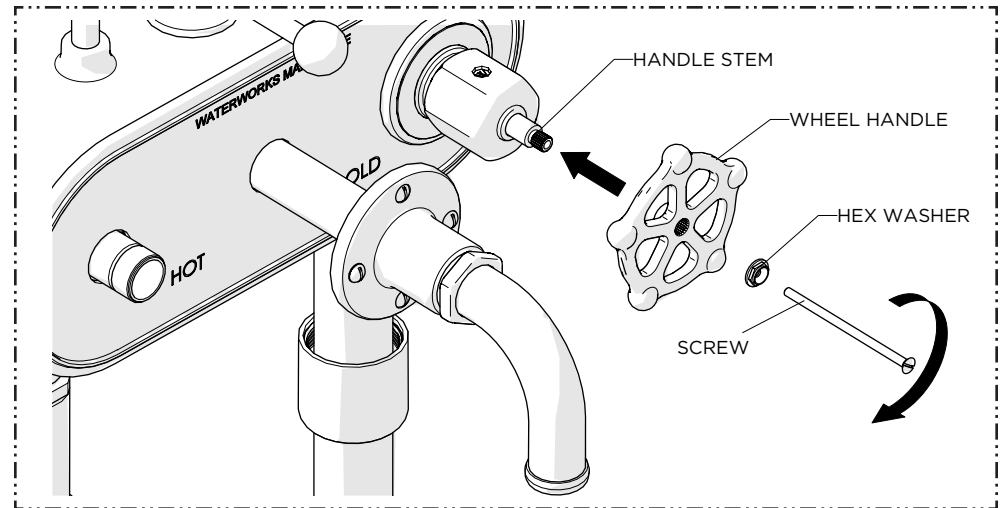

6. RGXT60/61 ONLY: Place the WHEEL HANDLE onto the STEM in the desired orientation then thread and securely tighten the SCREW making sure to include the HEX WASHER provided.

**NOTE:** Make sure to use the 3-1/8" [80mm] length SCREWS provided.

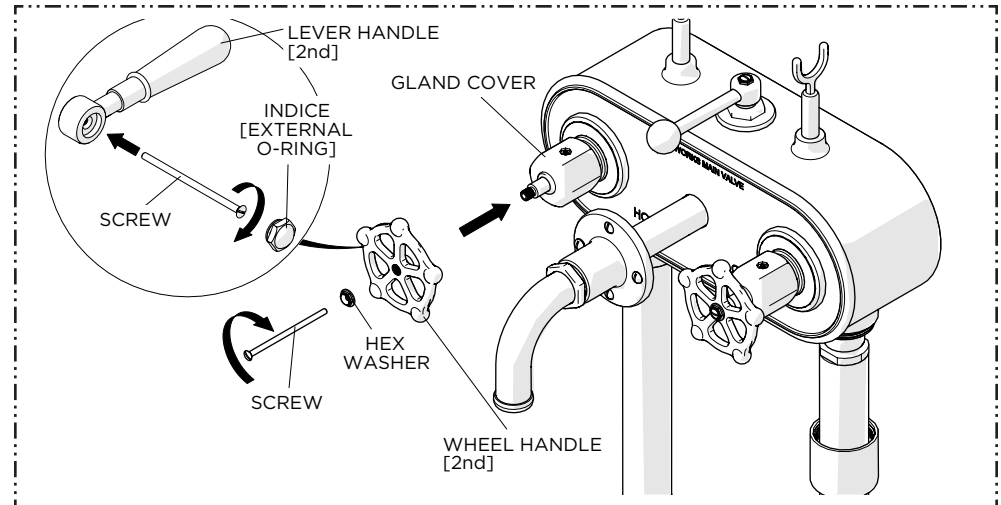

8. Repeat STEPS 4 - 7 to install the second [2nd] WHEEL or LEVER HANDLE.

# INSTALLATION GUIDELINES

## EXPOSED TUB FILLER

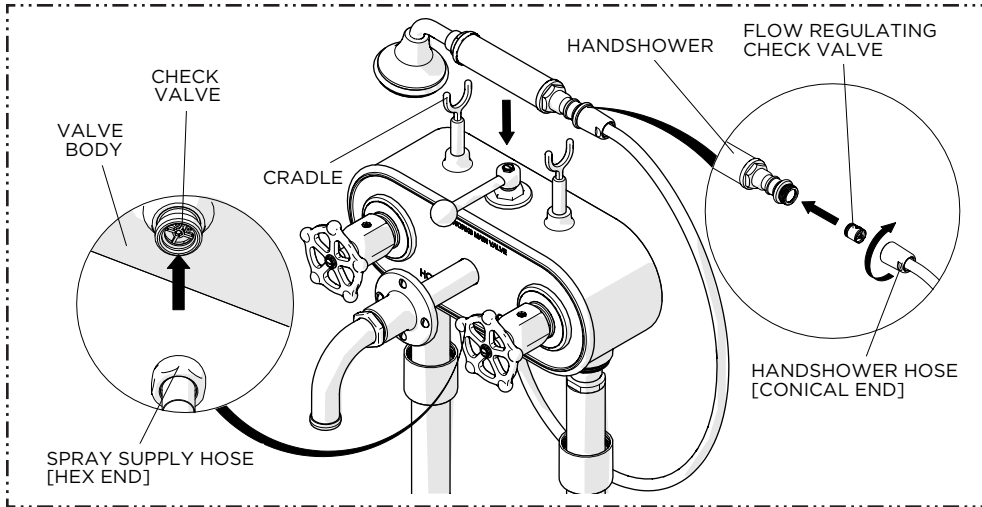

9. Thread and securely tighten the CONICAL END of the HOSE to the HANDSHOWER and HEX END of the HOSE onto the VALVE BODY, then place the HANDSHOWER over the CRADLE on the VALVE BODY.

**NOTE:** A FLOW REGULATING CHECK VALVE is located inside the inlet of HANDSHOWER.

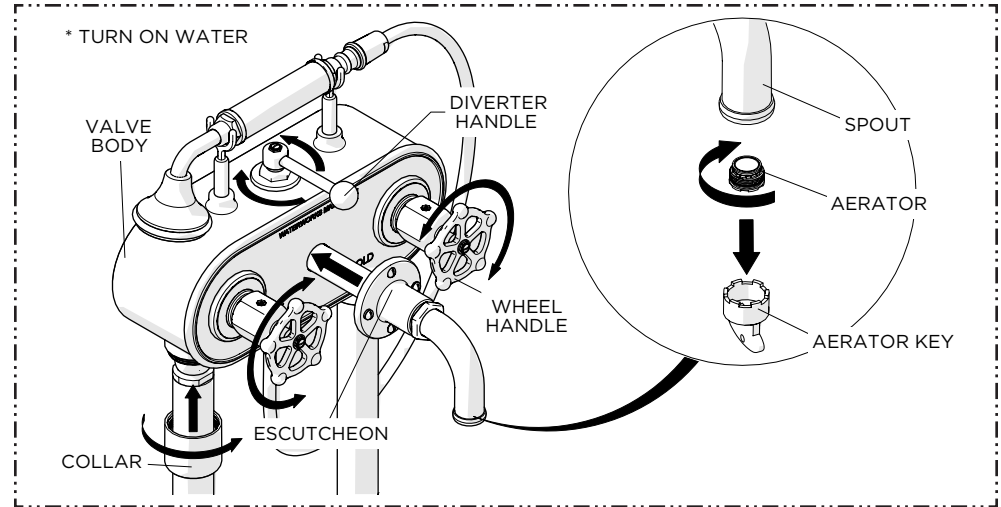

10. Remove the AERATOR from the SPOUT using the AERATOR KEY provided, then turn on the water and operate the HANDLES and DIVERTER HANDLE to flush out any debris in the supply line to ensure they function properly. Inspect all connections for leaks, then thread and securely tighten the COLLAR onto the VALVE BODY and slide the ESCUTCHEON down the SPOUT. Turn off the water and re-install the AERATOR.

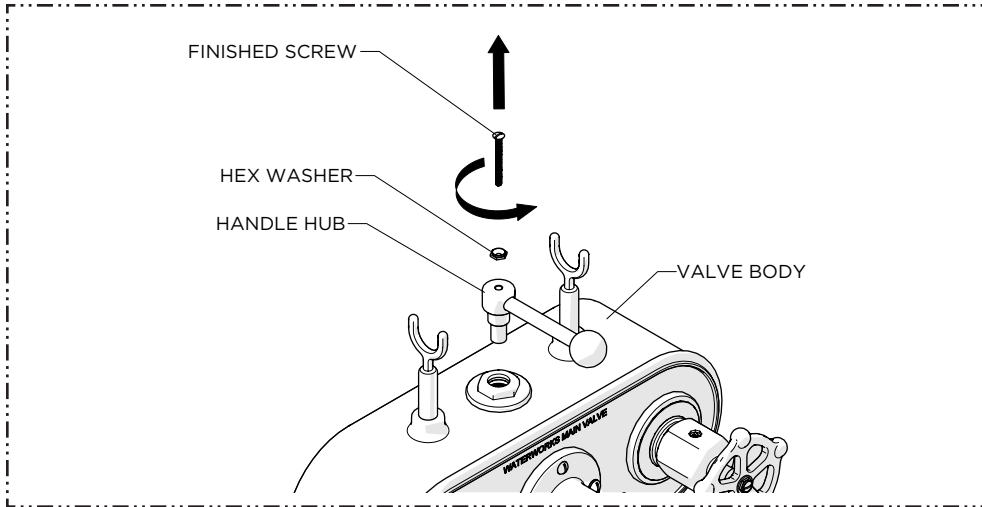

### SERVICING THE DIVERTER:

1. Unthread and remove the FINISHED SCREW, HEX WASHER, and HANDLE HUB from the VALVE BODY.

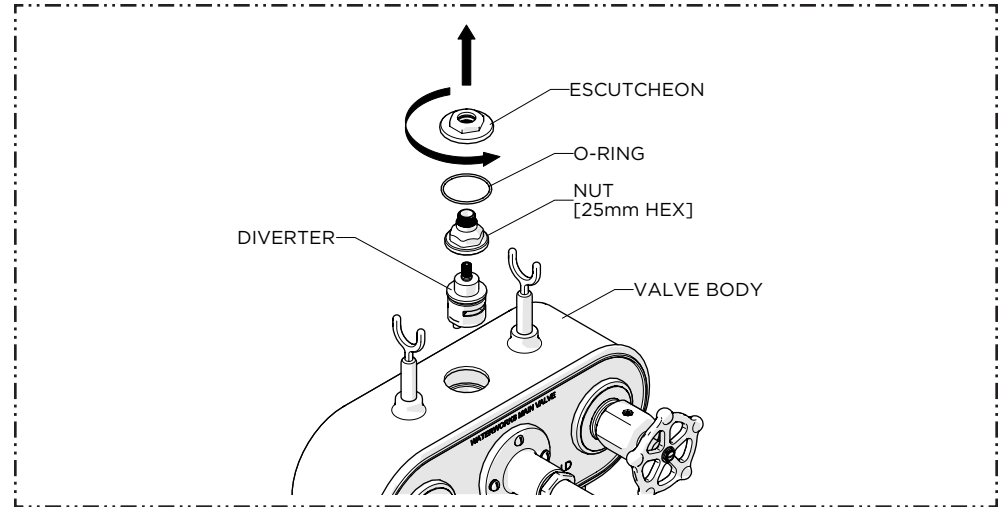

2. Remove the ESCUTCHEON and NUT [25mm HEX] from the VALVE BODY. Remove the DIVERTER.