

# INSTALLATION GUIDELINES

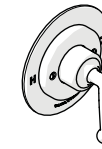

STYLE No. DSPB10

Dash Pressure Balance Control Valve Trim with Metal Lever Handle

## IMPORTANT:

- To ensure this product is installed properly, you must read and follow these guidelines.
- The owner/user of this product must keep this information for future reference.
- This product is intended to work with the Waterworks Universal Pressure Balance Valve (Style No. **GUPB81**). The VALVE controls on/off and mixes hot and cold water but can also be paired with a Waterworks Universal Two Way (Style No. **GUDV23**) or Three Way (Style No. **GUDV65**) Diverter Valve. **ALL VALVES AND TRIMS SOLD SEPARATELY.**
- **WARNING:** The risk of scalding exists until the installer has properly calibrated/adjusted the temperature setting during final trim installation.
- This product must be installed by a professional licensed contractor and must be onsite prior to rough-in, this allows the installer to visualize the installation.
- Be sure your installation conforms to federal, state, and local codes. In the State of Massachusetts, all installations must comply with the rules and regulations set forth within 248 CMR.
- The bottom outlet of the **GUPB81** is intended for use with a diverting tub spout only,
- Do **NOT** use Pex piping from the VALVE to the tub spout. It will create too much back pressure and cause the VALVE to malfunction.
- Inspect this product to ensure you have all the parts required for proper installation. Product is sold partially assembled but shown fully disassembled for illustrative and service purposes only.
- Use only a strap wrench or protected/smooth-jaw wrench on any finished surface.
- The use of certain plumber's putty may stain stone or tile surfaces.
- If further assistance is required, please contact Product Support at 1-800-927-2120 Monday through Friday, 8am - 6pm EST.
- Refer to the separate Service Parts Documents for available replacement parts.

## CARE AND MAINTENANCE:

- If this product will remain unused for an extended period of time (over 3 months), then the water to the VALVE should be shut off (via service stops or system control valve) and the VALVE should be opened to allow the water in the VALVE to evaporate. This is to keep the PISTON in the CARTRIDGE from sticking, due to stagnant or hard water, once the VALVE is in use again. If the piston does stick, soak the CARTRIDGE in household vinegar. Refer to the Installation Guidelines for the **GUPB81** for maintenance instructions, complete parts breakdown and related information.
- **WINTERIZE:** If this product will remain unused during the **WINTER** months then the water to the VALVE should be shut off (via service stops or system control valve) and the CARTRIDGE should be removed and replaced with the FLUSH PLATE. Refer to the Installation Guidelines for the **GUPB81** for instructions on how to properly remove and re-install the CARTRIDGE.

## REQUIRED PLUMBING DETAILS:

- Universal Pressure Balance Valve
- **STYLE No.** GUPB81

## ROUGH-IN AND VALVE PREPARATION:

- **CAUTION:** Make sure the supply lines are flushed prior to final trim installation using the FLUSH PLATE provided with the VALVE. Refer to the Installation Guidelines provided with the VALVE for complete rough-in, flushing, and CARTRIDGE installation details.

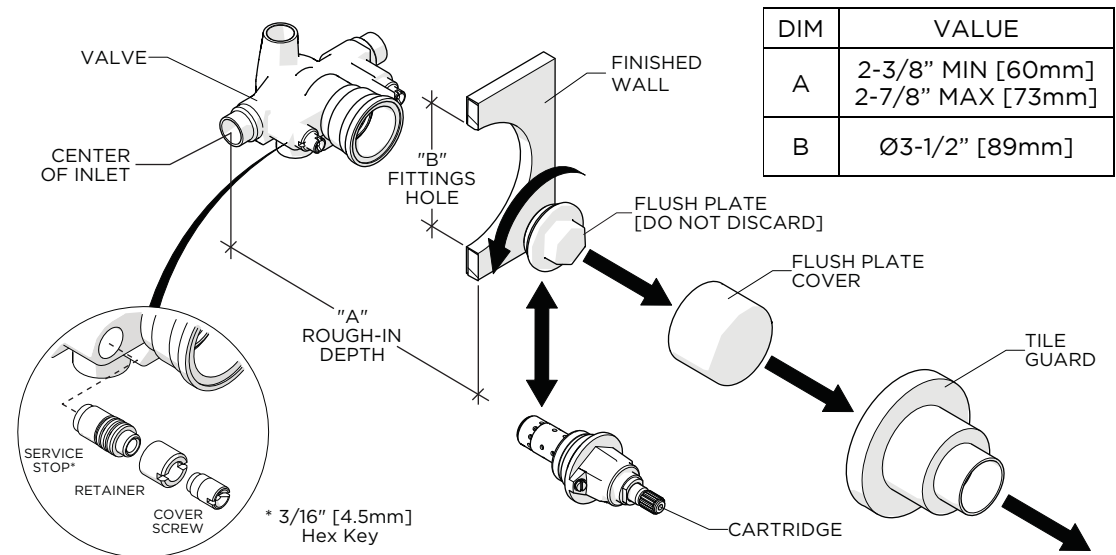

# WATERWORKS

## INSTALLATION GUIDELINES

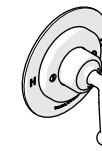

STYLE No. DSPB10

Dash Pressure Balance Control Valve Trim with Metal Lever Handle

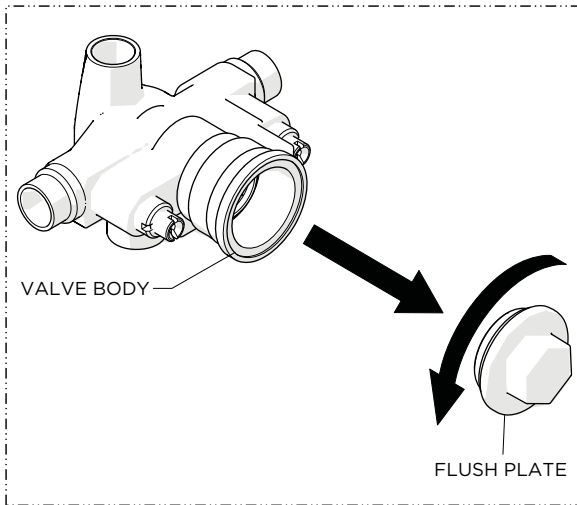

1. Remove the FLUSH PLATE.

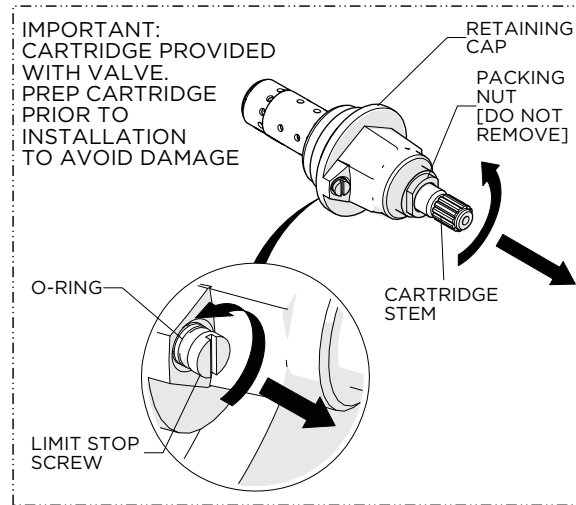

2. **IMPORTANT:** Back out the LIMIT STOP SCREW until the O-RING is fully exposed, ensure the CARTRIDGE is drawn close to the RETAINING CAP, and the PACKING and NUT are left in place.

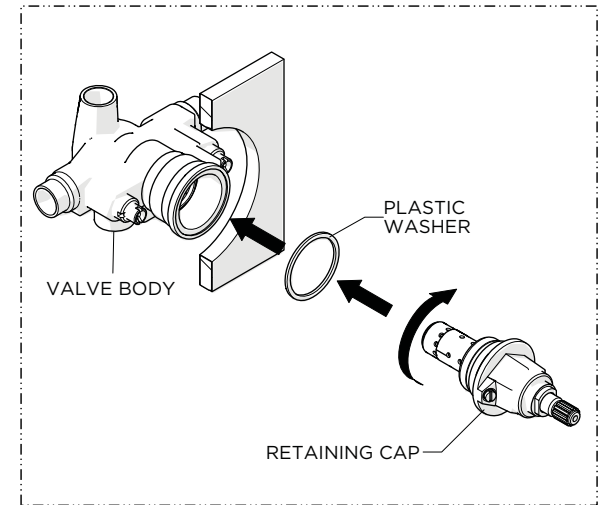

3. Insert the CARTRIDGE into the VALVE then thread and securely tighten the RETAINING CAP making sure to use the PLASTIC WASHER provided.

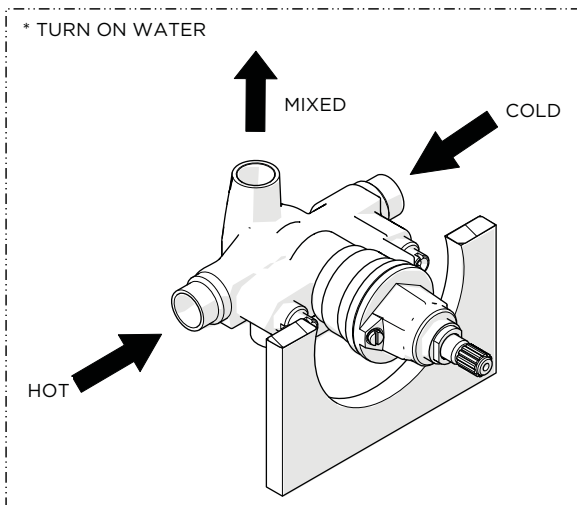

4. Turn on the hot and cold supplies. The VALVE will not operate unless both hot and cold supplies are turned on.

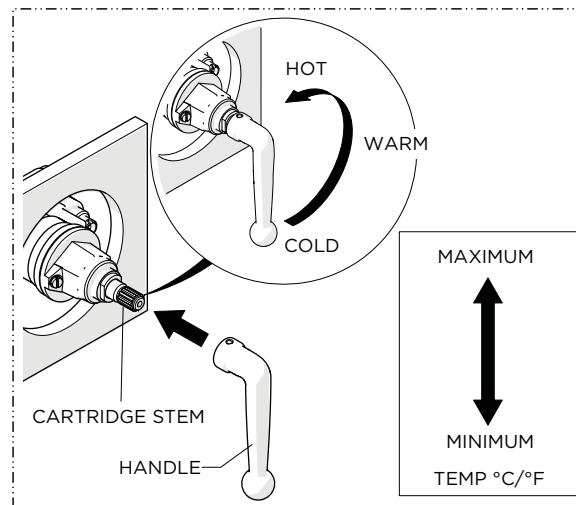

5. With the VALVE off, place the HANDLE on the CARTIRDGE STEM in the 6 o'clock position then turn the HANDLE counterclockwise through the cold, warm, and stopping at the hot position.

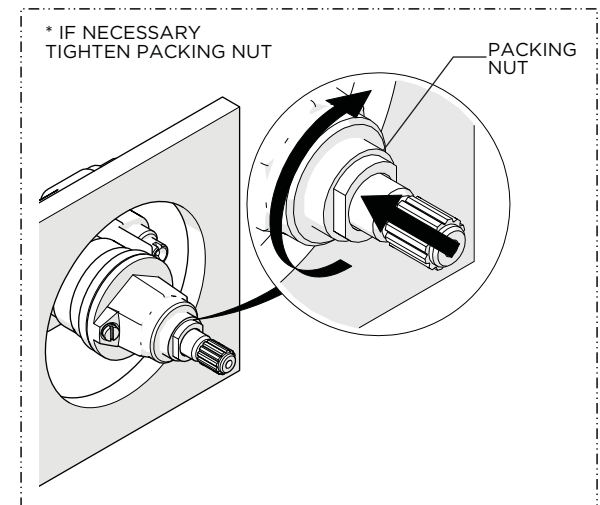

6. If additional rotational friction is required to maintain the HANDLE position, tighten the PACKING NUT.

**NOTE:** The HANDLE is for controlling on/off and temperature only, not volume.

# WATERWORKS

## INSTALLATION GUIDELINES

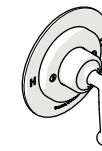

STYLE No. DSPB10

Dash Pressure Balance Control Valve Trim with Metal Lever Handle

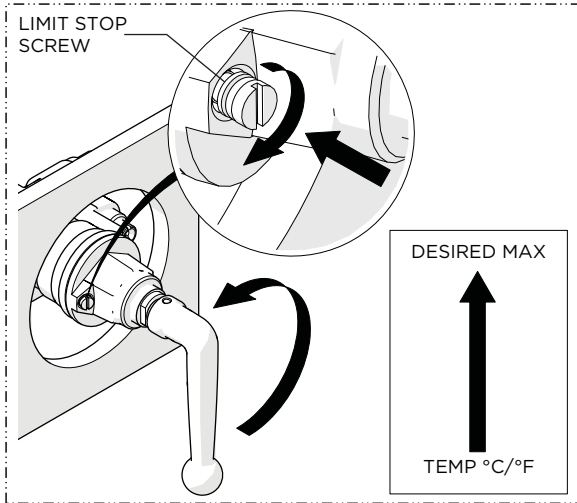

7. Open the VALVE to the **maximum** desired bathing temperature verified with a thermometer then turn the LIMIT STOP SCREW clockwise until it seats. Turn the VALVE off then on and verify the temperature.

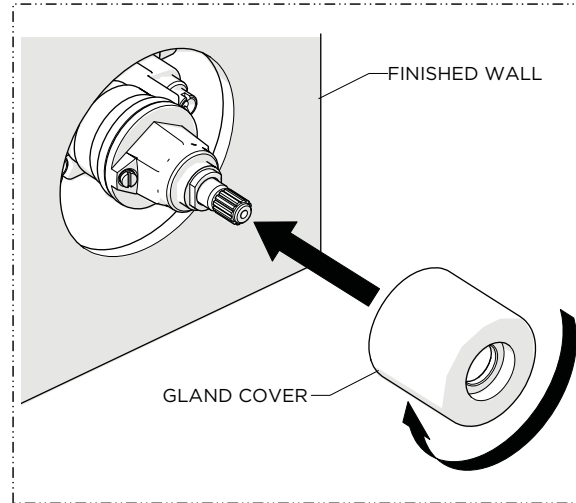
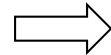

8. Thread and securely tighten the GLAND COVER onto the VALVE.

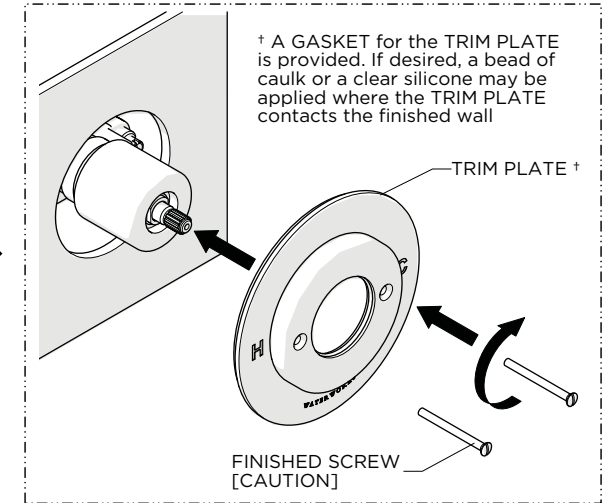
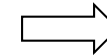

9. Slide the TRIM PLATE over the GLAND COVER then thread and securely tighten the SCREWS.

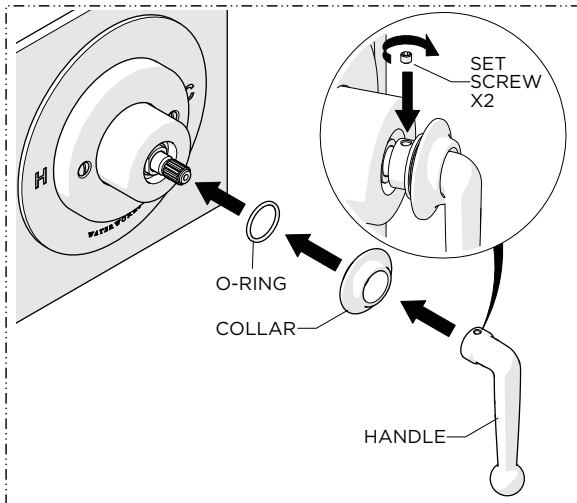

10. Slide the COLLAR and the O-RING over the base of the HANDLE then attach the HANDLE to the CARTRIDGE STEM and tighten the SET SCREWS.

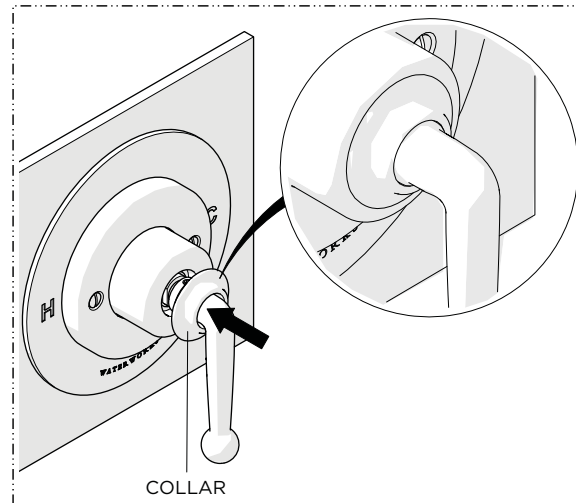
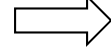

11. Slide the COLLAR against the GLAND COVER to conceal the SET SCREWS. The O-RING will hold the COLLAR in place.

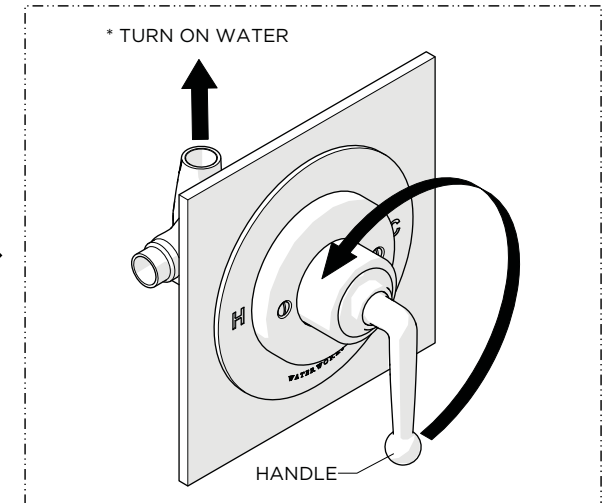
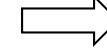

12. Turn on the water and operate the HANDLE to ensure it is functioning properly.