

Modern Carrara Washstand
WWSLAB500
 Modern Danby Washstand
WWSLAB501

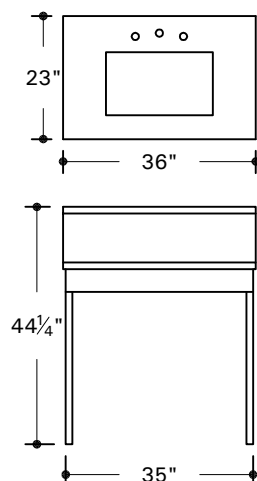

Carrara without Backsplash
WWSLAB500WOB
 Danby without Backsplash
WWSLAB501WOB

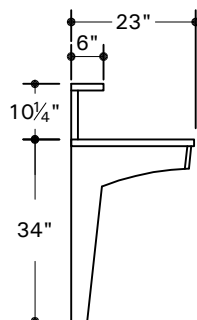

Traditional Carrara Washstand
WWSLAB505
 Traditional Danby Washstand
WWSLAB506

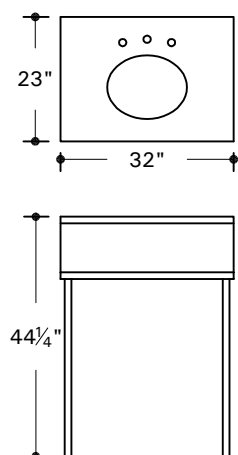

Carrara without Backsplash
WWSLAB505WOB
 Danby without Backsplash
WWSLAB506WOB

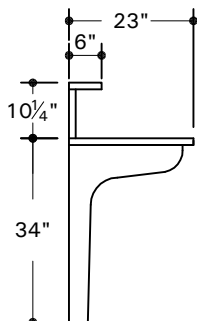

IMPORTANT

- To ensure this product is installed properly, you must read and follow these guidelines.
- The owner/user of this product must keep this information for future reference.
- Blocking to properly secure the washstand is mandatory.
- The slab top is natural stone that has not been sealed. Oil based products, including plumbers putty must never be used under any circumstances on natural stone.

- Be sure your installation conforms to applicable codes.
- Inspect this product to assure you have all parts required for proper installation. The assembly is supplied with a brass slab support and adjoining bolts.

ROUGH IN:

1. REQUIRED: a 2x6 on its side for blocking in the wall is mandatory to adequately secure the washstand and top. Width of blocking should be a minimum of 32" wide and centered 33" above the surface of the finished floor.

SLAB AND LEG INSTALLATION:

2. Position the left leg in the proper location and make a mark where the leg pin contacts the floor. Drill a 3/8" diameter hole in the floor for the pin to rest in.
3. Attach the slab support between the 2 legs using the hardware provided.
4. Reposition the washstand legs and slab support to the proper location and make a mark where the pin on the right leg contacts the floor. Drill a 3/8" diameter hole in the floor for the pin to rest in. It is recommended that the legs are secured to the floor using water based silicone.
5. Verify that the washstand components are level and plumb then secure the slab support to the wall using the 4 screws provided.
6. Apply water based silicone to the top of each leg and the slab support. Place the slab down onto the legs and slab support and wipe away any excess silicone.

BACKSPLASH/SHELF INSTALLATION .

7. After the silicone securing the top has cured, silicone the backsplash to the wall and top and apply a bead of silicone where the shelf meets the wall.

If further assistance is required, please contact Product Support at 1-800-927-2120 (8am-7pm EST).

These guidelines have been prepared for the professional contractor to aid in the installation of:
MODERN WASHSTAND (WWSLAB500 & WWSLAB501) and **TRADITIONAL WASHSTAND (WWSLAB505 & WWSLAB506)** all dimensions are based on original specification and are subject to change and variation. Please consult your Design Associate for current specifications.

W A T E R W O R K S