

## WATERWORKS

PRODUCT SUPPORT  
800.927.2120  
WATERWORKS.COM

# BELVEDERE

Drop In / Undermount Oval Bathtub with  
Slip Resistance 70" x 35" x 21" Center Drain  
in Unpainted

**STYLE No.** BVBT20

**REFERENCE No.** WWBT20DS

**ITEM No.** 13-86819-66049

## SPECIFICATIONS

PAGE 1 OF 3

### DESIGN

Traditional quality and care merges with contemporary design in our Belvedere bathtub

### FEATURES

Impeccable Victorian production methods create the dignified shape of this cast iron tub.

Architectural details like the comfortable flat lip and unadorned feet articulate the tub's modern aspirations.

This tub comes with a slip resistant option.



SHOWN IN White Enamel

## WATERWORKS

PRODUCT SUPPORT  
800.927.2120  
WATERWORKS.COM

# BELVEDERE

Drop In / Undermount Oval Bathtub with  
Slip Resistance 70" x 35" x 21" Center Drain  
in Unpainted

**STYLE No.** BVBT20

**REFERENCE No.** WWBT20DS

**ITEM No.** 13-86819-66049

## SPECIFICATIONS

PAGE 2 OF 3

*All dimensions are based on original specifications and are subject to change and variation. Please consult your Design Associate for current specifications.*

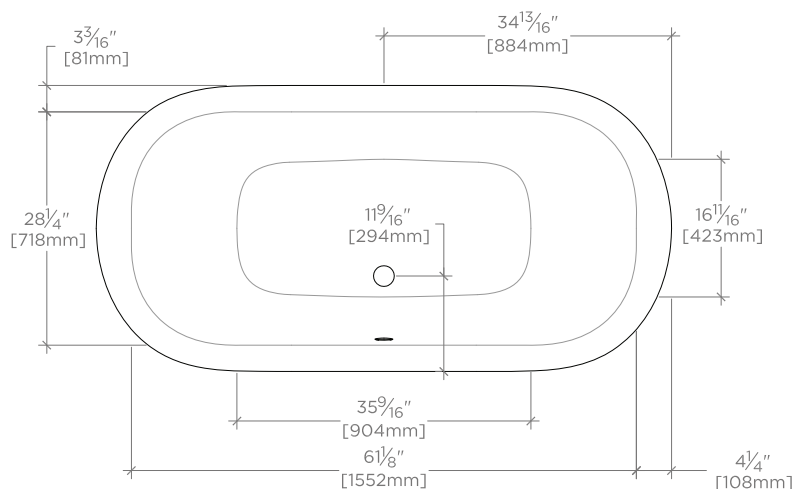

TOP VIEW

SCALE: 1/2"=1'-0"

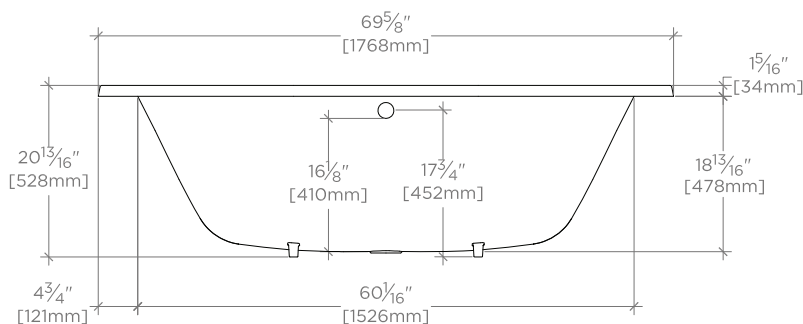

SIDE VIEW

SCALE: 1/2"=1'-0"

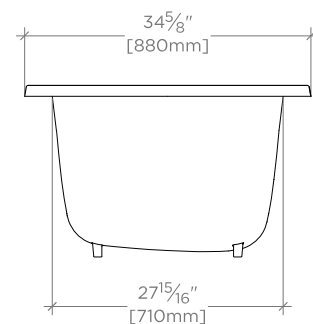

END VIEW

SCALE: 1/2"=1'-0"

## WATERWORKS

PRODUCT SUPPORT  
800.927.2120  
WATERWORKS.COM

# BELVEDERE

Drop In / Undermount Oval Bathtub with  
Slip Resistance 70" x 35" x 21" Center Drain  
in Unpainted

**STYLE No.** BVBT20  
**REFERENCE No.** WWBT20DS  
**ITEM No.** 13-86819-66049

**SPECIFICATIONS**  
PAGE 3 OF 3

### SPECIFICATIONS

Primary Material: Cast Iron  
ADA Compliance: No  
Adjustable Levelers / Feet:  
Bathing Type: Bathing, Soaking and Shower-  
ing  
Bottom Angle / Pitch: 4 Deg  
Depth to Overflow:  
Dimension Tolerance:  
Drain Hole Depth:  
Drain Hole Diameter:  
Drilling Option: Whirlpool Drilling  
Electric Requirements:  
Installation Type: Freestanding  
Overflow Hole Depth:  
Overflow Hole Diameter:  
Required Electrical Feeds:  
Safety Warnings:  
Single or Double Ended: Double Ended  
Slip Resistance: Yes  
Voltage:  
Water Capacity: 80 gal  
Whirlpool / Air Motor Location:

### CARE INSTRUCTIONS

Wash surfaces gently with a soft damp cloth;  
use a neutral liquid soap with water for daily  
cleaning, dry any overspray.

### CODES AND STANDARDS

ASME A112.19.1M, CSA B45, State of MA

### REQUIRED PLUMBING DETAILS

Below is a list of choices that must be  
made to complete your lavatory faucet.