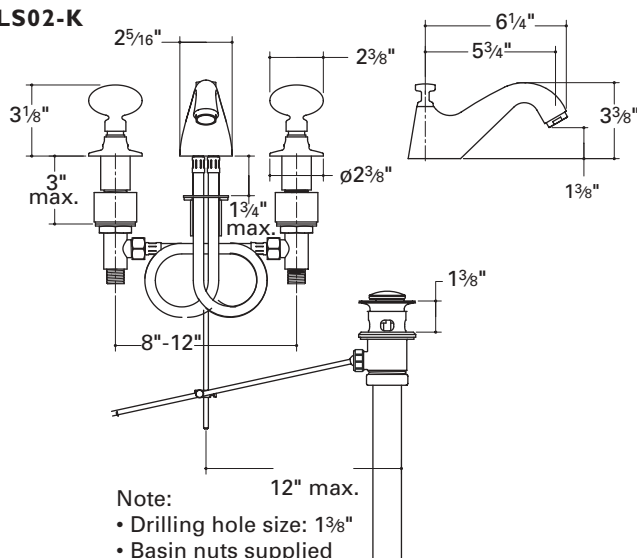

OPLS02-K**NOTES**

- Use only a protected, smooth-jawed, or strap wrench on any finished surface.
- If possible, install this faucet assembly on the lavatory before setting.
- DO NOT use putty on deck fittings. Upper gaskets are provided.

INSTALLATION

- To remove the handle trim from the handle trim connector; unscrew the escutcheon and pull off the handle and escutcheon together. Then, unscrew and lift off handle trim connector. Leave locking nut, gaskets, and plastic spacer in place on the valve body (see fig. 1).
- Insert the valve body through the mounting hole, using the plastic spacer (used for deck surfaces less than 1 1/2" thick) if needed. Then, screw the handle trim connector onto the valve body until fully seated. Next, tighten the bottom locking nut to secure the valve to the deck. Repeat for the other valve assembly. (see fig. 1)
- Re-attach the handle trims to the handle trim connector:
- Unscrew the locking barrel nuts at the base of the spout to release the mounting plate and gasket. Then, insert the spout through the mounting hole and secure by re-attaching and tightening the locking barrel nuts.

- Install the flexible supply hoses between the valve bodies and the spout assembly.

INSTALLING THE POP-UP DRAIN (SEE FIG.2)

- Remove the upper collar from the pop-up drain assembly and discard the upper gasket.
- Set the upper collar in the lavatory drain opening using a clear adhesive silicone.
- Re-attach the lower drain assembly using the gasket provided. Tighten until fully secured and the side connector is facing towards the wall (A clear adhesive silicone may be used to ensure a water-tight seal between the gasket and the lavatory).
- Remove the knurled nut from the side connection of lower drain assembly. Then insert the horizontal pivot rod and re-attach the knurled nut.
- Insert vertical lift rod through the spout assembly and connect to the horizontal pivot rod, using the linkage provided (if necessary, the rods may be field cut).
- To adjust the height of the drain stopper turn the adjustment screw at the base of the stopper and tighten the locking nut upward to secure.
- Attach the flanged tailpiece to the lower drain assembly using the gasket provided. Then the tailpiece to the p-trap.
- Using the basin nuts provided, attach the water supply to the hot and cold valve bodies.
- Open supply valves and check all inlet valve connections for leaks.
- After installation, unscrew and remove the aerator assembly. Carefully open the hot and cold valves fully to flush out any debris in the supply lines. Now check all connections for leaks. After the lines have been flushed, close the valves and reinstall the aerator assembly.
- If further assistance is required, please contact Product Support at: 1-800-927-2120 (8AM-7PM EST).

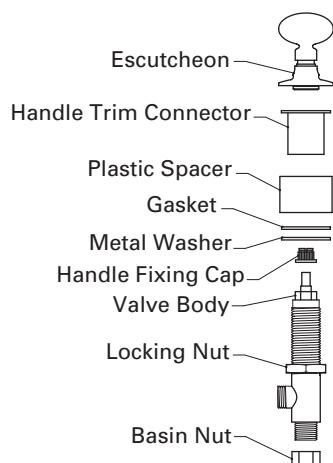
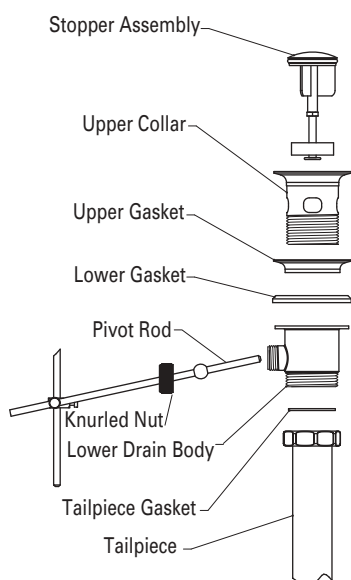
Figure 1**Figure 2**

These guidelines have been prepared for the professional contractor to aid in the installation of:
OPUS LAVATORY FAUCET WITH EGG CRYSTAL HANDLE (OPLS02-K)

11/02

All dimensions are based on original specifications and are subject to change and variation.
 Please consult your Design Associate for current specifications.

W A T E R W O R K S®