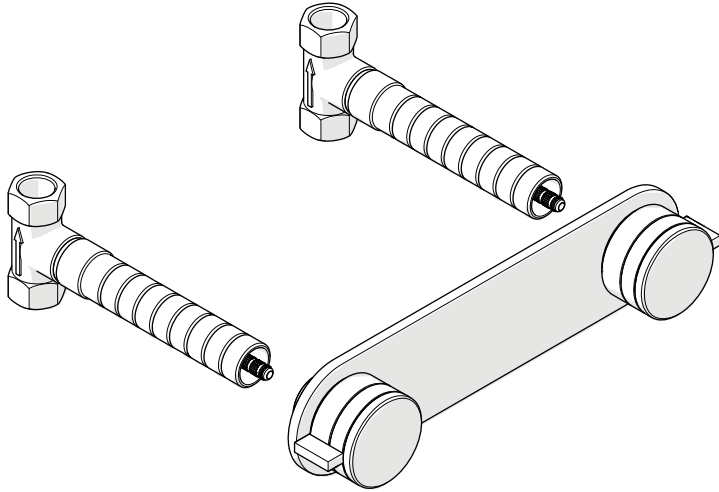

STYLE No. DBVC20, DB20VC†

**DBVC20 INCLUDES:**

- Decibel Dual Volume Control Valve Trim with Metal Knob Handles
  - **STYLE No. DBVC2C**
- Universal 1/2" Counter-Clockwise Open Volume Control Valve
  - **STYLE No. GUV18**
- Universal 1/2" Clockwise Open Volume Control Valve
  - **STYLE No. GUV19**

**DB20VC† INCLUDES:**

- Decibel Dual Volume Control Valve Trim with Metal Knob Handles
  - **STYLE No. DBVC2C**
- Universal 1/2" Counter-Clockwise Open Volume Control Valve
  - **STYLE No. GU18VC†**
- Universal 1/2" Clockwise Open Volume Control Valve
  - **STYLE No. GU19VC†**

**SPECIFICATIONS:**

Control Valve Rough-in Depth Minimum: 2-3/8" [67mm]  
 Control Valve Rough-in Depth Maximum: 6-1/8" [162mm]  
 Fittings Hole Diameter: Ø1-3/8" [35mm]  
 Handle Spread: 8" [203mm] (NOT ADJUSTABLE)  
 Inlet/Outlet Connection: 1/2" Female NPT†  
 Unrestricted Maximum Flow Rate per Valve:  
     6gpm at 45psi [23 L/min at 3.0 bar]  
 Water Pressure: 20psi [1.5 bar] MIN - 85psi [6.0 bar] MAX  
 Water Pressure Recommended: 45psi [3.0 bar]

† UK Style No. **DB20VC** is supplied with 2 **BSPP ADAPTERS** for each **VOLUME CONTROL VALVE**. The **ADAPTERS** are packaged separately and assembly is required.

- Inlet/Outlet Connection: 1/2" Female BSPP

**IMPORTANT:**

- To ensure this product is installed properly, you must read and follow these guidelines.
- The owner/user of this product must keep this information for future reference.
- This product must be installed by a professional licensed contractor and must be on-site prior to rough-in. This allows the installer to visualize the installation and verify the 8" center spread.
- Be sure your installation conforms to all federal, state, and local codes. In the State of Massachusetts, all installations must comply with the rules and regulations set forth within 248 CMR.
- Refer to the specification and assembly drawings attached. Product is sold partially assembled but shown fully disassembled for illustrative and service purposes only.
- Inspect the product to ensure you have all the parts required for proper installation.
- Use only a strap wrench or protected/smooth-jaw wrench on any finished surface.
- The use of certain plumber's putty may stain stone or tile surfaces.

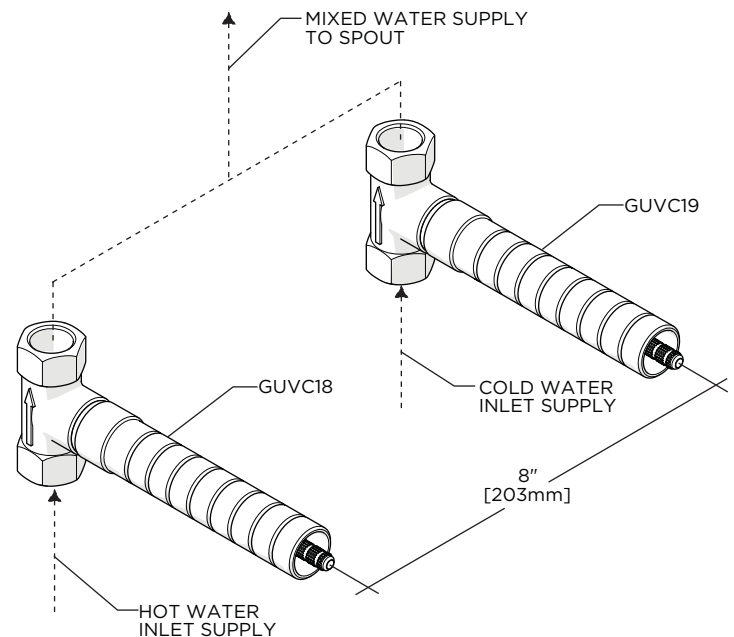
**VALVE OPERATION FOR TUB SPOUT:****FIGURE - 01**

(DRAWING IS NOT A PLUMBING SCHEMATIC)

- This product also works as part of the Decibel Floor Mounted Tub Spout and Dual Volume Control Trim with Metal Knob Handles (STYLE No. **DBTS90**)

These guidelines have been prepared for the professional contractor to aid in the installation of:  
**DECIBEL LOW PROFILE THREE HOLE WALL MOUNTED LAVATORY FAUCET WITH METAL KNOB HANDLES AND VALVES (STYLE No. DBVC20, DB20VC)**  
 All dimensions are based on original specification and are subject to change and variation.  
 Please consult your Design Associate for current specifications.

**WATERWORKS**  
STUDIO

- VOLUME CONTROL VALVES control on, off and volume. They do NOT mix hot and cold water.
- A VOLUME CONTROL VALVE must be installed for each water supply line: hot and cold. This product includes 2 VALVES that must be installed at an 8" [203mm] on-center spread.
- Final connections from the VALVES to the SPOUT provided with DBTS90 are the responsibility of the installer.

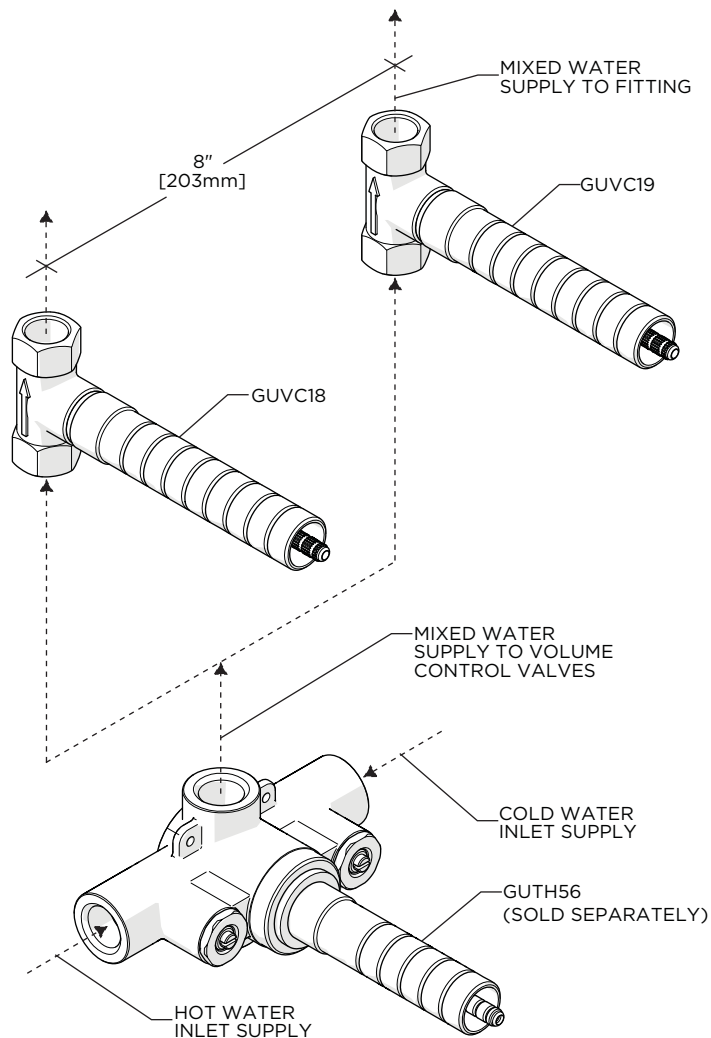
**VALVE OPERATION FOR SHOWER SYSTEM:****FIGURE - 02**

(DRAWING IS NOT A PLUMBING SCHEMATIC)

- VOLUME CONTROL VALVES control on, off and volume. They do NOT mix hot and cold water.
- Mixed water flows from the Waterworks Universal 1/2" Thermostatic Valve (Style No. **GUTH56** - SOLD SEPARATELY) to the VOLUME CONTROL VALVES. Refer to the Installation Guidelines for the Thermostatic Valve which contains related installation information.

- A VOLUME CONTROL VALVE must be installed for each fitting that will have water flowing to it. This product includes 2 VALVES that must be installed at an 8" [203mm] on-center spread.
- All connections between all VALVES and fittings are the responsibility of the installer.

**TRIM INSTALLATION:**

1. Remove the TILE GUARDS and the O-RINGS from the VALVES as shown below.

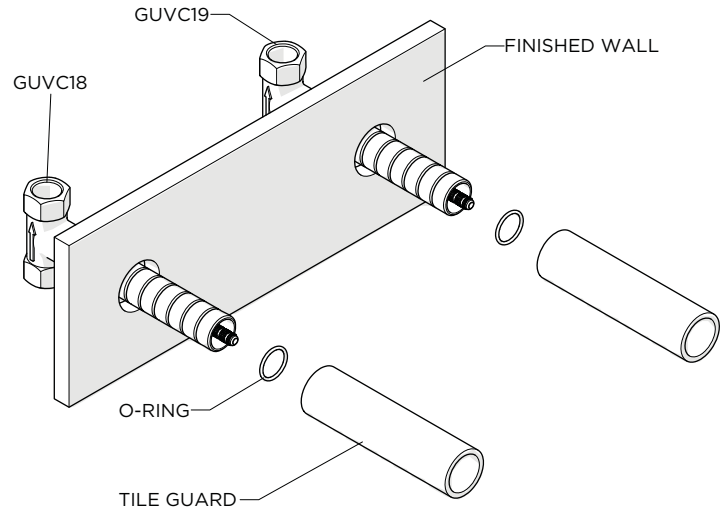
**FIGURE - 03**

- See Figure - 04 for Steps 2 - 4.

DIM	VALUE
A	1/4" [6mm]
B	1/4" [6mm]

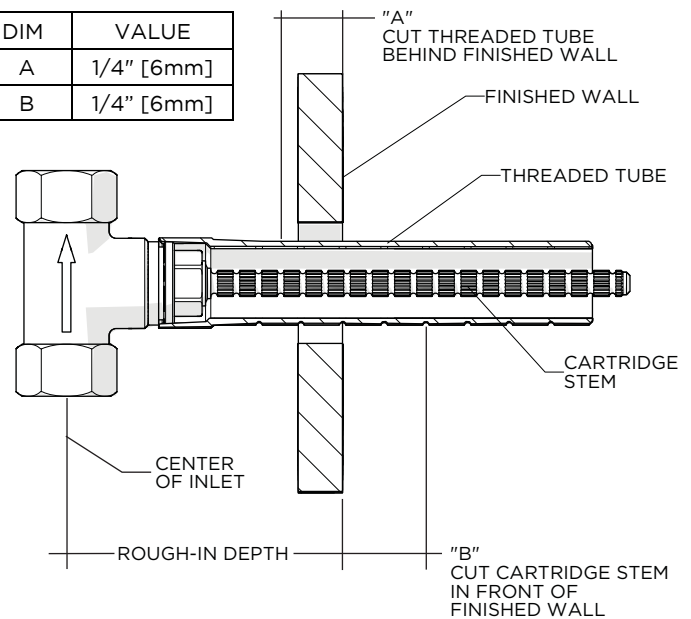
**FIGURE - 04**

2. Mark the THREADED TUBES as shown then remove and cut the TUBES.
3. Mark the CARTRIDGE STEMS as shown then remove the CARTRIDGES and cut the STEMS.

These guidelines have been prepared for the professional contractor to aid in the installation of:  
**DECIBEL LOW PROFILE THREE HOLE WALL MOUNTED LAVATORY FAUCET WITH METAL KNOB HANDLES AND VALVES (STYLE No. DBVC20, DB20VC)**

All dimensions are based on original specification and are subject to change and variation.  
 Please consult your Design Associate for current specifications.

**WATERWORKS**  
 STUDIO

4. Thread and securely tighten the CARTRIDGES into the VALVES and then thread the TUBES back onto the CARTRIDGES.

➤ See Figure - 05 for Steps 5 - 6.

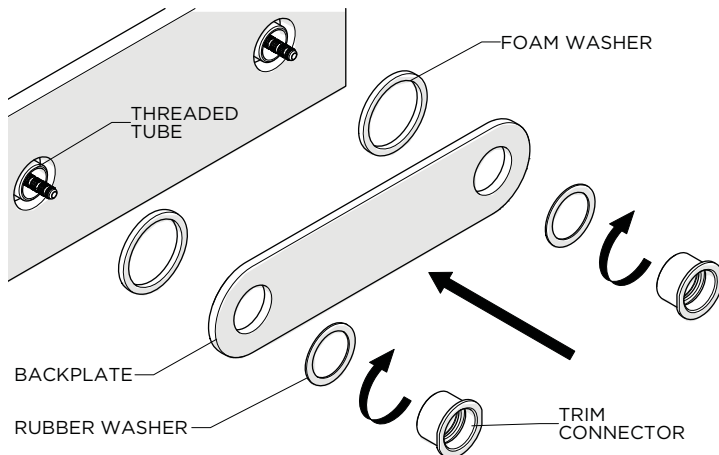

FIGURE - 05

5. Attach the FOAM WASHERS to the BACKPLATE and hold it against the finished wall.

**NOTE:** If desired, a bead of caulk or a clear silicone may be applied where the BACKPLATE contacts the finished wall. The use of certain plumber's putty may stain stone or tile surfaces.

6. Thread the TRIM CONNECTORS onto the THREADED TUBES making sure to include the RUBBER WASHERS and securely tighten.

➤ See Figure - 06 for Steps 7 - 10.

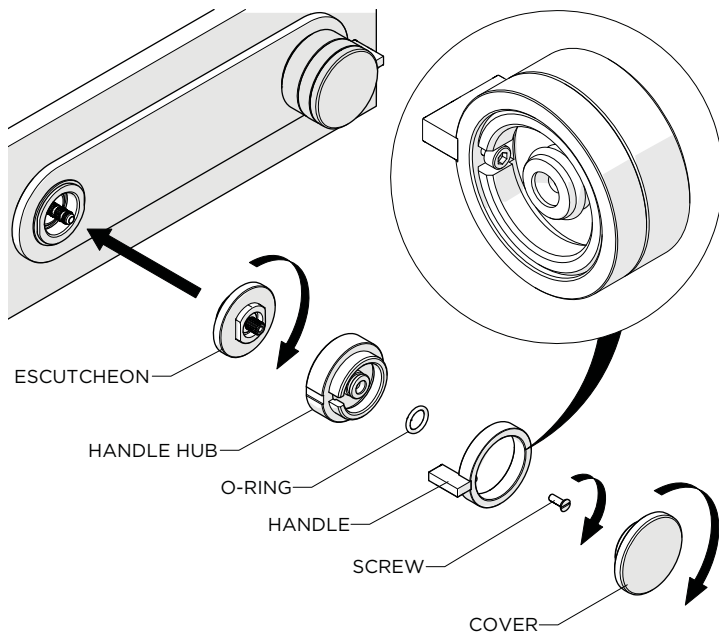

FIGURE - 06

7. Thread the ESCUTCHEON into the TRIM CONNECTOR. Make sure the HANDLE STEM aligns properly with the CARTRIDGE STEM and the ESCUTCHEON is fully threaded down. Securely tighten using a 20mm wrench.
8. Place the HANDLE HUB onto the HANDLE STEM in the desired orientation then thread the SCREW into the HUB and securely tighten.
9. Place the HANDLE over the HUB making sure it fits properly inside the notched portion then thread the COVER into the HUB and securely tighten.
10. Repeat Step 7 - 9 to install the second HANDLE.

#### INSPECT AND FINISH THE INSTALLATION:

11. Turn on the water supply and operate both HANDLES to ensure they are functioning properly.
- If further assistance is required, please contact Product Support at 1-800-927-2120 Monday through Friday, 8am - 6pm EST.
- Refer to the separate Service Parts Documents for available replacement parts.

These guidelines have been prepared for the professional contractor to aid in the installation of:  
**DECIBEL LOW PROFILE THREE HOLE WALL MOUNTED LAVATORY FAUCET WITH METAL KNOB HANDLES AND VALVES (STYLE No. DBVC20, DB20VC)**  
 All dimensions are based on original specification and are subject to change and variation.  
 Please consult your Design Associate for current specifications.

**WATERWORKS**  
 STUDIO