

**STYLE No. DBXT20**  
Exposed Wall Mounted Tub Filler with Handshower

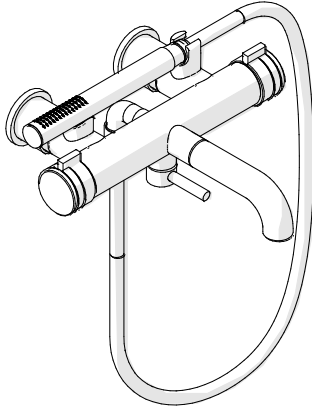

**SPECIFICATIONS:**

Handle Spread: 10-7/16" (NOT ADJUSTABLE)  
Inlet Connection Size: 3/4"  
Inlet Connection Type: Female NPT  
Inlet Connection Spread: 5-7/8" (NOT ADJUSTABLE)  
Maximum Water Pressure: 80psi  
Minimum Water Pressure: 20psi  
Recommended Water Pressure: 45psi  
Restricted Maximum Flow Rate: 2.0gpm [7.6L/min]<sup>†</sup>  
Fittings Hole Diameter: 1-3/8"  
Spout Reach: 10-3/4" MIN - 11-1/4" MAX (finished wall to center of outlet)

<sup>†</sup> Only the HANDSHOWER has a restricted flow rate.

**IMPORTANT:**

- To ensure this product is installed properly, you must read and follow these guidelines.
- The owner/user of this product must keep this information for future reference.
- Be sure your installation conforms to federal state, and local codes. Anti-scald protection is the responsibility of the installer and according to applicable codes.
- In the State of Massachusetts, all installation must comply with the rules and regulations set forth within 248CMR.
- This product must be installed by a professional licensed contractor.
- Product should be on-site prior to rough-in. This allows the installer to visualize the installation and verify the inlet connection spread.
- Check tub measurements to assure the spout projects far enough into the tub.
- Inspect this product to ensure you have all parts required for proper installation.

- Use only a strap wrench or protected/smooth-jaw wrench on any finished surface.
- Run 3/4" supply lines for maximum flow.
- Install accessible hot and cold service stop valve to facilitate servicing.

**ROUGH-IN:**

1. Run well supported 3/4" hot and cold supply lines for maximum water flow.
2. Install 3/4" NPT nipples (NOT SUPPLIED). Ensure that the nipples are secure, level, at the proper spread of 5-7/8" (NOT ADJUSTABLE) and at equal depths. The final distance the nipples must project from the surface of the finished wall must be between 1-3/8" and 1-7/8". See Figure - 02.

**TUB FILLER INSTALLATION:**

**IMPORTANT:**

- Verify the 5-7/8" inlet supply spread prior to installation.
- 3. Slide the GLAND COVERS and ESCUTCHEONS down the posts on the valve body then unthread the COLLARS to expose the UNION NUTS. See Figure - 01.

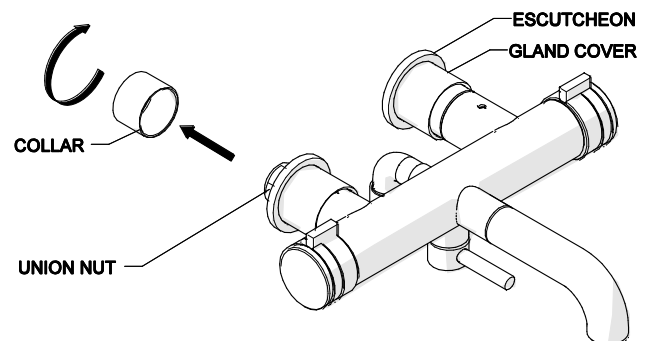

FIGURE - 01

- 4. Slide the collars onto the nipples. See Figure - 02A.

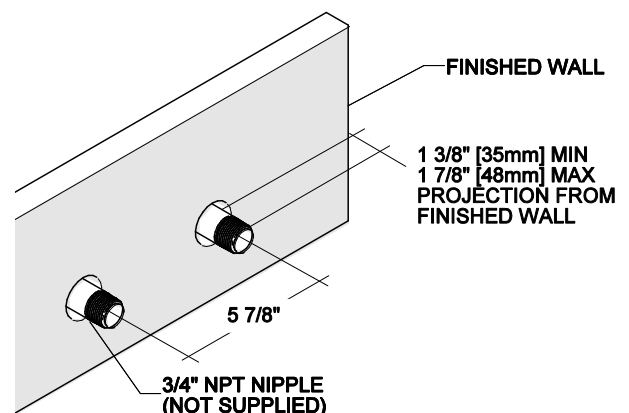

FIGURE - 02

These guidelines have been prepared for the professional contractor to aid in the installation of:  
**DECIBEL WALL MOUNTED EXPOSED TUB FILLER WITH METAL KNOB HANDLE AND HANDSHOWER (STYLE No. DBXT20)**  
All dimensions are based on original specification and are subject to change and variation.  
Please consult your Design Associate for current specifications.

**WATERWORKS**  
STUDIO

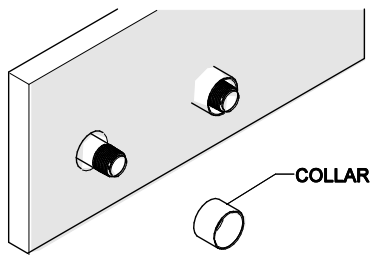

FIGURE - 02A

5. Thread the union nuts on to the nipples making sure that a washer is inside each nut. See Figure - 03.

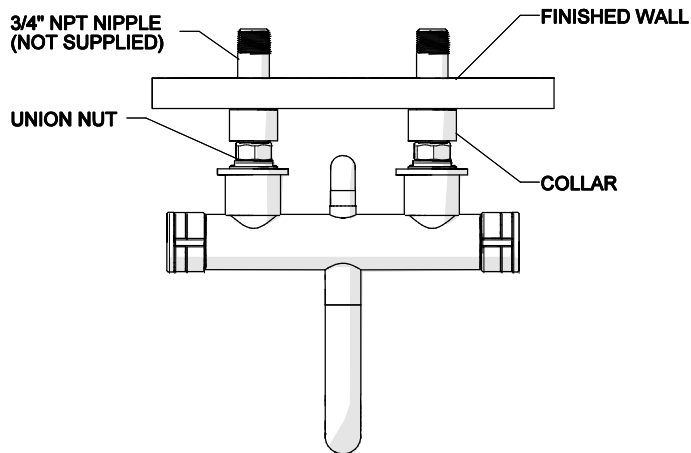

FIGURE - 03

6. Securely tighten the union nuts then thread the collars back onto the valve body to conceal the union nuts. See Figure - 03A.

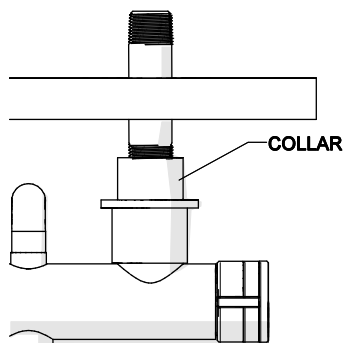

FIGURE - 03A

7. Slide the escutcheon and the gland covers up to the finished surface.

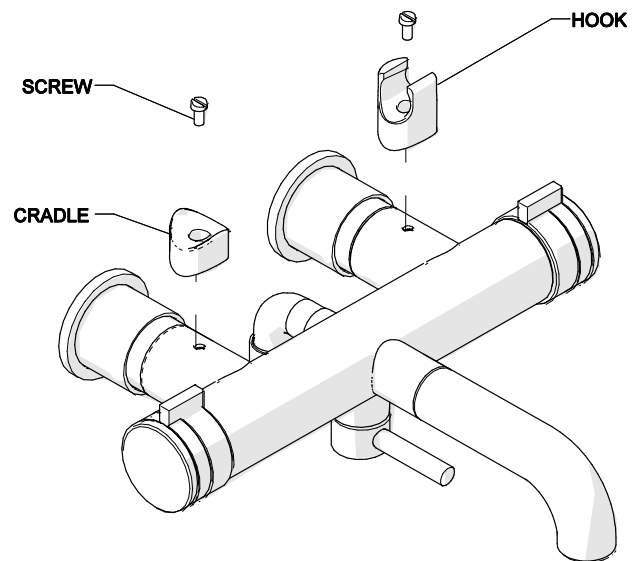

FIGURE - 04

8. Install the HANDSHOWER HOOK and CRADLE as shown (See Figure - 04) onto the VALVE BODY using the screws provided. Ensure that the HOOK is installed with the wider opening facing towards the inside.

9. Install the check valve housing onto the handshower elbow. Making sure that check valve is inside the housing and to include the washer between the housing and elbow.

10. Connect the conical end of the handshower hose to the handshower.

**NOTE:** A flow restricting check valve is located in the inlet of the handshower.

11. Connect the knurled end of the handshower hose to the Tub Filler Body.

## INSPECT THE INSTALLATION:

12. Remove the flow straightener from the spout using the aerator tool provided.
13. Turn on the supplies then open the hot and cold valves to flush out the debris in the supply lines before diverting to the handshower. To divert to the handshower turn the lever on the bottom of the valve.
14. Carefully inspect all the connections for leaks and check for proper operation.
15. Re-install the flow straightener.

## SERVICING:

- Service stops (not provided) should be turned off prior to servicing.

These guidelines have been prepared for the professional contractor to aid in the installation of:  
**DECIBEL WALL MOUNTED EXPOSED TUB FILLER WITH METAL KNOB HANDLE AND HANDSHOWER (STYLE No. DBXT20)**  
All dimensions are based on original specification and are subject to change and variation.  
Please consult your Design Associate for current specifications.

**WATERWORKS**  
STUDIO

- See Figure - 05 for Steps 15 & 16.
- 15. To access the hot and cold CARTRIDGES, unthread the HANDLE ASSEMBLY.
- 16. Remove the CARTRIDGES using a 17mm wrench.

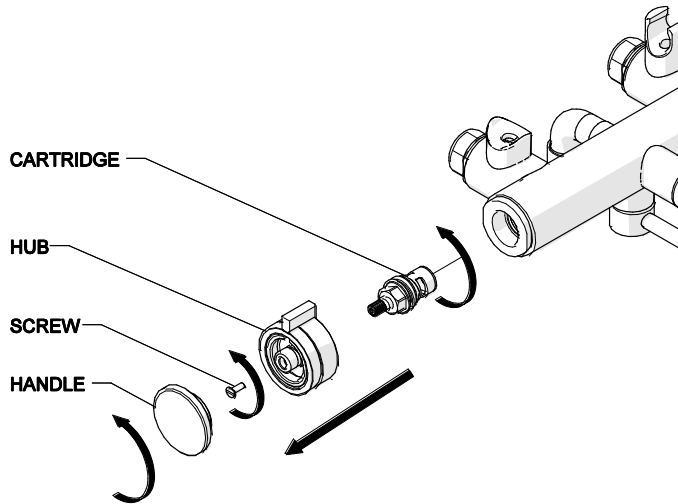

FIGURE - 05

- See Figure - 06 for Steps 17 - 20.

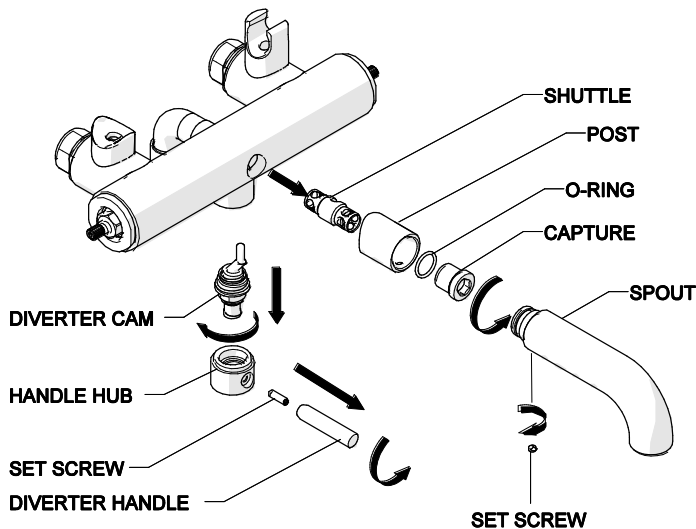

FIGURE - 06

- 17. Unthread DIVERTER HANDLE, and remove DIVERTER HUB.
- 18. Remove DIVERTER CAM ASSEMBLY.
- 19. Loosen SET SCREW on SPOUT, and then remove the SPOUT. Unthread DIVERTER CAPTURE and remove O-RING and POST.
- 20. Remove SHUTTLE.

- If further assistance is required, please contact Product Support at 1-800-927-2120 (8am-6pm EST).
- See service part document for parts ordering, available on [WATERWORKS.COM](http://WATERWORKS.COM).

These guidelines have been prepared for the professional contractor to aid in the installation of:  
DECIBEL WALL MOUNTED EXPOSED TUB FILLER WITH METAL KNOB HANDLE AND HANDSHOWER (STYLE No. DBXT20)  
All dimensions are based on original specification and are subject to change and variation.  
Please consult your Design Associate for current specifications.

**WATERWORKS**  
STUDIO