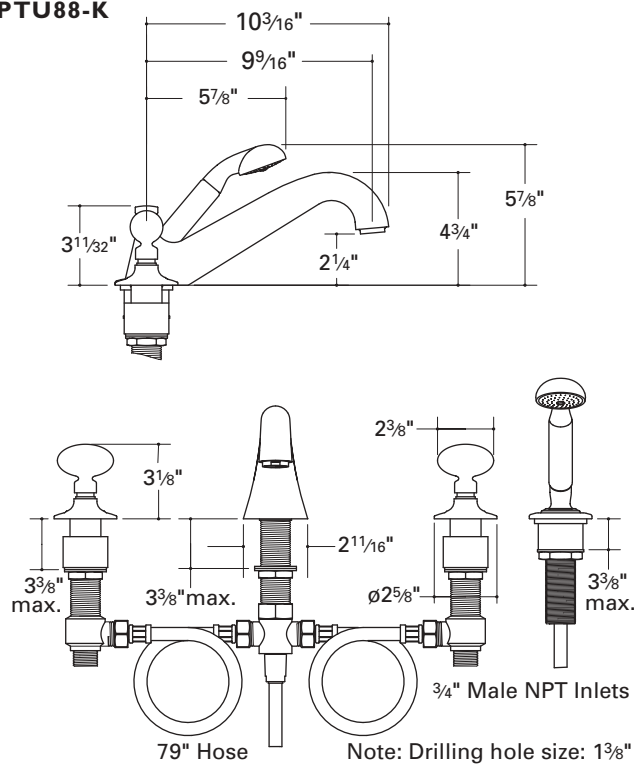
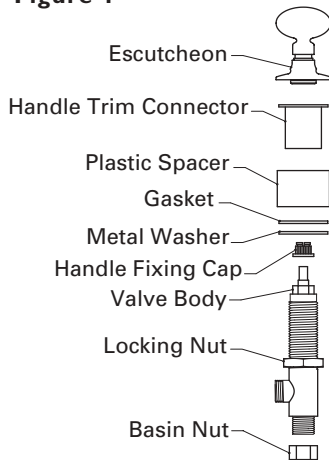
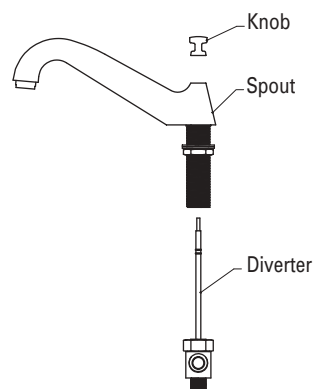
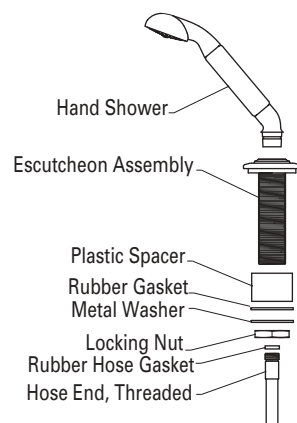

OPTU88-K**NOTES**

- Use only a protected, smooth-jawed, or strap wrench on any finished surface.
- For proper installation, the deck surface should be installed prior to mounting the mixer.
- It is recommended that an access panel be provided for future servicing.
- Check the specifications (left) for drilling hole sizes.
- Run 3/4" supply lines for maximum water flow.
- Accessible shut-off valves, which will facilitate servicing, are recommended for the hot and cold feed lines.
- DO NOT use putty on deck fittings. Upper gaskets are provided.

INSTALLATION

- To remove the handle trim from the handle trim connector, unscrew the escutcheon and pull off the handle and escutcheon together. Then unscrew and lift off the handle trim connector. Leave locking nut, gaskets, and plastic spacer in place on the valve body (see fig. 1).
- Insert the valve body through the mounting hole using the plastic spacer (used for deck surfaces less than 1 1/2" thick). Then screw the handle trim connector onto the valve body until fully seated. Next, tighten the bottom locking nut to secure the valve to the deck. Repeat for the other valve assembly.
- Re-attach the handle trims to the handle trim connector

Figure 1**Figure 2****Figure 3**

- Remove the locking nut, gasket and tee assembly from the spout shank and insert spout through the mounting hole. Please note that the diverter lift knob must be unthreaded before removing the tee assembly (see fig. 2).
- Re-attach the locking nut and gasket to spout shank and tighten until spout is fully secured. Then re-attach the tee assembly and diverter lift knob.
- Install the flexible supply hoses between the valve bodies and the tee assembly.
- Remove the locking nut, gaskets, and plastic spacer from the handshower escutcheon assembly and insert through the mounting hole. Then re-attach and tighten the locking nut, gaskets, and plastic spacer if needed (used for deck surfaces less than 1 1/2" thick) until fully secure (see fig. 3).
- Feed the male threaded end of the hose up through the escutcheon assembly and attach the handshower using the gasket provided (see fig. 3).
- Connect the female tapered end of the hose to the bottom of the tee assembly at the base of the spout.
- Connect the hot and cold water supplies to the side valve bodies.
- After installation, unscrew and remove the aerator assembly from the spout. Carefully open the hot and cold valves fully to flush out any debris in the supply lines. Once the lines have been flushed, close the valves and reinstall the aerator assembly. DO NOT divert the flow of water to the handshower until this step is completed.
- IMPORTANT: It is necessary to check for leaks and proper function of mixer prior to being enclosed.
- If further assistance is required, please contact Product Support at: 1-800-927-2120 (8AM-7PM EST).

These guidelines have been prepared for the professional contractor to aid in the installation of:
OPUS CONCEALED TUB FILLER WITH EGG CRYSTAL HANDLES (OPTU88-K)

11/02

All dimensions are based on original specifications and are subject to change and variation. Please consult your Design Associate for current specifications.

W A T E R W O R K S[®]