

## NORMANDY

NOLV57

Normandy Drop In or Undermount Rectangular Hammered Copper Lavatory Sink 15 3/8" x 11 7/16" x 5 1/8"



SHOWN IN NORMANDY DROP IN OR UNDERMOUNT RECTANGULAR HAMMERED COPPER LAVATORY SINK 22 13/16" X 14 3/4" X 5

### TECHNICAL DETAILS

ADA Compliance: When installed per ADA guidelines  
Bowl Shape: Rectangular  
Depth / Width: 291 mm  
Height: 130 mm  
Installation Type: Drop In or Undermount  
Length: 391 mm  
Number of Holes: Two Hole  
Outer Rim Shape: Rectangular  
Primary Material: Hammered Copper  
Suggested Application: Bath

### INSPIRATION

Like the antique French copper cookware that inspired them, our Normandy sinks lend a special warmth and richness to any environment. Each pure red copper design is hammered and polished by hand according to the old French tradition.

### CODES & STANDARDS

Code # NOLV57:

### PRODUCT FEATURES

Handcrafted in France from sheets of copper and formed in individual molds.  
The Normandy sinks are finished with a burnishing hammer and polished by hand.  
Suitable for master baths and powder rooms.

### PRODUCT (NOTES)

Dimensions of sinks are nominal and are subject to slight variations.

## NORMANDY

NOLV57

Normandy Drop In or Undermount Rectangular Hammered  
Copper Lavatory Sink 15 3/8" x 11 7/16" x 5 1/8"

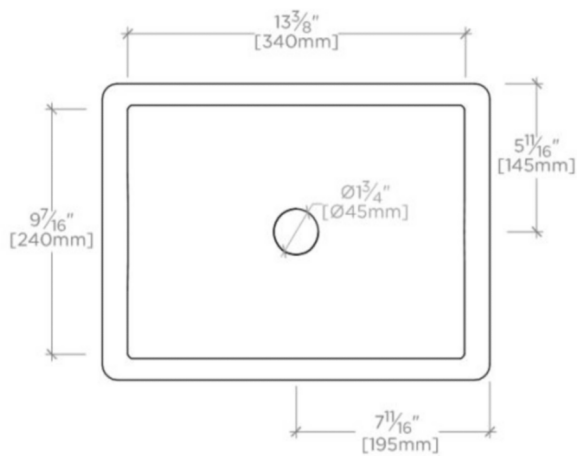

TOP VIEW

SCALE: 1 1/2"=1'-0"

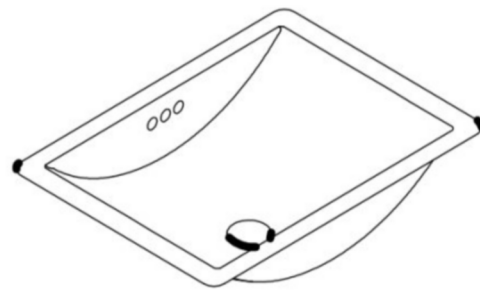

ISO VIEW

SCALE: 1 1/2"=1'-0"

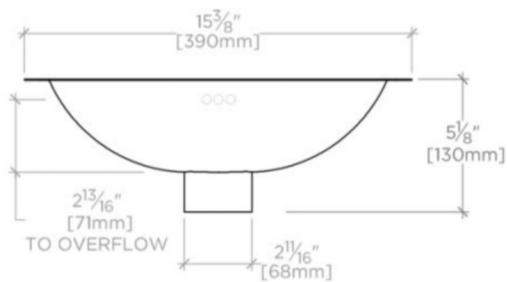

FRONT VIEW

SCALE: 1 1/2"=1'-0"

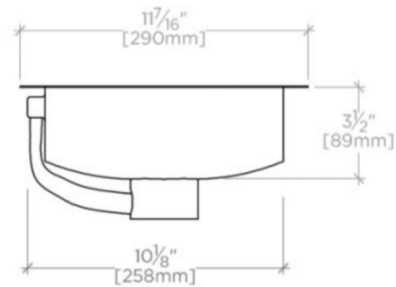

SIDE VIEW

SCALE: 1 1/2"=1'-0"