

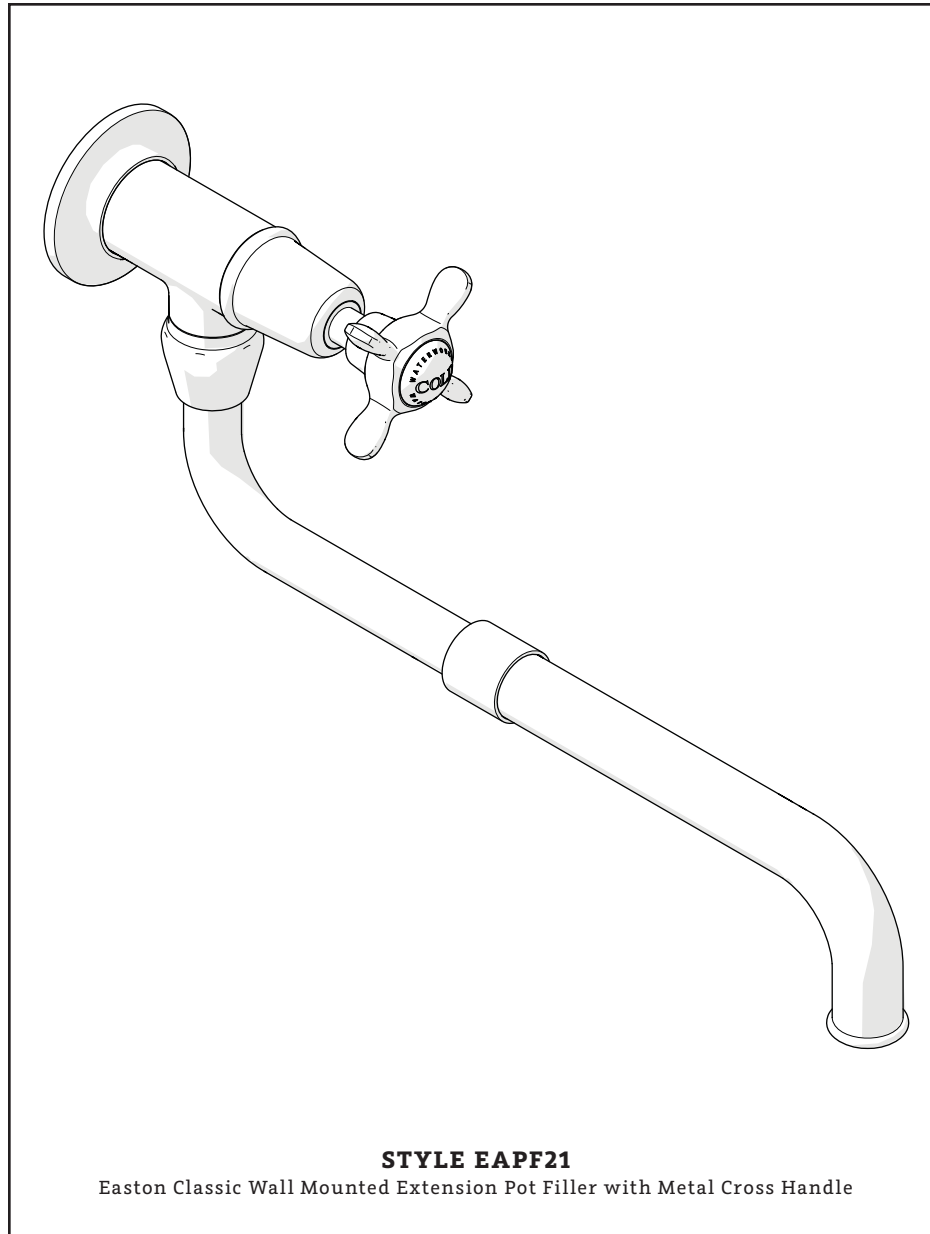

ESTB. 1978

WATERWORKS

SERVICE PARTS



STYLE EAPF21

Easton Classic Wall Mounted Extension Pot Filler with Metal Cross Handle

WELCOME TO

WATERWORKS

For over three decades, Waterworks has transformed the bath through an absolute commitment to design authenticity, innovation and quality. A blend of scholarly appreciation and applied experience guarantees mechanical integrity, meticulous craftsmanship, and timeless designs.

**TO ORDER PARTS CALL
1 (800) 927-2120 (EXT 2)**

Order by part number and specify color, finish, or other options if required.

PRODUCT SUPPORT

Our Product Support team provides troubleshooting and technical problem resolution, including replacement parts and installation recommendations throughout the life of your product.

Product Support is available Monday through Friday, 8AM-6PM EST.

**LIMITED LIFETIME
WARRANTY**

Our warranty covers repair and replacement of Waterworks products if within the applicable coverage period and deemed defective by Waterworks. Waterworks will, at its option, repair or replace such products; this does not include installation costs, labor charges, or other incidental or consequential costs.

To obtain your complete warranty or inquire about warranty service, please visit us at www.waterworks.com or contact our Product Support Team.



ESTB. 1978

WATERWORKS

MAIN KITS

STYLES: EAPF21

*FINISH/COLOR MUST BE SPECIFIED WHEN ORDERING
++SUPPLIED AS A PAIR

337847

COUNTERCLOCKWISE
ON CARTRIDGE

103889*

ESCUTCHEON

103890*

SPOUT

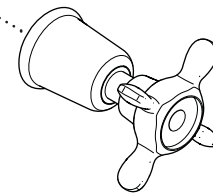
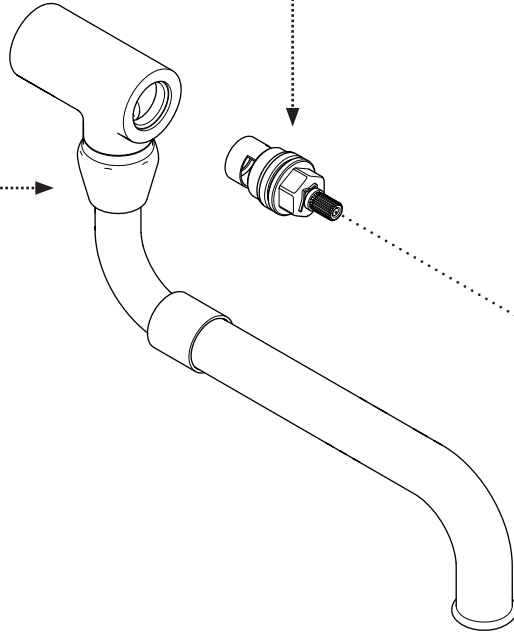
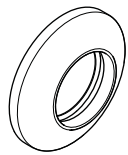

103607*

CROSS HANDLE

103551

COLD PORCELAIN INDICE



ESTB. 1978

WATERWORKS

KIT COMPONENTS

STYLES: EAPF21

103888

SPOUT ADAPTER



VALVE BODY

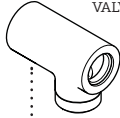

103746

FASTENING SET SCREW



RUBBER WASHER



103891

SPOUT SEAL

UNION NUT



RETAINING COLLAR

SPOUT ELBOW



O-RING

O-RING



103892

CHECK VALVE



SPOUT

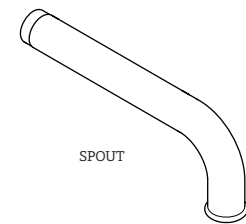

103890*

SPOUT

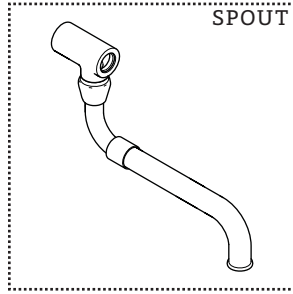

*FINISH/COLOR MUST BE SPECIFIED WHEN ORDERING
++SUPPLIED AS A PAIR

KIT COMPONENTS

ADAPTER

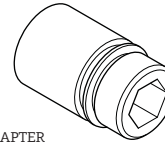

O-RING

O-RING

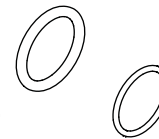

103888

SPOUT ADAPTER

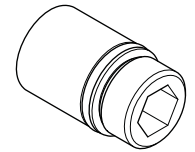

103889*

ESCUTCHEON

RUBBER WASHER

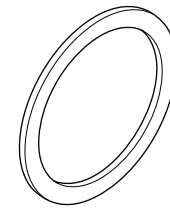

ESCUTCHEON

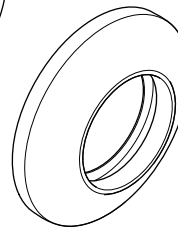

O-RING CORD

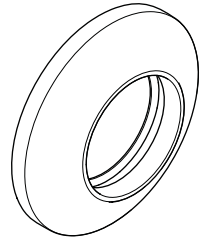
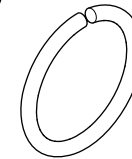



ESTB. 1978

WATERWORKS

KIT COMPONENTS

STYLES: EAPF21

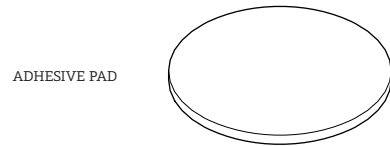
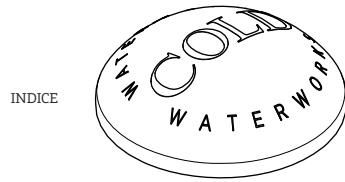

*FINISH/COLOR MUST BE SPECIFIED WHEN ORDERING
++SUPPLIED AS A PAIR

SERVICE PARTS INDEX

<u>STYLE</u>	<u>DESCRIPTION</u>	<u>PG</u>
103892	CHECK VALVE	4
103551	COLD PORCELAIN INDICE	6
337847	COUNTERCLOCKWISE ON CARTRIDGE	2
103607*	CROSS HANDLE	3
103889*	ESCUTCHEON	5
103746	FASTENING SET SCREW	4
103890*	SPOUT	4
103888	SPOUT ADAPTER	5
103891	SPOUT SEAL	4



ESTB. 1978

WATERWORKS

NOTES

STYLES: EAPF21

*FINISH/COLOR MUST BE SPECIFIED WHEN ORDERING
++SUPPLIED AS A PAIR

NOTES



ESTB. 1978

WATERWORKS

PRODUCT SUPPORT

60 BACKUS AVENUE

DANBURY, CT 06810

1 (800) 927-2120 (EXT 2)

WWW.WATERWORKS.COM