

UNIVERSAL

GU25LV

Universal Lavatory Wall Mounted Rough Valve (Used with Lever Handle Lavatory Faucet)



SHOWN IN UNIVERSAL LAVATORY WALL MOUNTED ROUGH VALVE (USED WITH LEVER HANDLE LAVATORY FAUCET)]

TECHNICAL DETAILS

Fittings Hole Diameter: 29 mm
Handle Spread Maximum: 203 mm
Handle Spread Minimum: 203 mm
Handle Turn Angle: Quarter Turn
Depth / Width: 152 mm
Height: 70 mm
Inlet Connection Size: 1/2"
Inlet Connection Type: Female G/BSPP
Installation Type: Wall Mounted
Length: 254 mm
Outlet Connection Size: 1/2"
Outlet Connection Type: Female BSP
Primary Material: Brass
Suggested Application: Bath
Valve Material: Ceramic
Water Pressure Maximum: 5.5 bar
Water Pressure Minimum: 1.5 bar
Water Pressure Recommended: 3.0 bar

INSPIRATION

Our Universal collection features timeless designs complementing any of our Waterworks. With a wide range of product, from fittings to accessories, Universal adds exquisite proportion and balance to any environment.

CODES & STANDARDS

Code # : ASME A112.18.1 / CSA B125.1, State of MA, UL

PRODUCT FEATURES

This hot and cold cartridge rough is for use with Waterworks wall mounted faucets

1/2" NPT male inlet and 1/2" NPT female outlet, with quarter turn functionality

Made of brass materials

6 gpm unrestricted maximum flow at 45 psi

Available option that complies with 0.25% Weighted Average Lead Content (WALC).

UNIVERSAL

GU25LV

Universal Lavatory Wall Mounted Rough Valve (Used with Lever Handle Lavatory Faucet)

ADAPTER(S) PACKAGED SEPARATELY		
ADAPTER	DESCRIPTION	QTY
UNUK02	½" Male NPT x ½" Female BSP	3

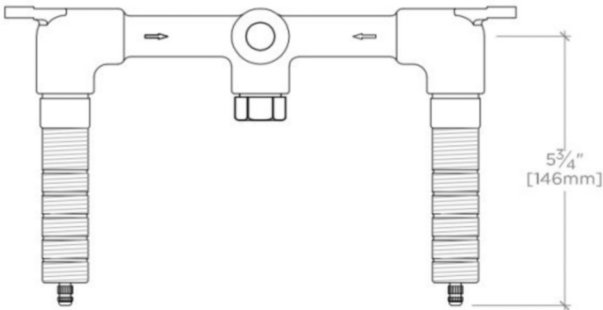

TOP VIEW SCALE: 3"=1'-0"

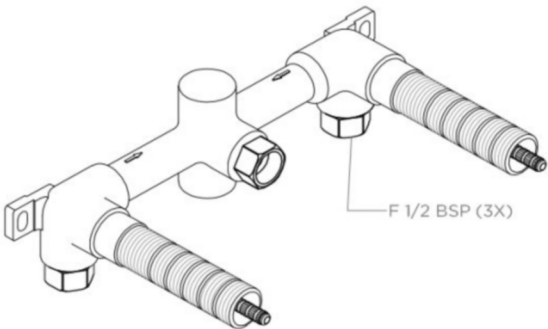

ISO VIEW SCALE: 3"=1'-0"

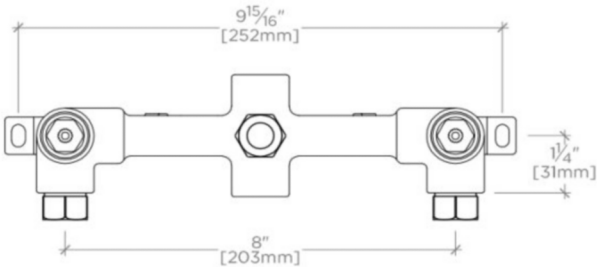

FRONT VIEW SCALE: 3"=1'-0"

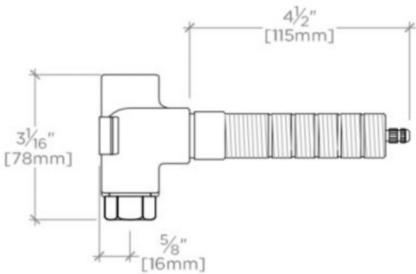

SIDE VIEW SCALE: 3"=1'-0"