

# UNIVERSAL

1/2" Volume Control Valve

# INSTALLATION GUIDELINES

**Style No.** GUV18<sup>†</sup> - Counterclockwise Open  
**Code No.** GUSV18R

**Style No.** GUV19<sup>†</sup> - Clockwise Open  
**Code No.** GUSV19R

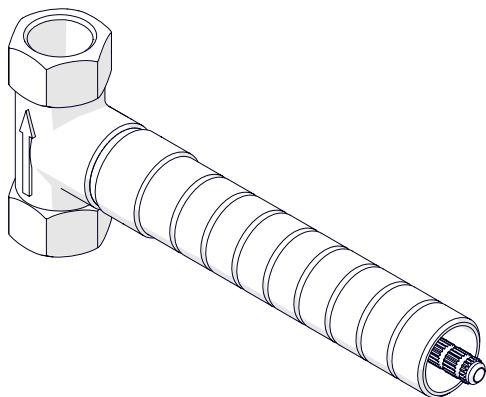

## SPECIFICATIONS:

<b>Fitting Hole Diameter</b>	Ø1-3/8" (Ø 35mm)*
<b>Inlet/Outlet Connection Size &amp; Type:</b>	1/2" Female NPT <sup>†</sup>
<b>Recommended Water Pressure:</b>	45 psi (3 Bar)
<b>Unrestricted Maximum Flow Rate:</b>	6gpm @ 45 psi (23 L/min @ 3 Bar)
<b>Valve Material:</b>	Ceramic
<b>Water Pressure:</b>	20 psi MIN - 80psi MAX (1.4 Bar Min - 5.5 Bar Max)

\* Ø1-3/8" (Ø 35mm) hole is required for servicing.

<sup>†</sup> UK Style Nos. **GU18VC** & **GU19VC** are supplied with 2 **BSP** Adapters, assembly required.

## IMPORTANT:

- To ensure this product is installed properly, you must read and follow these guidelines.
- The owner/user of this product must keep this information for future reference.
- Valve body rough-in depth is measured from the centerline of the inlets to the surface of the finished wall and varies depending on the trim used.
- **This wall valve controls on/off/volume only.**
- This product must be installed by a professional licensed contractor.
- **DO NOT APPLY DIRECT HEAT TO THE VALVE.** If soldering any connections, remove cartridge to prevent damage to seals and internal assembly.
- The trim should be on-site prior to rough in and allows the installer to visualize the installation.
- Check local building and plumbing codes to ensure that your installation conforms to all applicable requirements. In the State of Massachusetts, all

installations must comply with the rules and regulations set forth within 248 CMR.

- Inspect this product to assure you have all parts shown that are required for proper installation.
- Check incoming water pressure.

## ROUGH-IN:

- **IMPORTANT:** Valve rough-in depth is measured from the center of the inlets to the surface of the finished wall and varies depending on the trim used. See Figure -01 for steps 1 - 6.

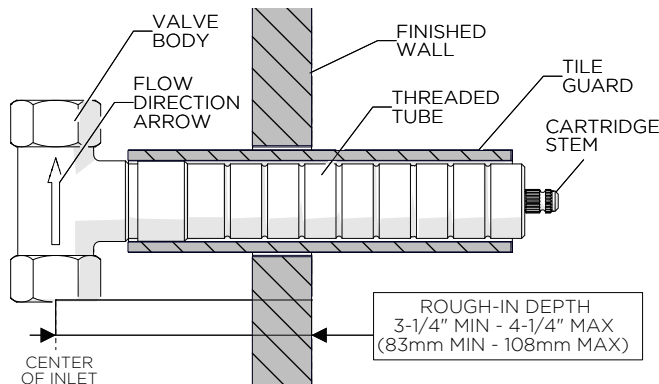

**FIGURE - 01**

1. Make sure the valve body is positioned according to the **FLOW DIRECTION ARROW** marked on the **VALVE BODY**.
2. Run a 1/2" (15mm) copper supply line to the proper height of the valve inlet and be sure to secure all piping and fittings.
3. For each fitting that will have water flowing to it, install a wall valve or diverter valve (both sold separately) at the same rough in depth as the mixing valve.
4. Install the **TILE GUARD** to protect the valve during the completion of the finished wall and to create the exact opening for access to the cartridge and future servicing.

## INSPECT THE INSTALLATION:

5. Turn the on the water supply and inspect all connections for leaks
  6. Install the Tile Guard.
- If further assistance is required, please contact Product Support at 1-800-927-2120 (8am-6pm EST).
  - See service part document for parts ordering, available on [WATERWORKS.COM](http://WATERWORKS.COM).

<sup>†</sup> **BSP** Adapter can be ordered separately:  
(2x) **STYLE No.** UNUK02  
**ITEM No.** 45-57632-24328

These guidelines have been prepared for the professional contractor to aid in the installation of:  
**UNIVERSAL 1/2" VOLUME CONTROL VALVE**  
**STYLE NOS.** GUV18, GU18VC (UK), GUV19 & GU19VC (UK).  
All dimensions are based on original specification and are subject to change and variation.  
Please consult your Design Associate for current specifications.

**WATERWORKS**