

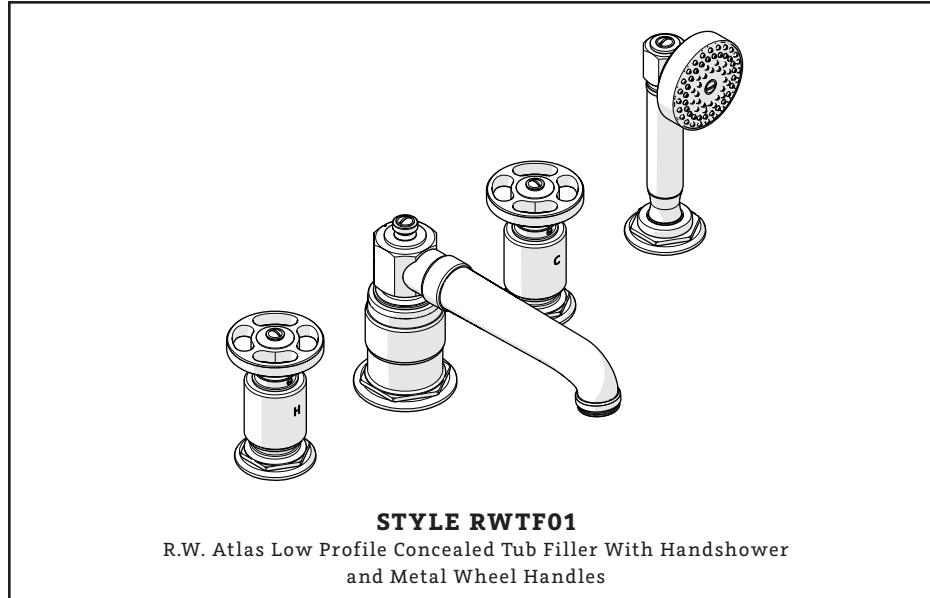

ESTB. 1978

WATERWORKS SERVICE PARTS



STYLE RWTF01

R.W. Atlas Low Profile Concealed Tub Filler With Handshower
and Metal Wheel Handles

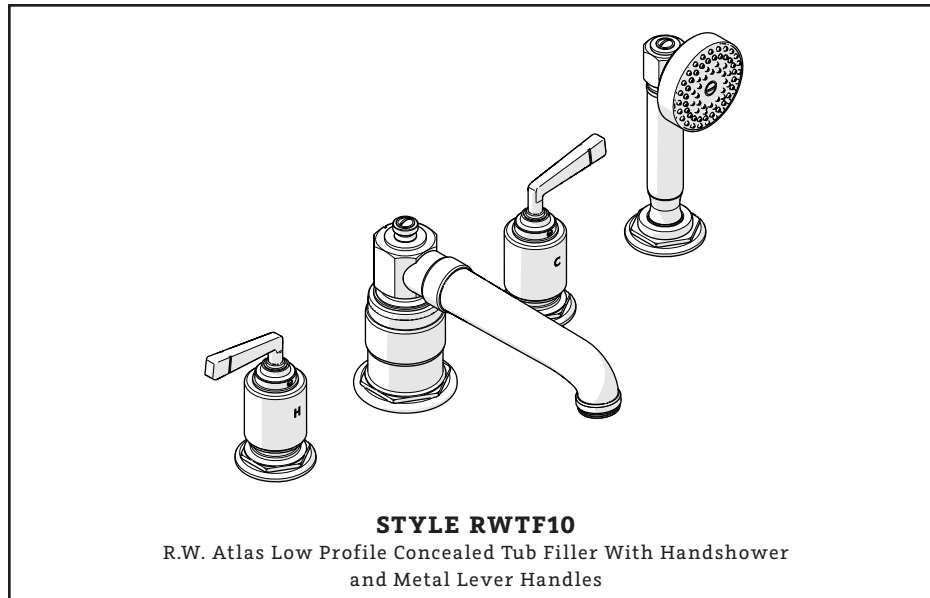

STYLE RWTF10

R.W. Atlas Low Profile Concealed Tub Filler With Handshower
and Metal Lever Handles

WELCOME TO

WATERWORKS

For over three decades, Waterworks has transformed the bath through an absolute commitment to design authenticity, innovation and quality. A blend of scholarly appreciation and applied experience guarantees mechanical integrity, meticulous craftsmanship, and timeless designs.

**TO ORDER PARTS CALL
1 (800) 927-2120 (EXT 2)**

Order by part number and specify color, finish, or other options if required.

PRODUCT SUPPORT

Our Product Support team provides troubleshooting and technical problem resolution, including replacement parts and installation recommendations throughout the life of your product.

Product Support is available Monday through Friday, 8AM-6PM EST.

**LIMITED LIFETIME
WARRANTY**

Our warranty covers repair and replacement of Waterworks products if within the applicable coverage period and deemed defective by Waterworks. Waterworks will, at its option, repair or replace such products; this does not include installation costs, labor charges, or other incidental or consequential costs.

To obtain your complete warranty or inquire about warranty service, please visit us at www.waterworks.com or contact our Product Support Team.



ESTB. 1978

WATERWORKS

MAIN KITS

STYLES: RWTF01, RWTF10

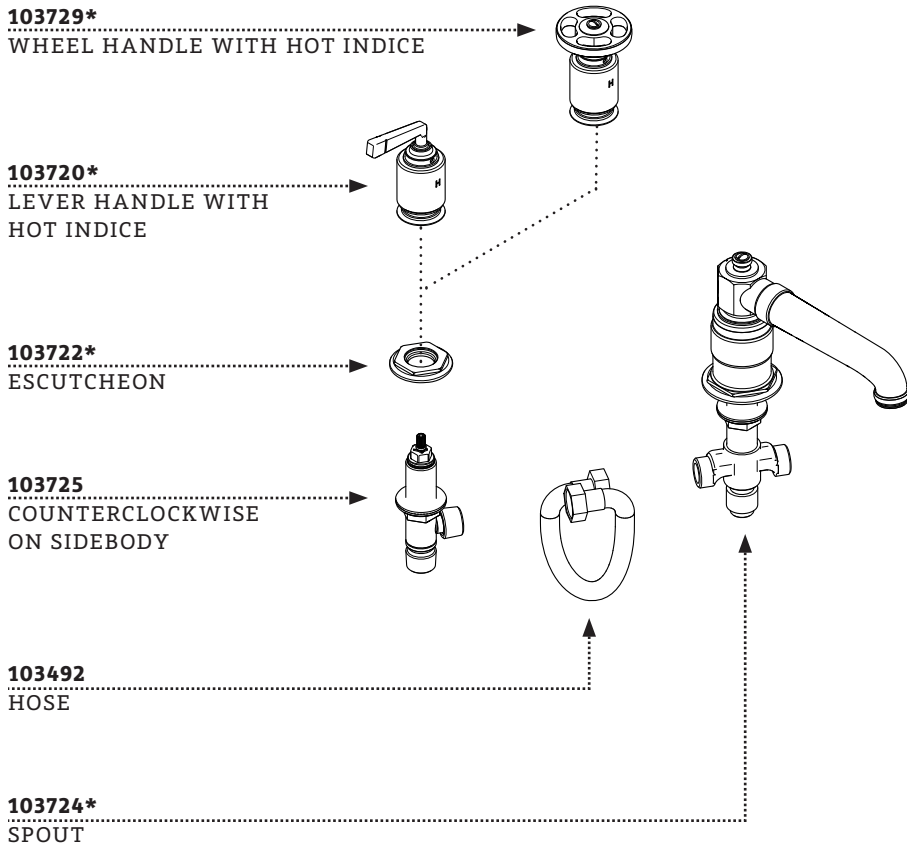

*FINISH/COLOR MUST BE SPECIFIED WHEN ORDERING
++SUPPLIED AS A PAIR

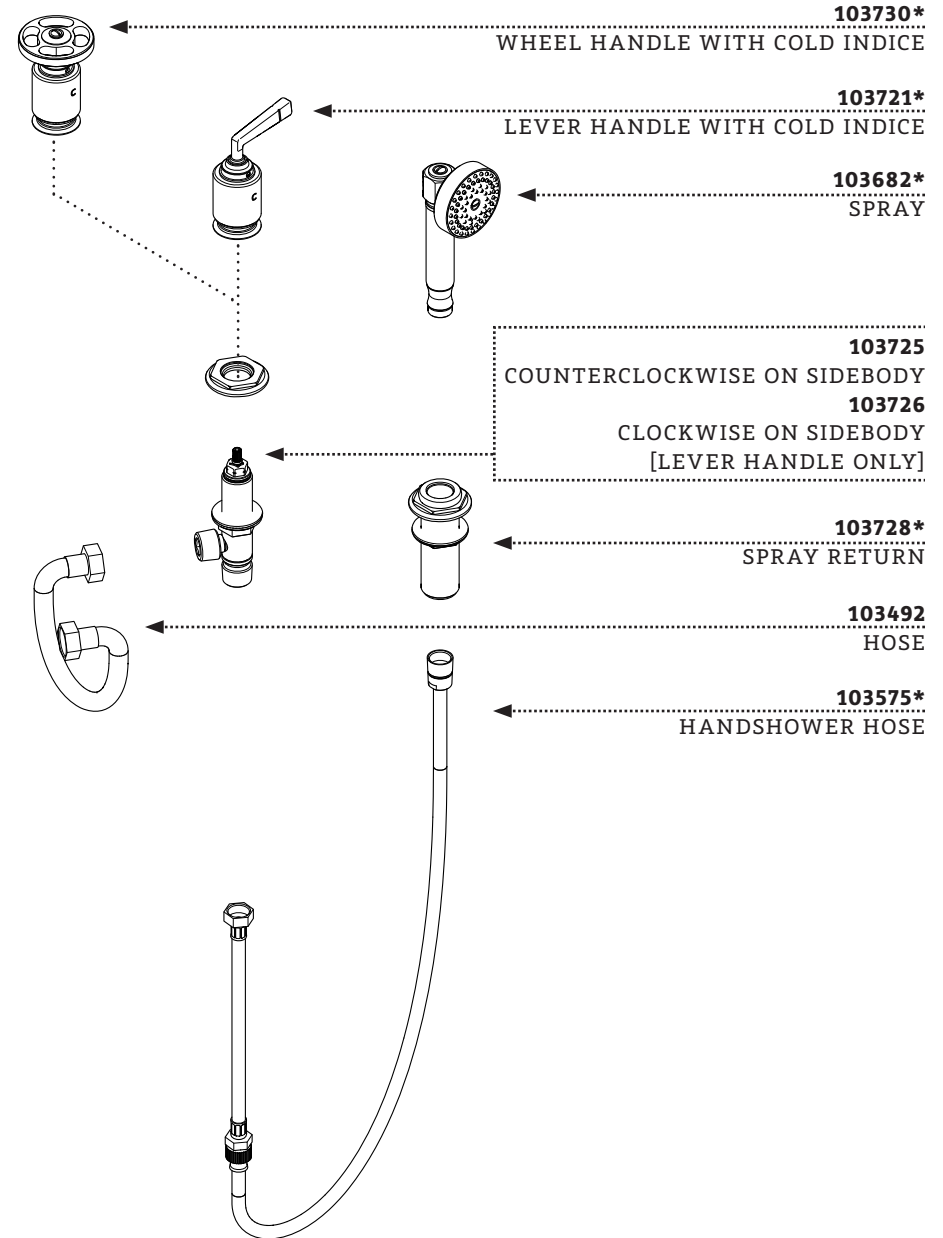



ESTB. 1978

WATERWORKS

KIT COMPONENTS

STYLES: RWTF01, RWTF10

103682*

SPRAY

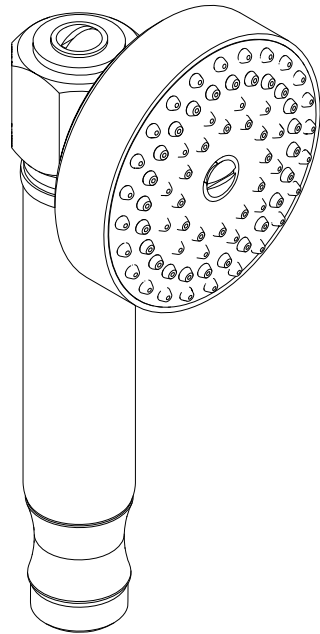
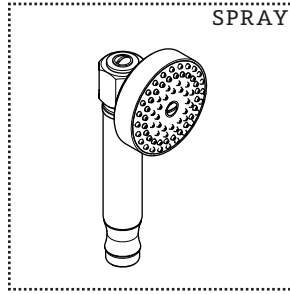

HANDSHOWER

FLOW REGULATING
CHECK VALVE

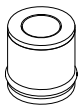

CLIP



*FINISH/COLOR MUST BE SPECIFIED WHEN ORDERING
++SUPPLIED AS A PAIR

KIT COMPONENTS

103728*

SPRAY RETURN

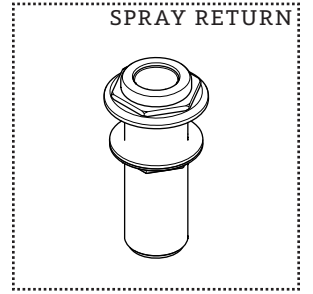

COLLAR



SLEEVE

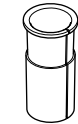

ALL THREAD TUBE



RING



HEX COLLAR



O-RING



ESCUTCHEON



O-RING



RUBBER WASHER



NUT





ESTB. 1978

WATERWORKS

KIT COMPONENTS

STYLES: RWTF01, RWTF10

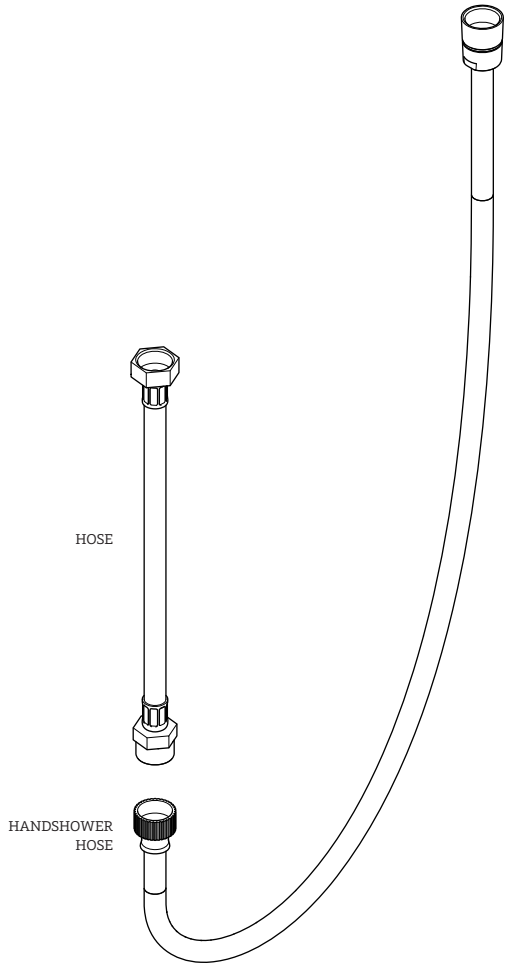

103575*

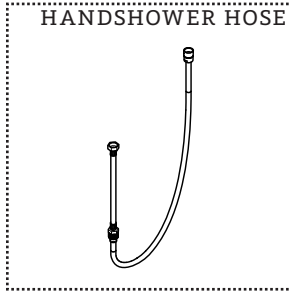

*FINISH/COLOR MUST BE SPECIFIED WHEN ORDERING
++SUPPLIED AS A PAIR

KIT COMPONENTS

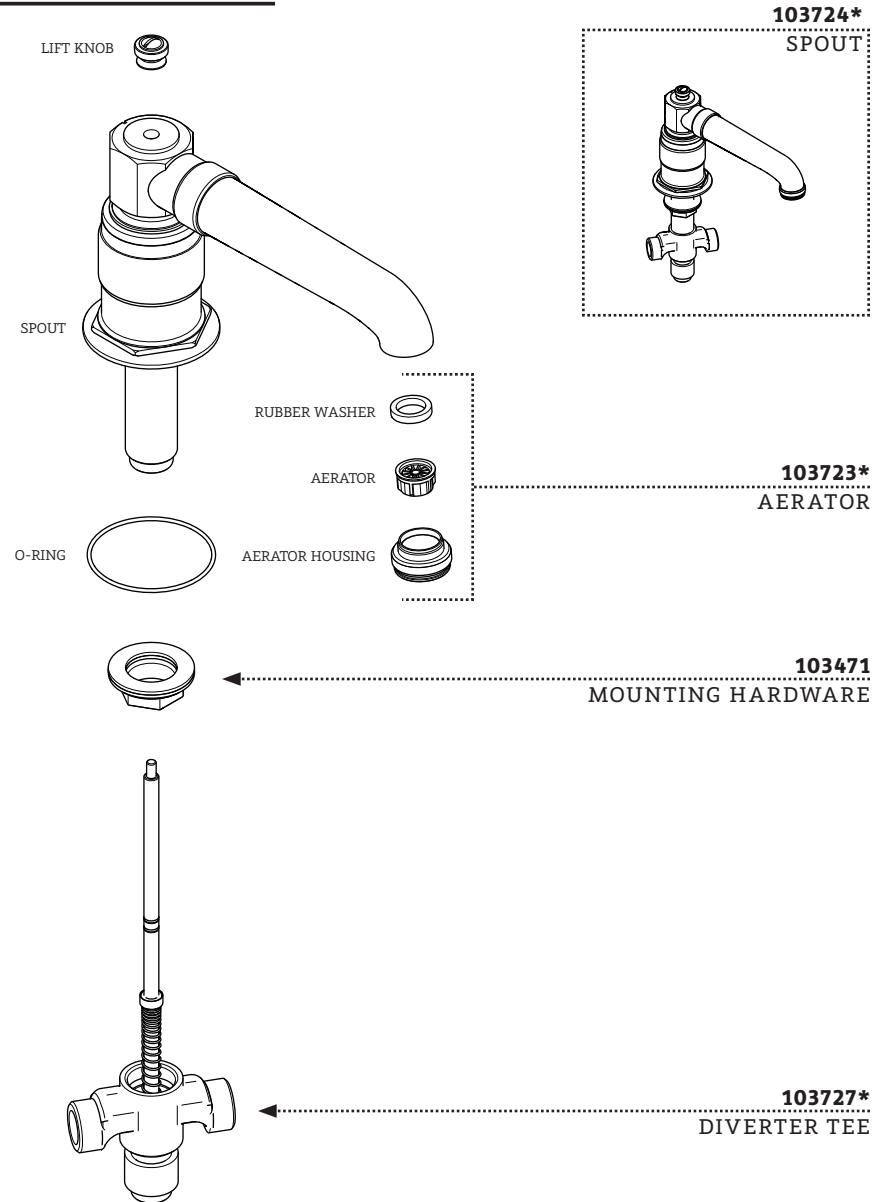

103724*

SPOUT

103723*

AERATOR

103471

MOUNTING HARDWARE

103727*

DIVERTER TEE



ESTB. 1978

WATERWORKS

KIT COMPONENTS

STYLES: RWTF01, RWTF10

HEX COLLAR

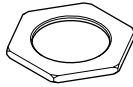

O-RING



ESCUTCHEON

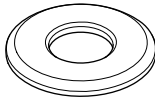

O-RING



103722*
ESCUTCHEON

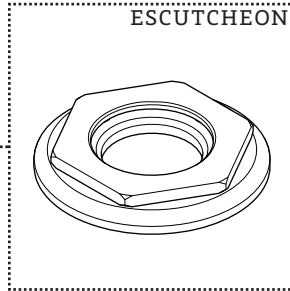

103471
MOUNTING
HARDWARE

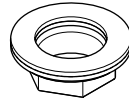

337847
COUNTERCLOCKWISE
ON CARTRIDGE



103725
COUNTERCLOCKWISE
ON SIDEBODY

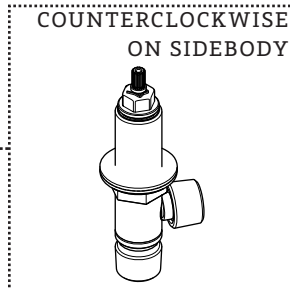
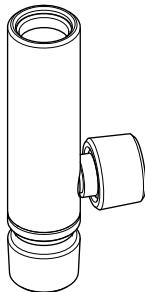
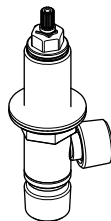

*FINISH/COLOR MUST BE SPECIFIED WHEN ORDERING
++SUPPLIED AS A PAIR

KIT COMPONENTS

HEX COLLAR

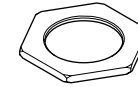

O-RING



ESCUTCHEON

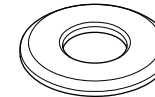

O-RING



103722*
ESCUTCHEON

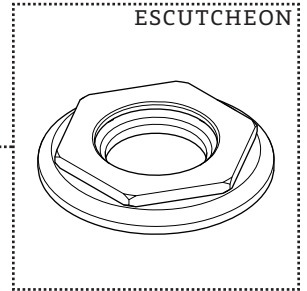

103471
MOUNTING
HARDWARE

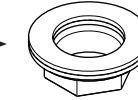

258790
CLOCKWISE ON
CARTRIDGE

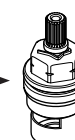

103726
CLOCKWISE ON
SIDEBODY

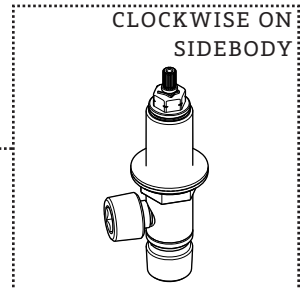
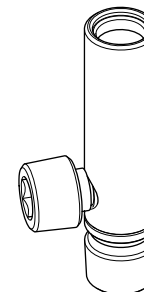
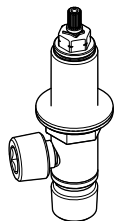



ESTB. 1978

WATERWORKS

KIT COMPONENTS

STYLES: RWTF01, RWTF10

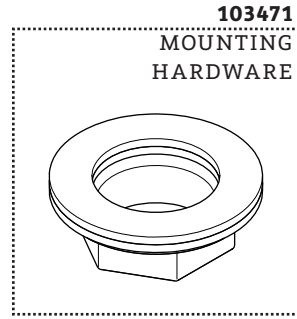

RUBBER WASHER

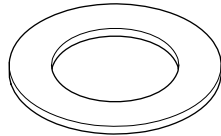

PLASTIC WASHER

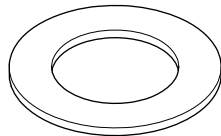

NUT

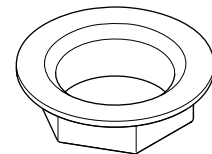

*FINISH/COLOR MUST BE SPECIFIED WHEN ORDERING
++SUPPLIED AS A PAIR

KIT COMPONENTS

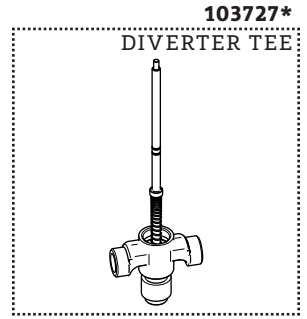

DIVERTER ROD

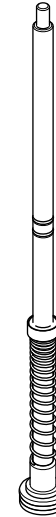

O-RING



TEE

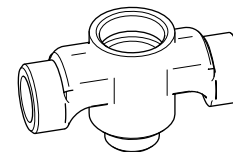

RUBBER WASHER



103678
CHECK VALVE

HOUSING





ESTB. 1978

WATERWORKS

STYLES: RWTF01, RWTF10

*FINISH/COLOR MUST BE SPECIFIED WHEN ORDERING
++SUPPLIED AS A PAIR

SERVICE PARTS INDEX

NOTES

<u>STYLE</u>	<u>DESCRIPTION</u>	<u>PG</u>
103723*	AERATOR	7
103678	CHECK VALVE	11
258790	CLOCKWISE ON CARTRIDGE	9
103726	CLOCKWISE ON SIDEBODY	9
337847	COUNTERCLOCKWISE ON CARTRIDGE	8
103725	COUNTERCLOCKWISE ON SIDEBODY	8
103727*	DIVERTER TEE	11
103722*	ESCUTCHEON	9
103575*	HANDSHOWER HOSE	6
103492	HOSE	3
103721*	LEVER HANDLE WITH COLD INDICE	3
103720*	LEVER HANDLE WITH HOT INDICE	2
103471	MOUNTING HARDWARE	10
103724*	SPOUT	7
103682*	SPRAY	4
103728*	SPRAY RETURN	5
103730*	WHEEL HANDLE WITH COLD INDICE	3
103729*	WHEEL HANDLE WITH HOT INDICE	2

DOCUMENT: SPRW13_REV01



ESTB. 1978

WATERWORKS

PRODUCT SUPPORT

60 BACKUS AVENUE
DANBURY, CT 06810

1 (800) 927-2120 (EXT 2)

WWW.WATERWORKS.COM