

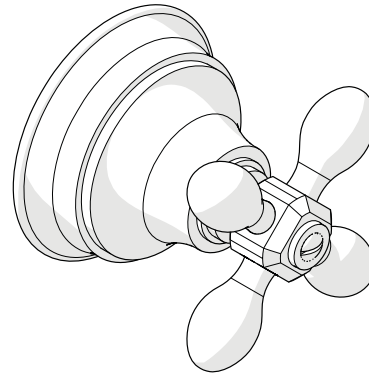

ESTB. 1978

WATERWORKS

SERVICE PARTS



STYLE RTVC57

Aero Retro Volume Control Valve Trim with Metal Cross Handle

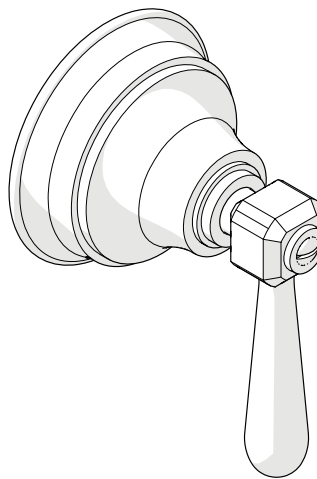

STYLE RTVC59

Aero Retro Volume Control Valve Trim with Metal Lever Handle

WELCOME TO

WATERWORKS

For over three decades, Waterworks has transformed the bath through an absolute commitment to design authenticity, innovation and quality. A blend of scholarly appreciation and applied experience guarantees mechanical integrity, meticulous craftsmanship, and timeless designs.

**TO ORDER PARTS CALL
1 (800) 927-2120 (EXT 2)**

Order by part number and specify color, finish, or other options if required.

PRODUCT SUPPORT

Our Product Support team provides troubleshooting and technical problem resolution, including replacement parts and installation recommendations throughout the life of your product.

Product Support is available Monday through Friday, 8AM-6PM EST.

**LIMITED LIFETIME
WARRANTY**

Our warranty covers repair and replacement of Waterworks products if within the applicable coverage period and deemed defective by Waterworks. Waterworks will, at its option, repair or replace such products; this does not include installation costs, labor charges, or other incidental or consequential costs.

To obtain your complete warranty or inquire about warranty service, please visit us at www.waterworks.com or contact our Product Support Team.



ESTB. 1978

WATERWORKS

MAIN KITS

STYLES: RTVC57, RTVC59

103517*
CROSS HANDLE

103521
HANDLE TRIM
CONNECTOR

103515*
ESCUTCHEON

103516*
LEVER HANDLE

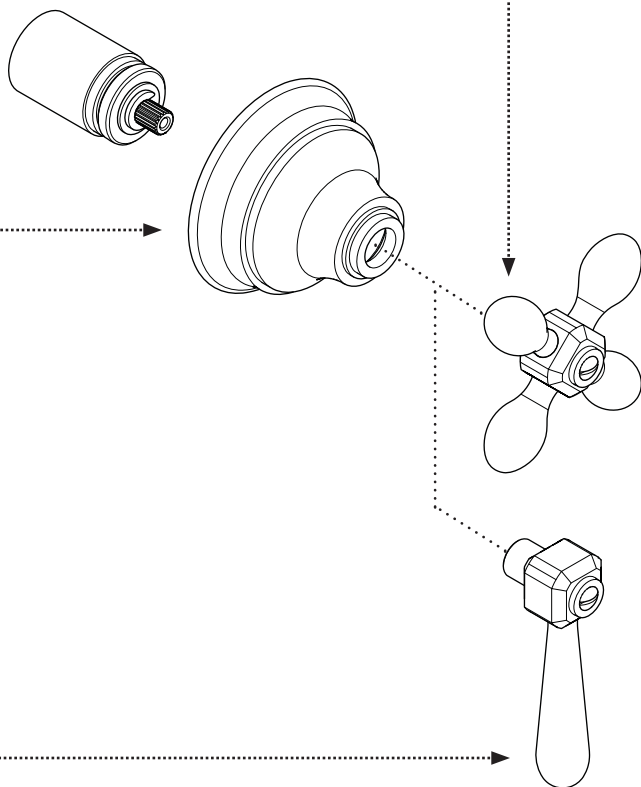

*FINISH/COLOR MUST BE SPECIFIED WHEN ORDERING
++SUPPLIED AS A PAIR

KIT COMPONENTS

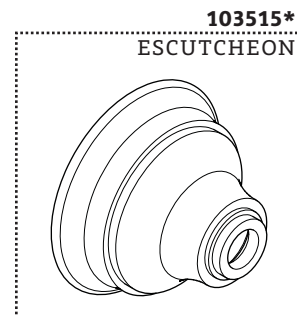

RUBBER WASHER

ESCUTCHEON

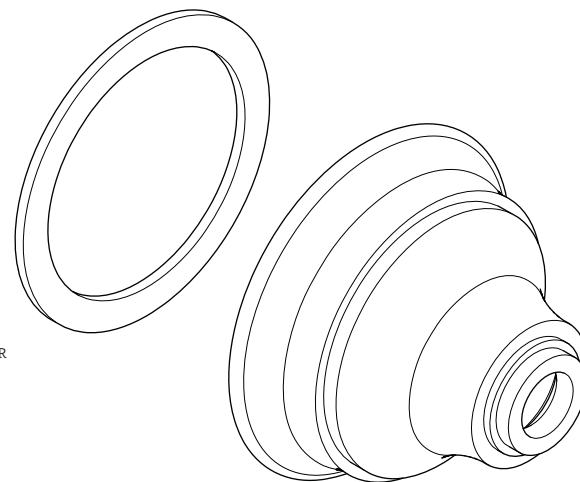



ESTB. 1978

WATERWORKS

KIT COMPONENTS

STYLES: RTVC57, RTVC59

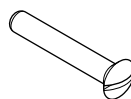
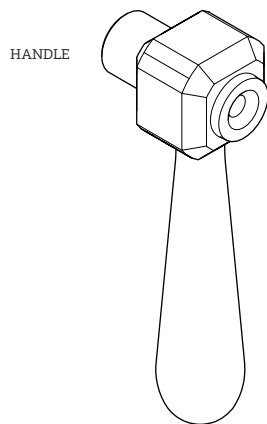
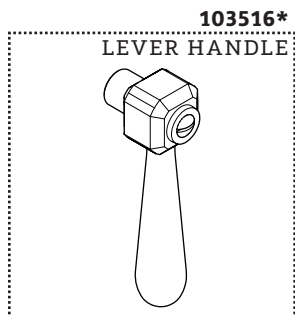

103518*
HANDLE SCREW

*FINISH/COLOR MUST BE SPECIFIED WHEN ORDERING
++SUPPLIED AS A PAIR

KIT COMPONENTS

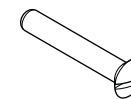
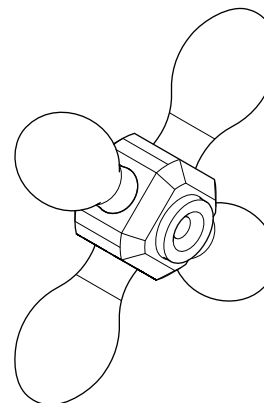
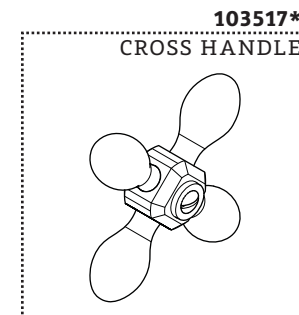

103518*
HANDLE SCREW



ESTB. 1978

W A T E R W O R K S

SERVICE PARTS INDEX

<u>STYLE</u>	<u>DESCRIPTION</u>	<u>PG</u>
103517*	CROSS HANDLE	5
103515*	ESCUTCHEON	3
103518*	HANDLE SCREW	5
103521	HANDLE TRIM CONNECTOR	2
103516*	LEVER HANDLE	4

STYLES: RTVC57, RTVC59

*FINISH/COLOR MUST BE SPECIFIED WHEN ORDERING

++SUPPLIED AS A PAIR

NOTES

DOCUMENT: SPRT04_REV01



ESTB. 1978

W A T E R W O R K S

NOTES

STYLES: RTVC57, RTVC59

*FINISH/COLOR MUST BE SPECIFIED WHEN ORDERING

++SUPPLIED AS A PAIR

NOTES



ESTB. 1978

W A T E R W O R K S

PRODUCT SUPPORT

60 BACKUS AVENUE

DANBURY, CT 06810

1 (800) 927-2120 (EXT 2)

WWW.WATERWORKS.COM