

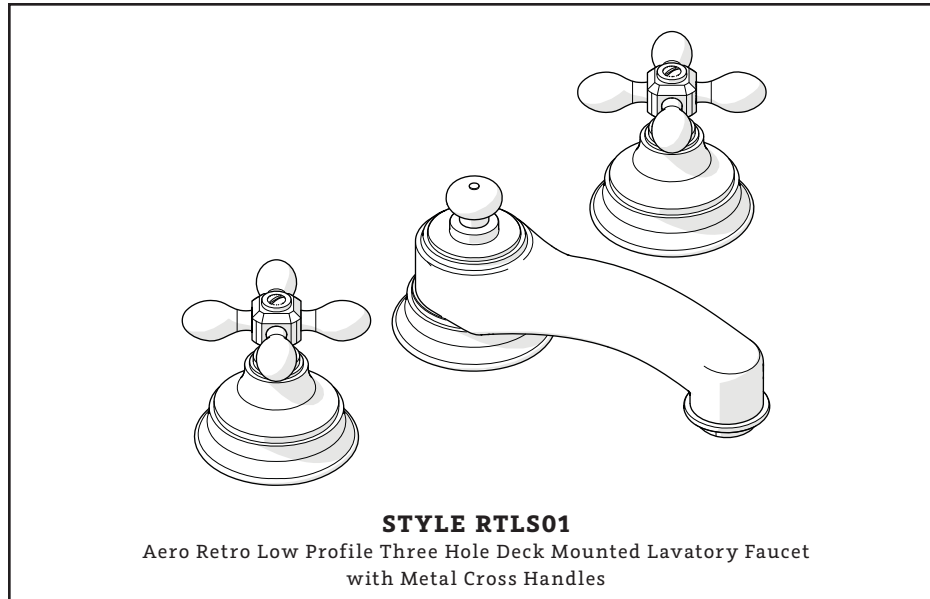

ESTB. 1978

# WATERWORKS SERVICE PARTS



## **STYLE RTLS01**

Aero Retro Low Profile Three Hole Deck Mounted Lavatory Faucet  
with Metal Cross Handles

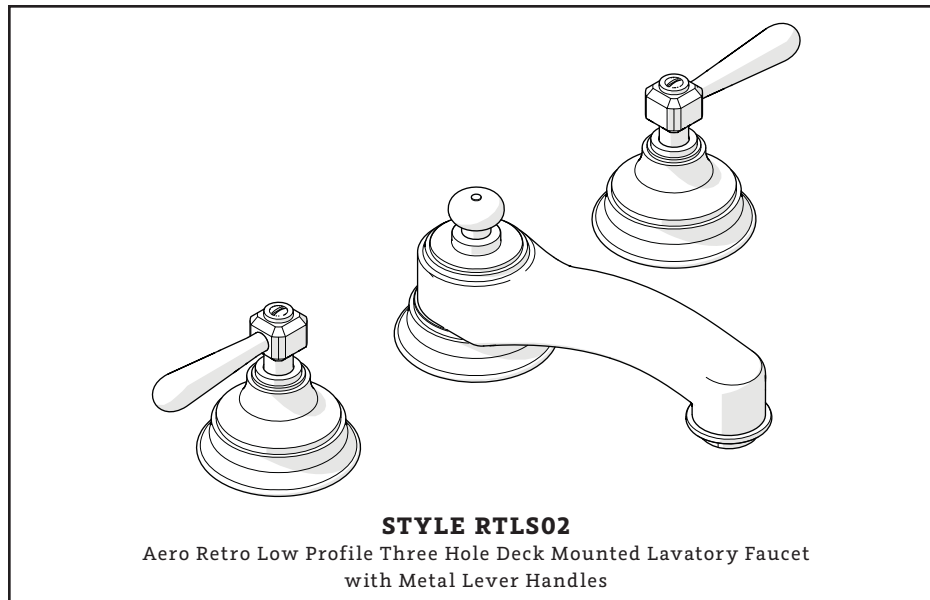

## **STYLE RTLS02**

Aero Retro Low Profile Three Hole Deck Mounted Lavatory Faucet  
with Metal Lever Handles

---

WELCOME TO

# WATERWORKS

For over three decades, Waterworks has transformed the bath through an absolute commitment to design authenticity, innovation and quality. A blend of scholarly appreciation and applied experience guarantees mechanical integrity, meticulous craftsmanship, and timeless designs.

---

**TO ORDER PARTS CALL  
1 (800) 927-2120 (EXT 2)**

Order by part number and specify color, finish, or other options if required.

**PRODUCT SUPPORT**

Our Product Support team provides troubleshooting and technical problem resolution, including replacement parts and installation recommendations throughout the life of your product.

Product Support is available Monday through Friday, 8AM-6PM EST.

**LIMITED LIFETIME  
WARRANTY**

Our warranty covers repair and replacement of Waterworks products if within the applicable coverage period and deemed defective by Waterworks. Waterworks will, at its option, repair or replace such products; this does not include installation costs, labor charges, or other incidental or consequential costs.

To obtain your complete warranty or inquire about warranty service, please visit us at [www.waterworks.com](http://www.waterworks.com) or contact our Product Support Team.



ESTB. 1978

WATERWORKS

### MAIN KITS

STYLES: RTL01, RTL02

103470\*  
SPOUT

103467\*  
CROSS HANDLE

103485\*  
LEVER HANDLE

103469\*  
ESCUTCHEON

103474  
COUNTERCLOCKWISE  
ON SIDEBODY

103475  
HOSE

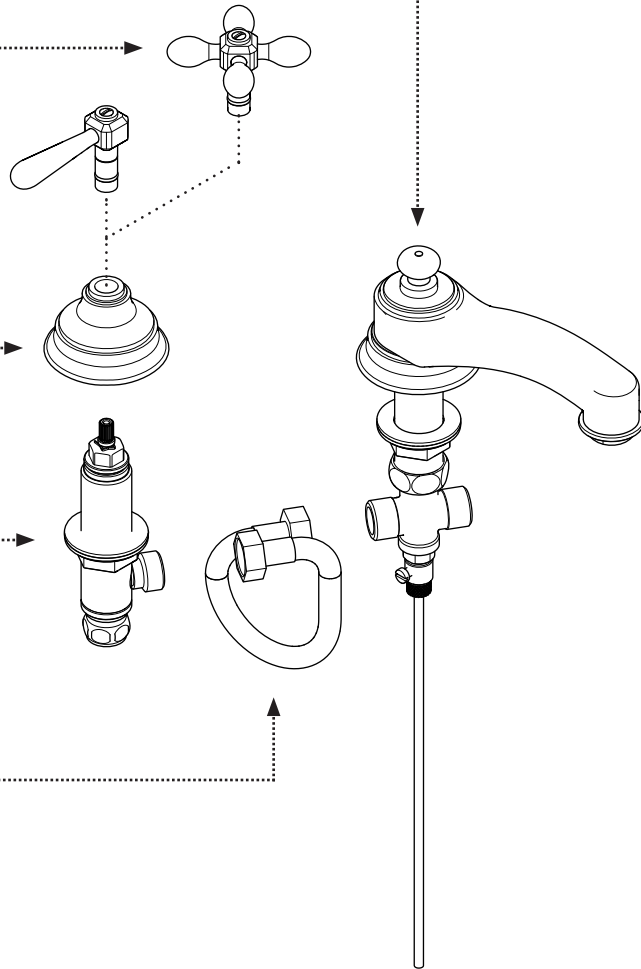

\*FINISH/COLOR MUST BE SPECIFIED WHEN ORDERING  
++SUPPLIED AS A PAIR

103467\*  
CROSS HANDLE

103485\*  
LEVER HANDLE

103469\*  
ESCUTCHEON

103474  
COUNTERCLOCKWISE ON SIDEBODY  
103504  
CLOCKWISE ON SIDEBODY  
[LEVER HANDLE ONLY]

103475  
HOSE

103476\*  
DRAIN

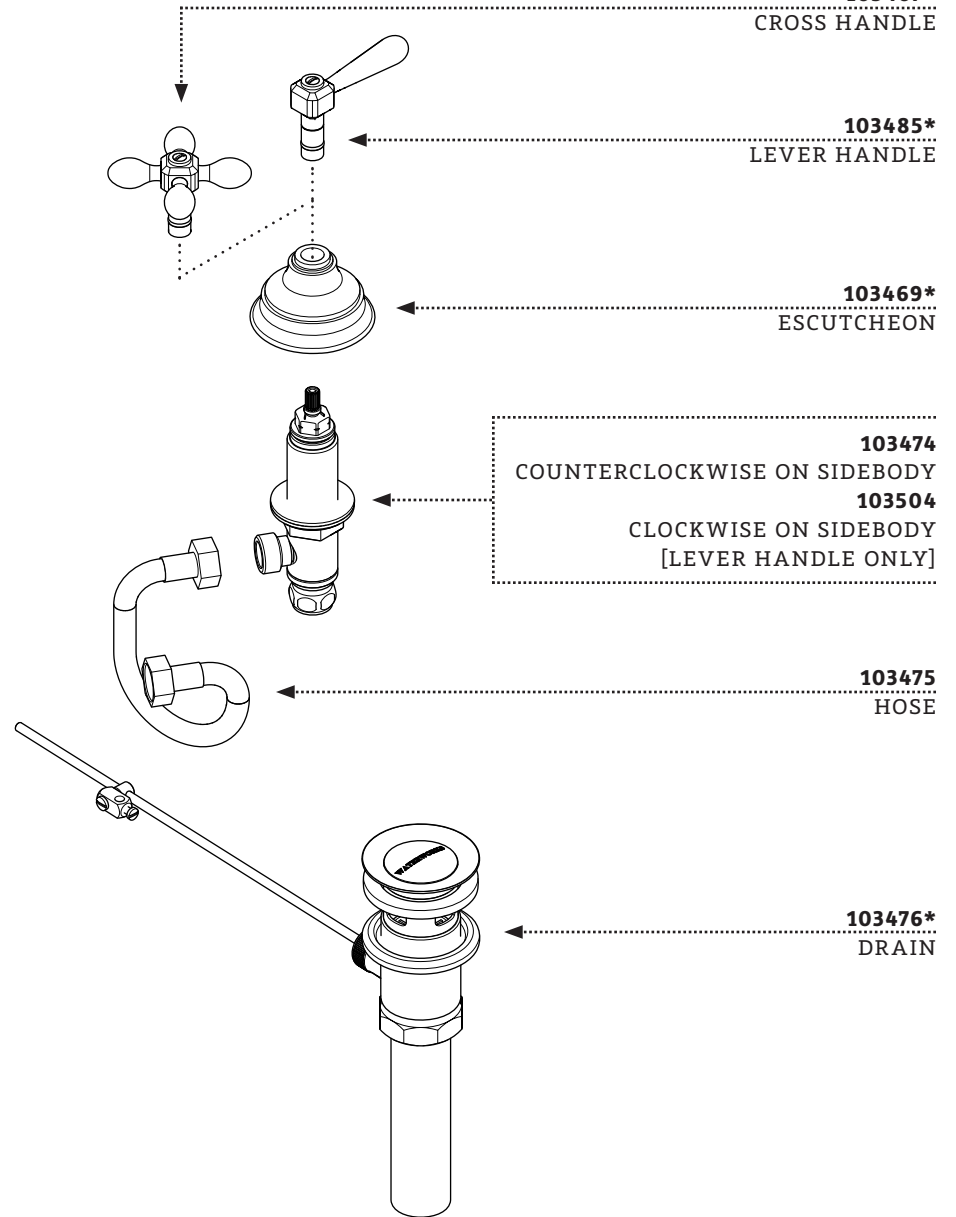



ESTB. 1978

WATERWORKS

### KIT COMPONENTS

STYLES: RTL501, RTL502

103477\*  
LIFT ROD

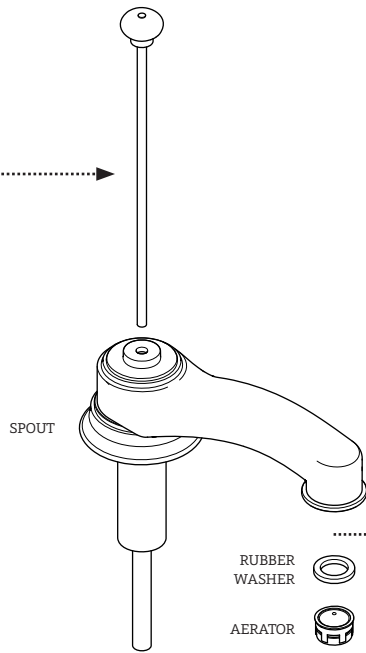

103470\*  
SPOUT

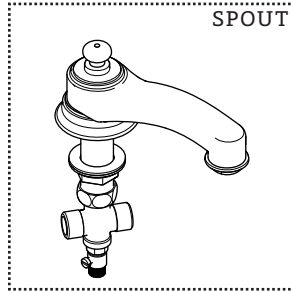

103473\*  
AERATOR

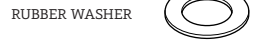
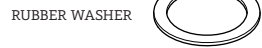

103471  
MOUNTING HARDWARE

103472  
TEE

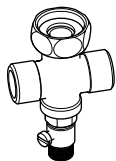

\*FINISH/COLOR MUST BE SPECIFIED WHEN ORDERING  
++SUPPLIED AS A PAIR

### KIT COMPONENTS

103472  
TEE

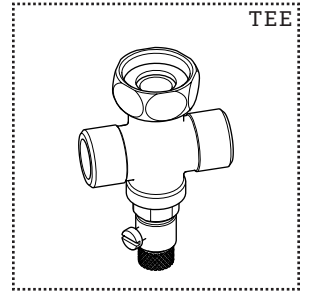

RUBBER WASHER

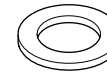

TEE

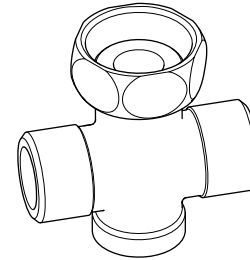

O-RING



METAL WASHER



PACKING NUT



SCREW



CAP



RUBBER WASHER



NUT





ESTB. 1978

WATERWORKS

## KIT COMPONENTS

STYLES: **RTLS01, RTLS02**

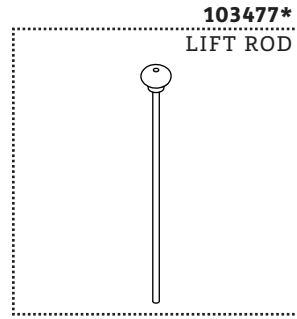
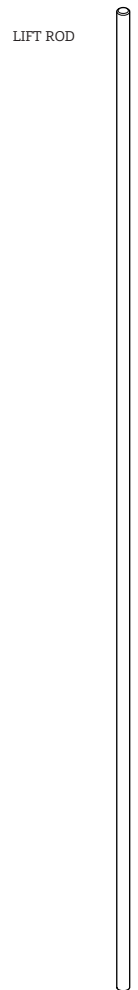

\*FINISH/COLOR MUST BE SPECIFIED WHEN ORDERING  
++SUPPLIED AS A PAIR

## KIT COMPONENTS

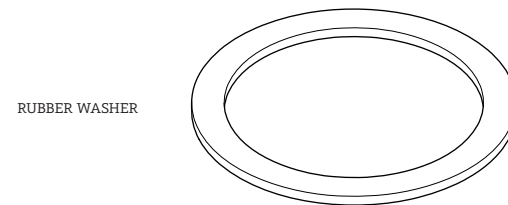
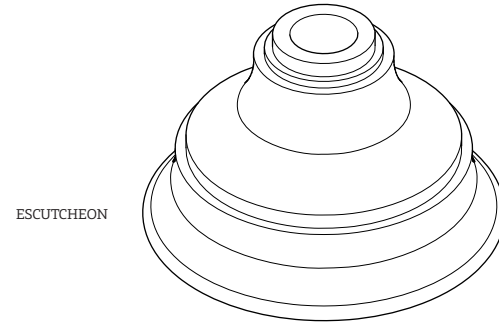
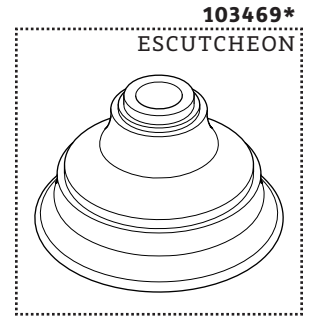



ESTB. 1978

WATERWORKS

### KIT COMPONENTS

STYLES: RTL501, RTL502

103468\*  
HANDLE SCREW

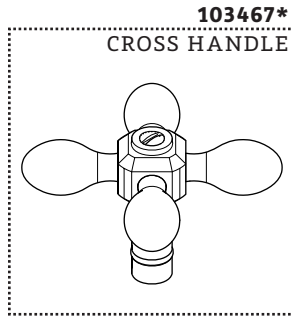
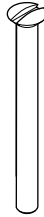

HANDLE

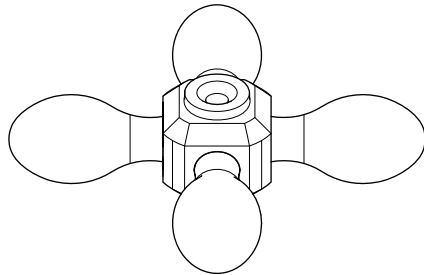

STEM



O-RING



\*FINISH/COLOR MUST BE SPECIFIED WHEN ORDERING  
++SUPPLIED AS A PAIR

### KIT COMPONENTS

103468\*  
HANDLE SCREW

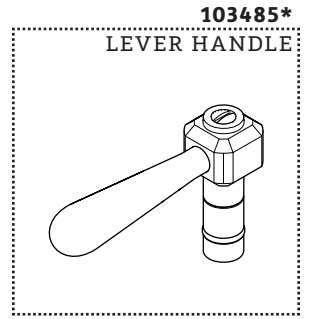
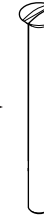

HANDLE

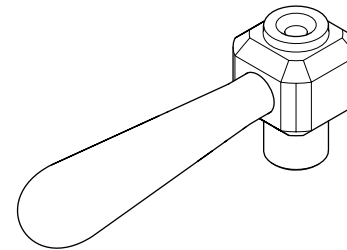

STEM

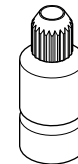

O-RING





ESTB. 1978

WATERWORKS

### KIT COMPONENTS

STYLES: RTLS01, RTLS02

**103471**  
MOUNTING HARDWARE

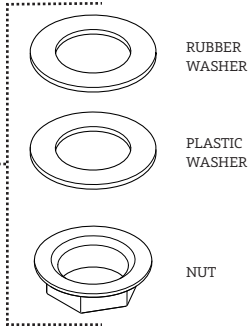

**337847**  
COUNTERCLOCKWISE ON  
CARTRIDGE

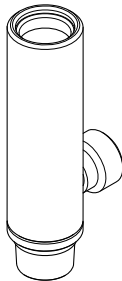

SIDEBODY



RUBBER WASHER



NUT

**103474**  
COUNTERCLOCKWISE  
ON SIDEBODY

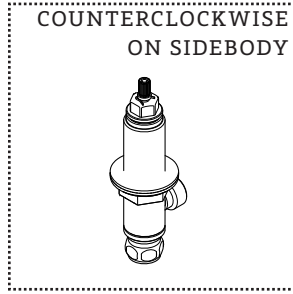

\*FINISH/COLOR MUST BE SPECIFIED WHEN ORDERING  
++SUPPLIED AS A PAIR

### KIT COMPONENTS

**103471**  
MOUNTING HARDWARE

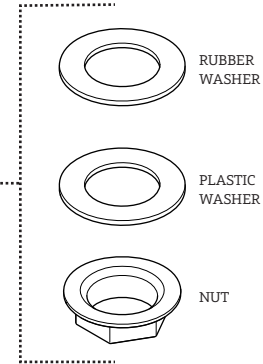

**258790**  
CLOCKWISE ON  
CARTRIDGE

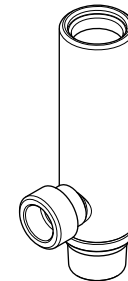
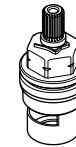

SIDEBODY



RUBBER WASHER



NUT

**103504**  
CLOCKWISE ON  
SIDEBODY

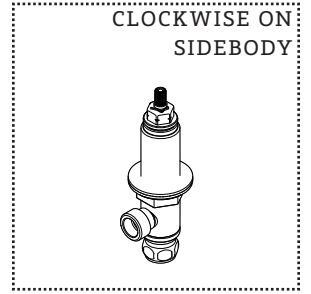



ESTB. 1978

WATERWORKS

### KIT COMPONENTS

STYLES: RTL501, RTL502

064346\*  
DRAIN STOPPER

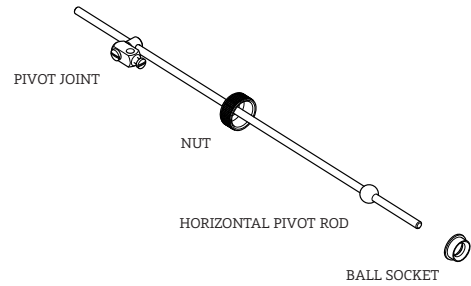

PIVOT JOINT

NUT

HORIZONTAL PIVOT ROD

BALL SOCKET

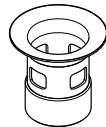
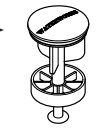

DRAIN FLANGE

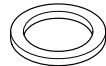

FOAM WASHER



LOWER DRAIN GASKET



LOWER DRAIN BODY



RUBBER WASHER



TAILPIECE



TAILPIECE NUT

103476\*  
DRAIN

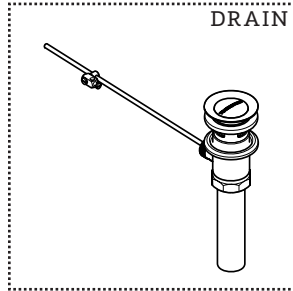

\*FINISH/COLOR MUST BE SPECIFIED WHEN ORDERING  
++SUPPLIED AS A PAIR

### KIT COMPONENTS

064346\*

DRAIN STOPPER

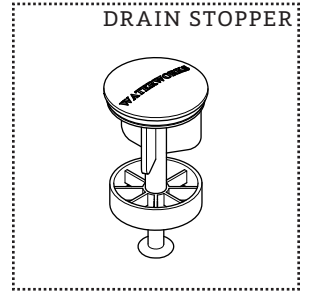

O-RING

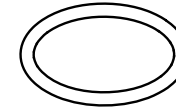

DRAIN STOPPER



DRAIN STRAINER

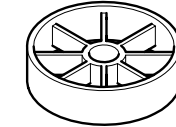

NUT



SCREW

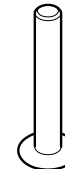





ESTB. 1978

W A T E R W O R K S

## SERVICE PARTS INDEX

<u>STYLE</u>	<u>DESCRIPTION</u>	<u>PG</u>
103473*	AERATOR	4
258790	CLOCKWISE ON CARTRIDGE	11
103504	CLOCKWISE ON SIDEBODY	11
337847	COUNTERCLOCKWISE ON CARTRIDGE	10
103474	COUNTERCLOCKWISE ON SIDEBODY	10
103467*	CROSS HANDLE	8
103476*	DRAIN	12
064346*	DRAIN STOPPER	13
103469*	ESCUTCHEON	7
103468*	HANDLE SCREW	9
103475	HOSE	3
103485*	LEVER HANDLE	9
103477*	LIFT ROD	6
103471	MOUNTING HARDWARE	11
103470*	SPOUT	4
103472	TEE	5

**STYLES: RTLS01, RTLS02**

\*FINISH/COLOR MUST BE SPECIFIED WHEN ORDERING  
++SUPPLIED AS A PAIR

## NOTES

DOCUMENT: SPRT01\_REV01



ESTB. 1978

WATERWORKS

**NOTES**

**STYLES: RTLS01, RTLS02**

\*FINISH/COLOR MUST BE SPECIFIED WHEN ORDERING  
++SUPPLIED AS A PAIR

**NOTES**



ESTB. 1978

WATERWORKS

**PRODUCT SUPPORT**

60 BACKUS AVENUE

DANBURY, CT 06810

1 (800) 927-2120 (EXT 2)

[WWW.WATERWORKS.COM](http://WWW.WATERWORKS.COM)