

## SIGNAL

Signal Mini Flush Mount with Acrylic Shade

SILT05



SHOWN IN SIGNAL MINI FLUSH MOUNT WITH ACRYLIC SHADE| SILT05

### TECHNICAL DETAILS

Ambient / Task: Task  
Bulb Base Size: LED  
Bulb Type: COB  
Depth / Width: 5 5/16"  
Height: 7 3/8"  
Installation Type: Ceiling Mounted  
Interior / Exterior Application: Interior Only  
Junction Box Orientation: Any  
Length: 5 5/16"  
Number of Bulbs: One  
Primary Material: Brass  
Safety Warnings: Surge protector supplied  
Shade Finish: Polished  
Shade Material: Acrylic  
Shade Shape: Cylinder  
Voltage: 120  
Wet / Dry: Damp or Dry

### INSPIRATION

Reminiscent of the maritime warning lights used in lighthouses, Signal lanterns are a contemporary take characterized by clean mechanical lines and simple geometries. In this modern interpretation of the Fresnel lens, faceted jewel-like acrylic rings refract and disperse light at varying angles from a single focus point, reducing glare and producing an elegant even glow.

### CODES & STANDARDS

ETL C/US

### PRODUCT FEATURES

Acrylic rings stacked shade  
Solid brass for metal finishes, Steel for painted finish  
Uses 8 Watt LED (included)  
UL and CUL Listed  
3000K, 80 CRI LED with 30000 hours of life expectancy.

## SIGNAL

Signal Mini Flush Mount with Acrylic Shade

SILT05

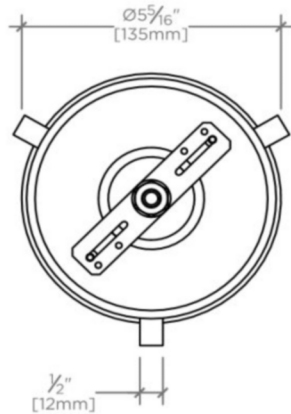

TOP VIEW

SCALE: 3"=1'-0"

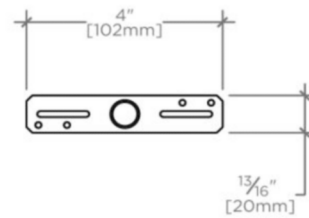

MOUNTING PLATE

SCALE: 3"=1'-0"

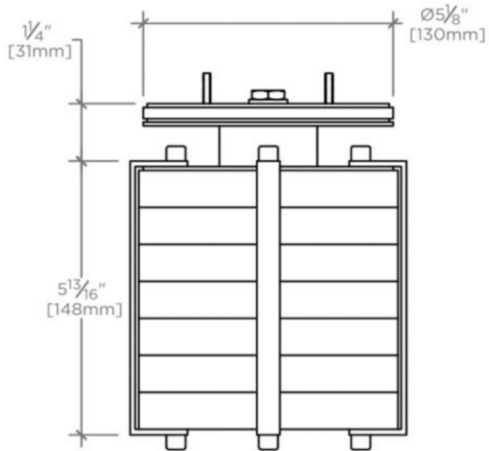

FRONT VIEW

SCALE: 3"=1'-0"

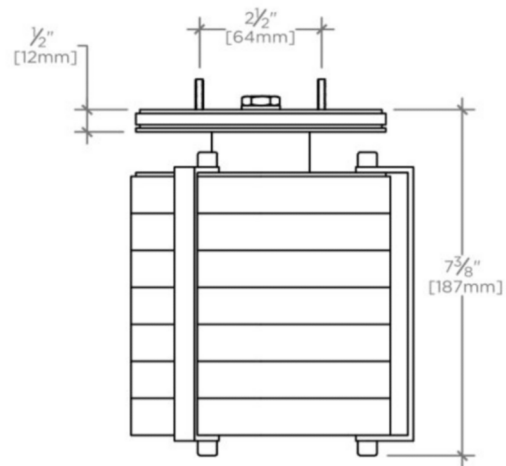

SIDE VIEW

SCALE: 3"=1'-0"