

HNSH20:

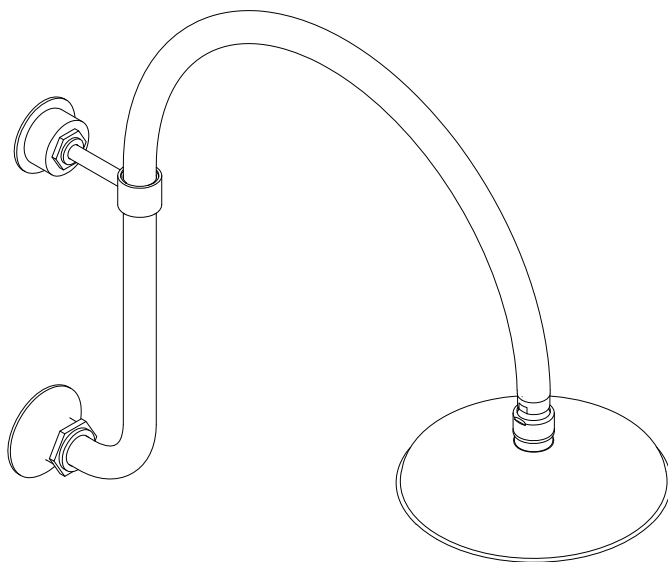

- DO NOT PEX PIPING ON INLET CONNECTION. COPPER PIPE IS REQUIRED.

### **SPECIFICATIONS:**

Inlet Connection Size:  $\frac{1}{2}$ "  
Inlet Connection Type: Copper Compression  
Maximum Water Pressure: 80psi  
Minimum Water Pressure: 20psi  
Fittings Hole Diameter: 1"  
Recommended Water Pressure: 45psi  
Restricted Maximum Flow Rate: 2.5gpm

### **INLET CONNECTION SETUP:**

1. Remove the  $\frac{1}{2}$ " coupling (31) and ferrule (30) from the escutcheon (28) and slide the coupling over the  $\frac{1}{2}$ " copper pipe protruding from the wall.

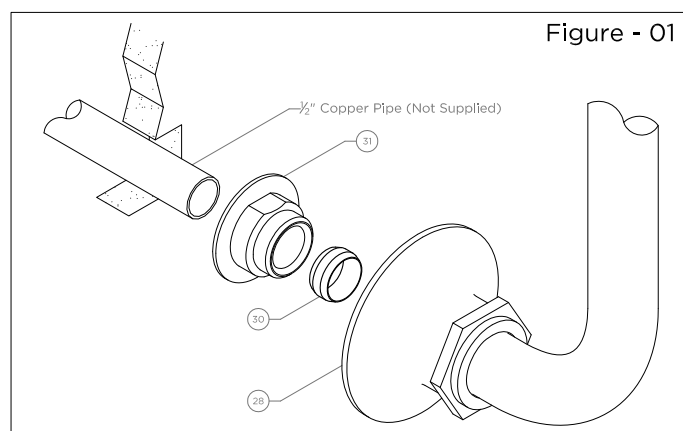

2. Mark the copper pipe  $\frac{1}{2}$ " from the face of the coupling (31). See Figure -02. Remove the coupling and cut the pipe at the  $\frac{1}{2}$ " mark with a pipe cutter.

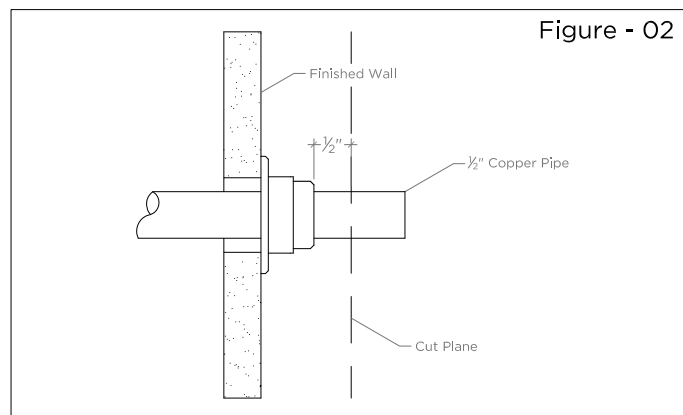

3. Slide the coupling (31) back onto the copper pipe and then the ferrule (30).

### **MOUNTING PLATE INSTALLATION:**

4. From the center of the supply inlet, measure 10  $\frac{1}{2}$ " straight up to mark the location of the wall stay.

### **IMPORTANT:**

- To ensure this product is installed properly, you must read and follow these guidelines.
- The owner/user of this product must keep this information for future reference.
- Be sure your installation conforms to all federal, state, and local codes.
- This product must be installed by a professional licensed contractor.
- Refer to the specification and assembly drawings attached. Product is sold partially assembled but shown fully disassembled for illustrative and service purposes only.
- Inspect this product to ensure you have all parts required for proper installation.
- This product must be on-site prior to rough-in. This allows the installer to visualize the installation.
- Be sure to have adequate blocking in the wall to support the mounting plate.
- In the State of Massachusetts, all installations must comply with the rules and regulations set forth within 248 CMR.

These guidelines have been prepared for the professional contractor to aid in the installation of:  
**HENRY GOOSENECK WALL MOUNTED SHOWER ROSE, ARM AND FLANGE (HNSH20).**  
All dimensions are based on origin specification and are subject to change and variation.  
Please consult your Design Associate for current specifications.

## WATERWORKS

5. Install the mounting plate (22) using the anchor (23) and screw (21) provided.

## **SHOWER ARM INSTALLATION:**

6. Unthread the escutcheon (28) from the knurled and hex collar assembly (24-27). Slide the component up the shower arm and then re-assemble them. See Figure - 03.
7. Slide the gland cover assembly (17-13) down the support post (18) to expose the union nut (19). See Figure - 03.

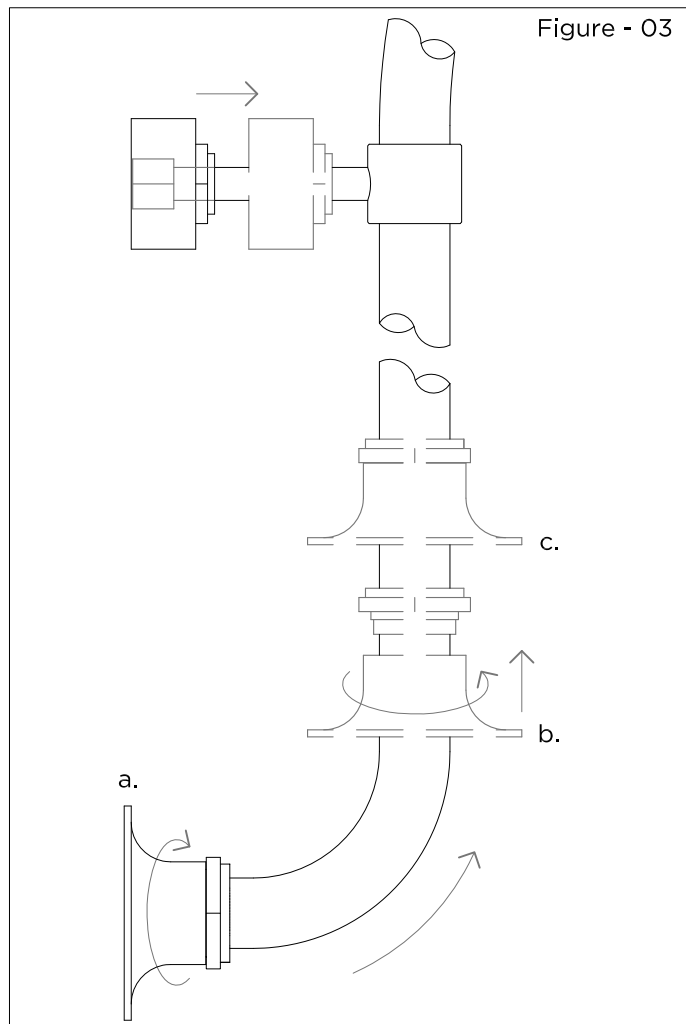

Figure - 03

8. Hold the shower arm (10) up to the copper pipe and securely tighten the union nut on the arm (10) to the coupling (31) making sure the ferrule (30) is in place.
9. Thread the nut (19) to the mounting plate (22). The face of the support post (18) must be flush with the plate (22) to prevent the arm (10) from moving during operation. See Figure - 04. NOTE: The wall stay assembly (11-20) can slide up and down to ensure proper alignment.

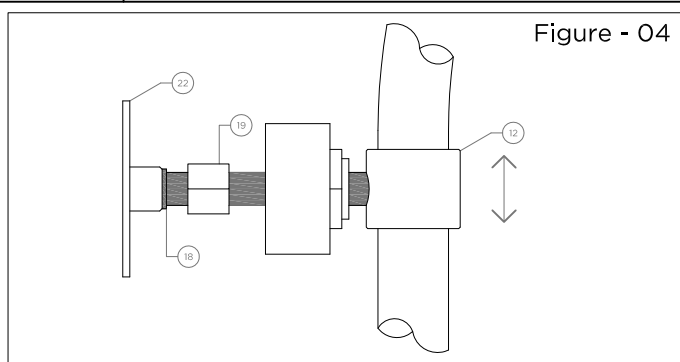

Figure - 04

10. Turn on the water and flush out the system.

## **SHOWERHEAD INSTALLATION:**

11. Thread the shower head (1-8) onto the shower arm (10) making sure the washer (9) is in the inlet of the pivot ball (5). NOTE: A flow restrictor (6) is located in the pivot ball.

## **INSPECT AND FINISH INSTALLATION:**

12. Turn on the water and check for leaks.
  13. Unthread the escutcheon (28) from the knurled and hex collar assembly (24-27) then slide the components back down the arm (10).
  14. Re-attach the escutcheon and collar assembly then thread the escutcheon onto the coupling (31).
- If further assistance is required, please contact Product Support at 1-800-927-2120 Ext. 3 (9am-6pm EST).

These guidelines have been prepared for the professional contractor to aid in the installation of:  
**HENRY GOOSENECK WALL MOUNTED SHOWER ROSE, ARM AND FLANGE (HNSH20).**  
All dimensions are based on origin specification and are subject to change and variation.  
Please consult your Design Associate for current specifications.

**WATERWORKS**

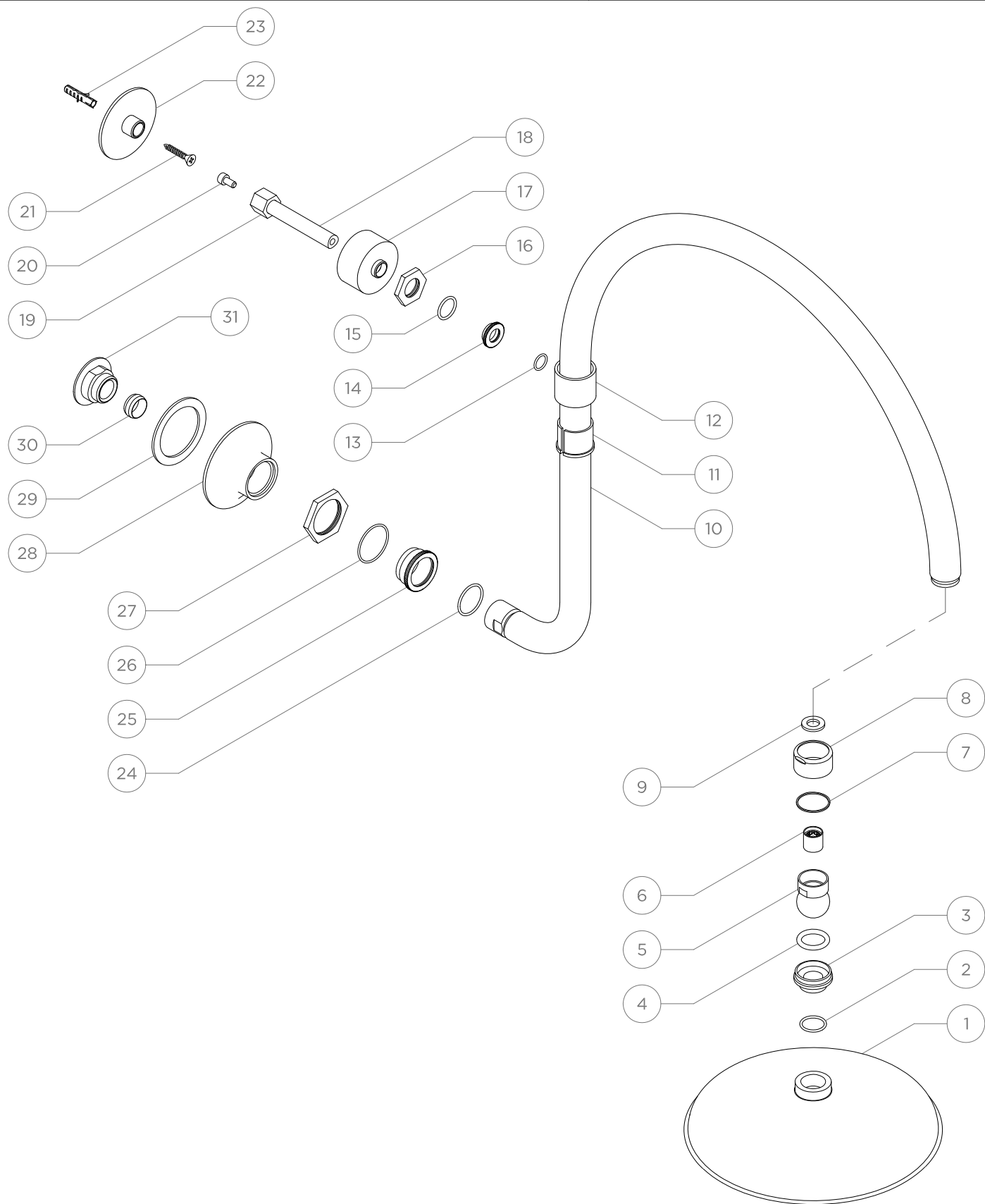

These guidelines have been prepared for the professional contractor to aid in the installation of:  
**HENRY GOOSENECK WALL MOUNTED SHOWER ROSE, ARM AND FLANGE (HNSH20).**  
All dimensions are based on origin specification and are subject to change and variation.  
Please consult your Design Associate for current specifications.

**WATERWORKS**

ITEM NO.	DESCRIPTION	QTY.
1	7 <sup>7</sup> / <sub>8</sub> " Showerhead	1
2	O-Ring, 17mm ID x 2mm Width, Rubber	1
3	Pivot Ball Socket	1
4	O-Ring, 18.3mm ID x 3.6mm Width, Rubber	1
5	Pivot Ball	1
6	Flow Restrictor, 2.5 gpm	1
7	Washer, 24mm ID x 26mm OD x 1mm Thickness, Plastic	1
8	Pivot Ball Retaining Collar	1
9	Washer, 10mm ID x 18mm OD x 2mm Thickness, Rubber	1
10	Shower Arm	1
11	Collar, Wall Stay, Plastic	1
12	Collar, Wall Stay, Metal	1
13	O-Ring, 11mm ID x 1.5mm Width, Rubber	1
14	1 <sup>3</sup> / <sub>16</sub> " Knurled Collar	1
15	O-Ring, 16mm ID x 1.9mm Width, Rubber	1
16	1 <sup>1</sup> / <sub>16</sub> " Hex Collar	1
17	Gland Cover, Wall Stay	1
18	Support Post	1
19	Union Nut, 17mm Hex	1
20	Screw, 4mm Hex key, 10mm Length	1
21	Wood Screw, Phillips Head, #9, 1 1/4" Length	1
22	Mounting Plate, Wall Stay, Henry	1
23	Anchor, 30mm Length, Plastic	1
24	O-Ring, 23.5mm ID x 1.8mm Width, Rubber	1
25	1 <sup>5</sup> / <sub>16</sub> " Knurled Collar	1
26	O-Ring, 30mm ID x 1.5mm Width, Rubber	1
27	1 <sup>1</sup> / <sub>2</sub> " Hex Collar	1
28	Escutcheon	1
29	Washer, 43.2mm ID x 57mm OD x 2mm Thickness, Rubber	1
30	Ferrule	1
31	1/2" Copper Pipe Coupling	1

These guidelines have been prepared for the professional contractor to aid in the installation of:  
**HENRY GOOSENECK WALL MOUNTED SHOWER ROSE, ARM AND FLANGE (HNSH20).**  
 All dimensions are based on origin specification and are subject to change and variation.  
 Please consult your Design Associate for current specifications.

**WATERWORKS**



ESTB. 1978

# WATERWORKS

## SERVICE PARTS

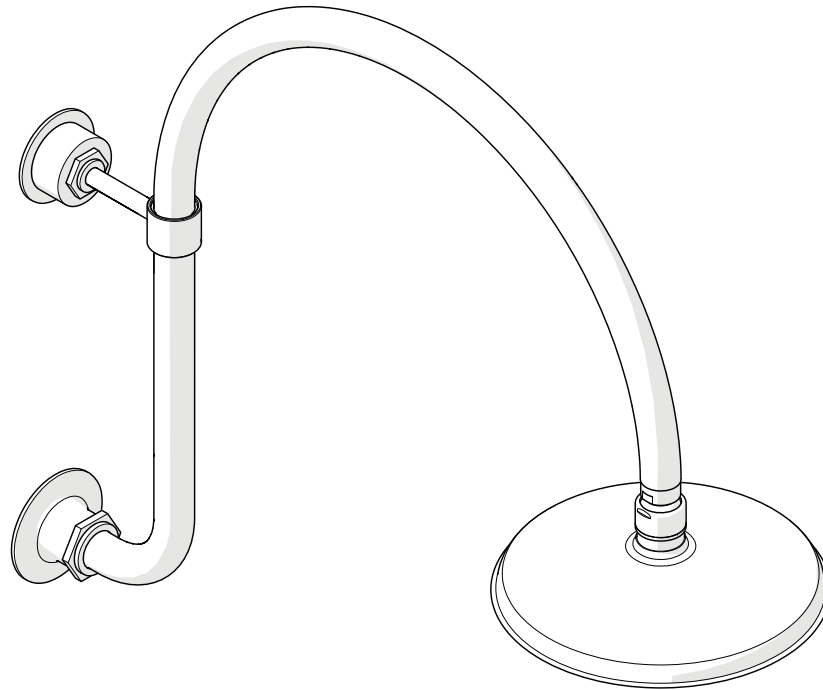

### **STYLE HNSH20**

Henry Gooseneck Wall Mounted Shower Rose, Arm and Flange

---

WELCOME TO

# WATERWORKS

For over three decades, Waterworks has transformed the bath through an absolute commitment to design authenticity, innovation and quality. A blend of scholarly appreciation and applied experience guarantees mechanical integrity, meticulous craftsmanship, and timeless designs.

---

**TO ORDER PARTS CALL  
1 (800) 927-2120 (EXT 2)**

Order by part number and specify color, finish, or other options if required.

**PRODUCT SUPPORT**

Our Product Support team provides troubleshooting and technical problem resolution, including replacement parts and installation recommendations throughout the life of your product.

Product Support is available Monday through Friday, 8AM-6PM EST.

**LIMITED LIFETIME  
WARRANTY**

Our warranty covers repair and replacement of Waterworks products if within the applicable coverage period and deemed defective by Waterworks. Waterworks will, at its option, repair or replace such products; this does not include installation costs, labor charges, or other incidental or consequential costs.

To obtain your complete warranty or inquire about warranty service, please visit us at [www.waterworks.com](http://www.waterworks.com) or contact our Product Support Team.



ESTB. 1978

WATERWORKS

## MAIN KITS

**103754\***  
SHOWER ARM  
FASTENING KIT

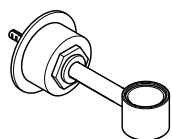

**103753\***  
ARM AND FLANGE

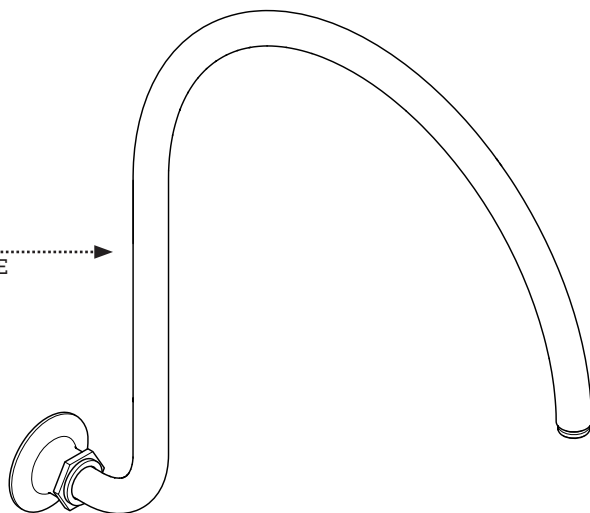

**103752\***  
SHOWERHEAD

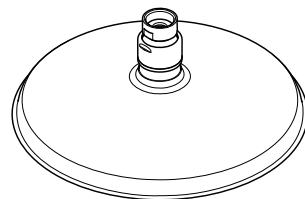

STYLES: HNSH20

\*FINISH/COLOR MUST BE SPECIFIED WHEN ORDERING  
++SUPPLIED AS A PAIR

## KIT COMPONENTS

RETAINING COLLAR



PLASTIC WASHER



RUBBER WASHER



FLOW REGULATOR



PIVOT BALL



O-RING



**103752\***  
SHOWERHEAD

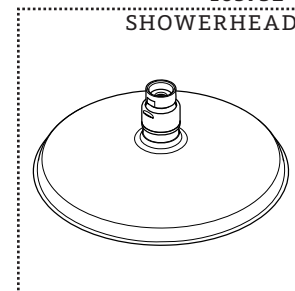

SHOWERHEAD

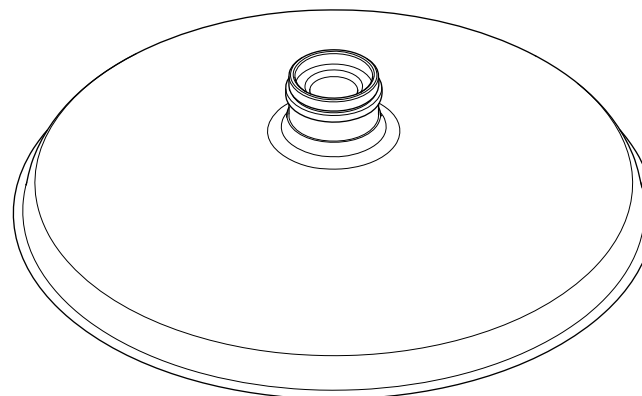



ESTB. 1978

WATERWORKS

## KIT COMPONENTS

STYLES: HNSH20

103753\*

ARM AND FLANGE

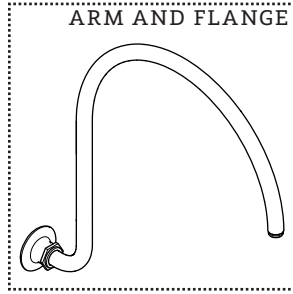

103755

UNION SEAL



RUBBER WASHER



ESCUTCHEON



O-RING



SHOWER ARM

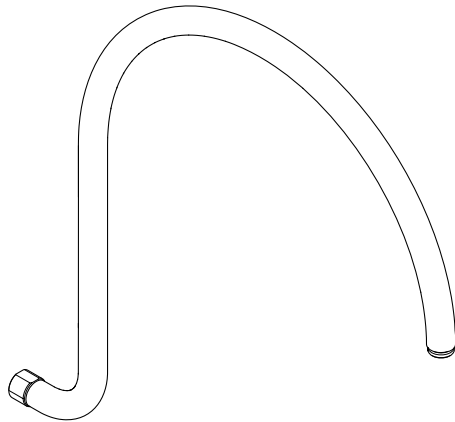

\*FINISH/COLOR MUST BE SPECIFIED WHEN ORDERING

++SUPPLIED AS A PAIR

## KIT COMPONENTS

103755

UNION SEAL

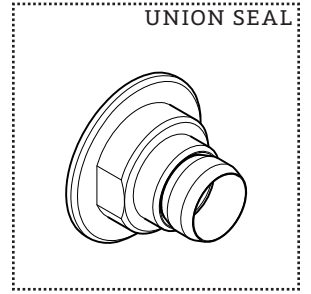

COUPLER

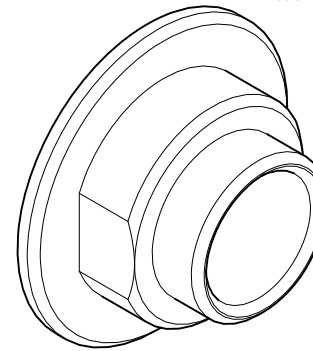

COMPRESSION RING

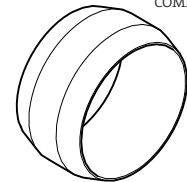





ESTB. 1978

WATERWORKS

## KIT COMPONENTS

STYLES: HNSH20

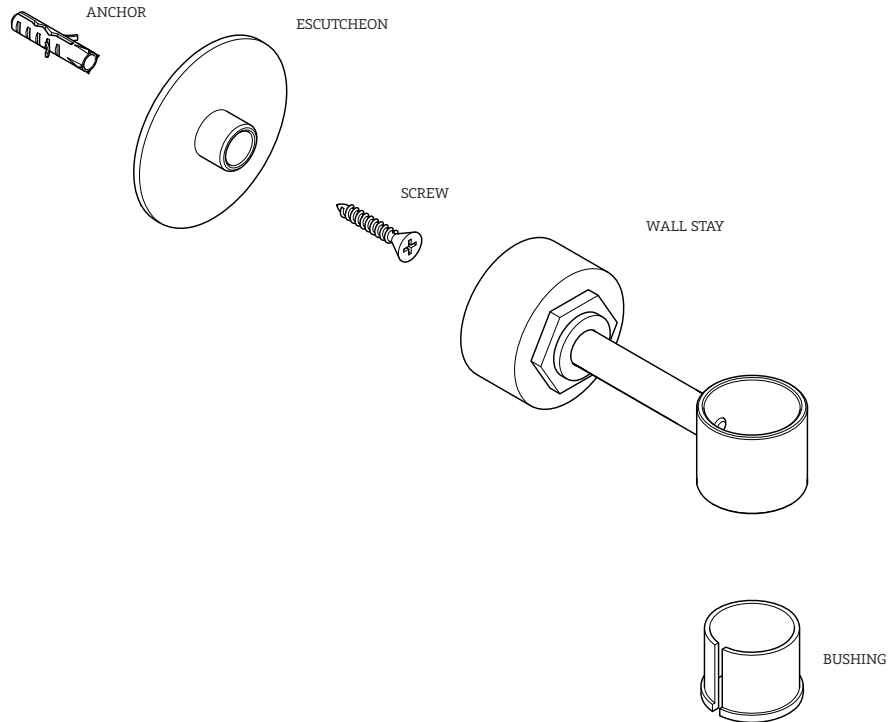
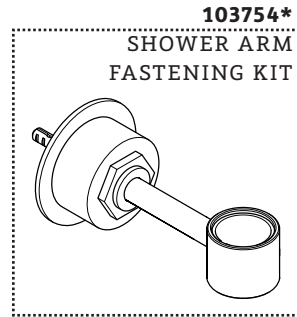

\*FINISH/COLOR MUST BE SPECIFIED WHEN ORDERING  
++SUPPLIED AS A PAIR

## SERVICE PARTS INDEX

<u>STYLE</u>	<u>DESCRIPTION</u>	<u>PG</u>
103753*	ARM AND FLANGE	4
103754*	SHOWER ARM FASTENING KIT	6
103752*	SHOWERHEAD	3
103755	UNION SEAL	5



ESTB. 1978

W A T E R W O R K S

## NOTES

**STYLES: HNSH20**

\*FINISH/COLOR MUST BE SPECIFIED WHEN ORDERING

++SUPPLIED AS A PAIR

## NOTES



ESTB. 1978

W A T E R W O R K S

**PRODUCT SUPPORT**

60 BACKUS AVENUE

DANBURY, CT 06810

1 (800) 927-2120 (EXT 2)

WWW.WATERWORKS.COM