

WATERWORKS

Waterworks Steam Head

WW44SU

TECHNICAL DETAILS

Adjustable versus Fixed Spray: Fixed Spray
Escutcheon Primary Material: Brass
Fittings Hole Diameter: 35 mm
Depth / Width: 35 mm
Height: 71 mm
Inlet Connection Size: 1/2"
Inlet Connection Type: Male G/BSPP
Length: 73 mm
Pivot: Y
Suggested Application: Bath



SHOWN IN WATERWORKS STEAM HEAD| WWSU44

INSPIRATION

Our Waterworks collection encompasses a classic product range. From accessories to furniture, each authentic design is created with mechanical integrity and meticulous craftsmanship.

PRODUCT FEATURES

Our steam units bring the relaxation and comfort of a spa to your own personal bathroom experience.

Our steam head is constructed of solid brass

ADAPTER(S) PACKAGED SEPARATELY		
ADAPTER	DESCRIPTION	QTY
UNUK06	3/4" NPT Male x 3/4" Male Nipple 50mm Long BSP	1



TOP VIEW SCALE: 3"=1'-0"

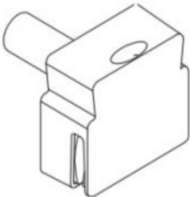

ISO VIEW SCALE: 3"=1'-0"

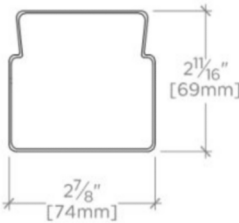

FRONT VIEW SCALE: 3"=1'-0"

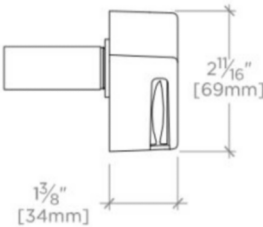

SIDE VIEW SCALE: 3"=1'-0"